

131086

97-06 JEEP TJ LIGHT BAR KIT

**OFF CAMBER
FABRICATIONS**

by: **MBRP** INC.

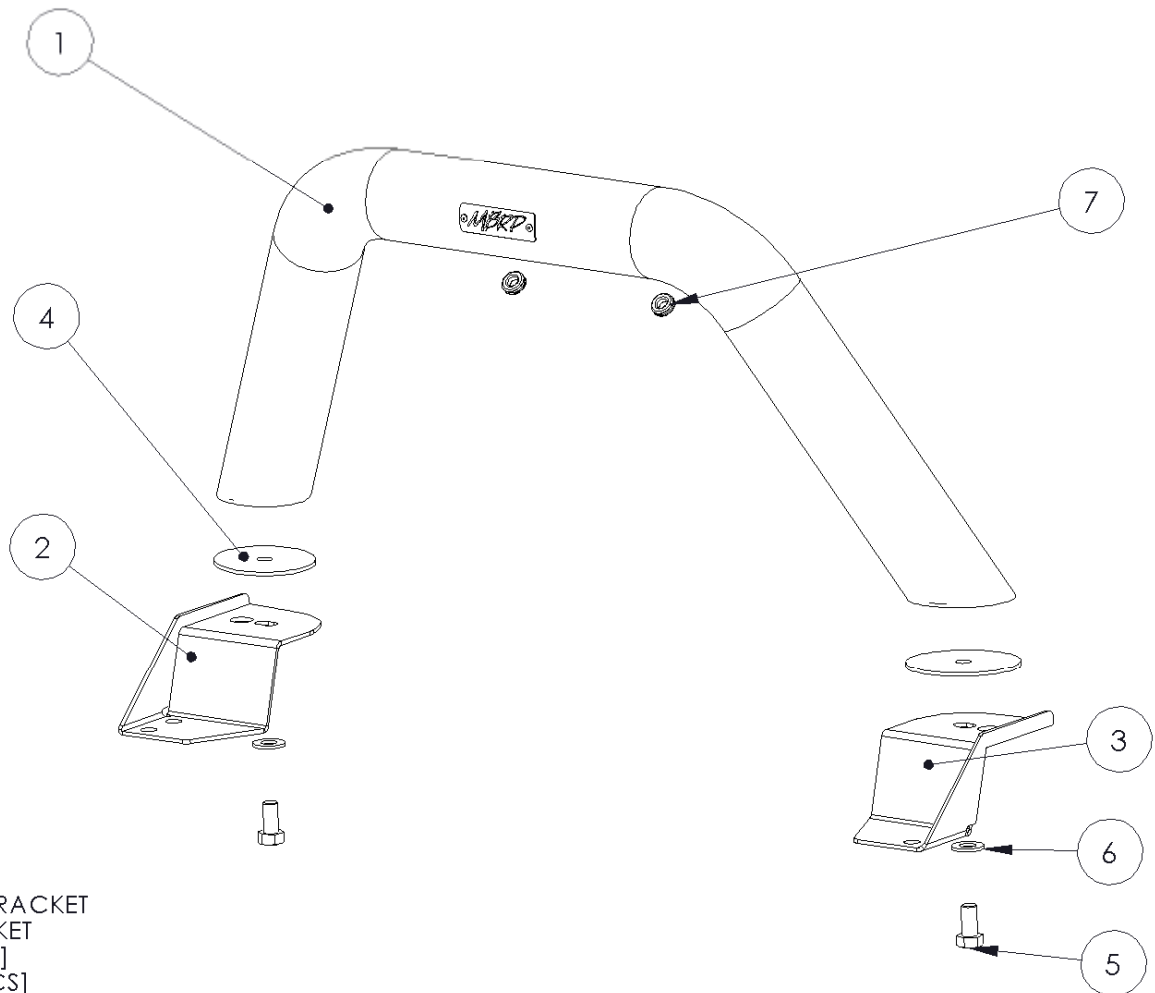

1. LIGHT BAR
2. PASSENGER BRACKET
3. DRIVER BRACKET
4. GASKET [2PCS]
5. 1/2" BOLT [2PCS]
6. 1/2" WASHER [2PCS]
7. GROMMET [2PCS]

PLEASE READ BEFORE STARTING INSTALLATION

While MBRP Inc. has made every effort to ensure that all components of this kit are of superior quality and properly packaged, it is the installer's responsibility to ensure the following before starting:

- that ALL components shown above are present.
- that ALL mating components fit together.
- that there are no damaged components.
- that the kit you have purchased is appropriate for your year and model of vehicle.
- that the kit will not interfere with any modifications previously installed or planned.
- that you have read and understand these instructions.

If you have any questions or are uncertain about any aspect of the installation of this kit on your vehicle please contact your dealer before commencing installation.

1997-2006 Jeep TJ Light Bar Kit



Figure 1



Figure 2



Figure 3



Figure 4



Figure 5

1. Remove the fasteners holding the factory tow hooks to the bumper using a T55 Torx bit. These bolts may be seized tight. Applying penetrating oil a few times over a day or two in advance may be required. Do not discard these bolts, they will be reused. **Refer to Figure 1.**

2. Preassemble the complete **Light Bar Assembly** on the floor as shown in the above picture. Ensure the **Driver Bracket**, and **Passenger Bracket** are in the proper location. Install the **Grommets**. Leave all hardware loose as some alignment/adjusting will be required later. If you plan to run lights, now is the time to run the wiring through the bar.

Refer to Figures 2 and 3.

3. Position the assembly on the bumper of the Jeep and reinstall the OEM tow hooks on top of the **Driver** and **Passenger Brackets** with the previously removed hardware. Be sure to place the hooks back in their original place. There is a LH and RH hook. Tighten the OEM tow hook fasteners. This will secure the **Driver** and **Passenger Brackets**.

Refer to Figures 4 and 5.

**OFF CAMBER
FABRICATIONS**
by: *MBRP* Inc.



Figure 6

4. Align the **Gaskets** with the end of the tube. Once aligned, tighten the ½” **Bolts** to lock the **Light Bar** to the **Driver** and **Passenger Brackets**. Refer to **Figure 6**.



Congratulations! You are finished. We are sure that you will enjoy this
Off Camber Fabrications
product by *MBRP Inc.*