

182736

07-15 JK HOOD LIGHT KIT

**OFF CAMBER  
FABRICATIONS**

by: **MBRP** INC.

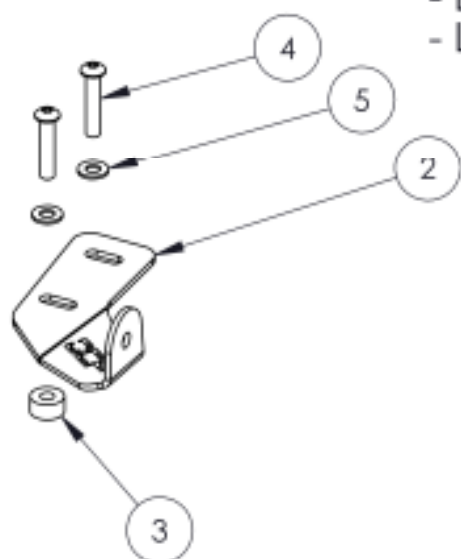

- DESIGNED FOR USE WITH STUD MOUNT LIGHTS
- LIGHT MOUNTING WIDTH BETWEEN 19.5"-21.5"

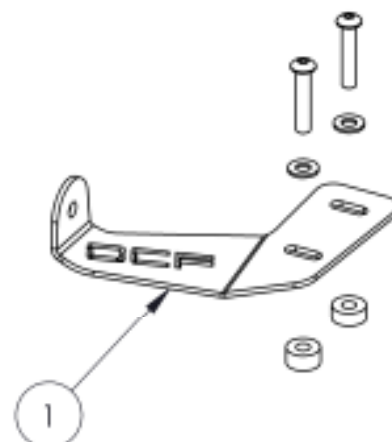

1. DRIVER SIDE BRACKET
2. PASSENGER SIDE BRACKET
3. SPACER [4 PCS]
4. M8x40 BOLT [4 PCS]
5. M8 WASHER [4 PCS]

### PLEASE READ BEFORE STARTING INSTALLATION

While MBRP Inc. has made every effort to ensure that all components of this kit are of superior quality and properly packaged, it is the installer's responsibility to ensure the following before starting:

- that ALL components shown above are present.
- that ALL mating components fit together.
- that there are no damaged components.
- that the kit you have purchased is appropriate for your year and model of vehicle.
- that the kit will not interfere with any modifications previously installed or planned.
- that you have read and understand these instructions.

If you have any questions or are uncertain about any aspect of the installation of this kit on your vehicle please contact your dealer before commencing installation.



**Figure 1**



**Figure 2**



**Figure 3**



**Figure 4**

### Installation of OCF Hood Light Kit

1. Remove both Passenger side hood hinge bolts using a T40 torx bit. **Refer to Figure 1.**
2. Place a **Spacer** over each of the mounting holes on the hinge, then place the **Passenger Side Bracket** on top of the **Spacers** and secure using the supplied **Washers**, and **M8x40 Bolts**. Tighten the bolts just enough to allow for adjustment. **Refer to Figure 2.**
3. Repeat steps 1 and 2 to install the **Driver Side Bracket**.
4. With both brackets loosely installed, Install your light bar in the brackets and loosely secure with the supplied fasteners from the light bar. **Refer to Figure 3.**
5. With all the fasteners loose, center and adjust the position of the light bar and brackets. Once the position has been set, first tighten the four **M8x40 Bolts** followed by the light bar fasteners. **Refer to Figure 4 and 5.**



**Figure 5**



**Figure 6**

**OFF CAMBER  
FABRICATIONS**  
by: *MBRP* Inc.

6. Verify Hood alignment has not changed and hood latches still function properly. Readjust hood hinge position if necessary.
7. Wiring can be routed down the **Driver Side Bracket** and behind the hinge for easy access to the under hood fuse panel. Refer to **Figure 6**.



Congratulations! You're finished! We are sure that you will enjoy this **Off Camber Fabrications** product by *MBRP Inc.*