

183226

SKID PLATE

2016 AND UP TOYOTA TACOMA

**OFF CAMBER
FABRICATIONS**

by: **MBRP** INC.

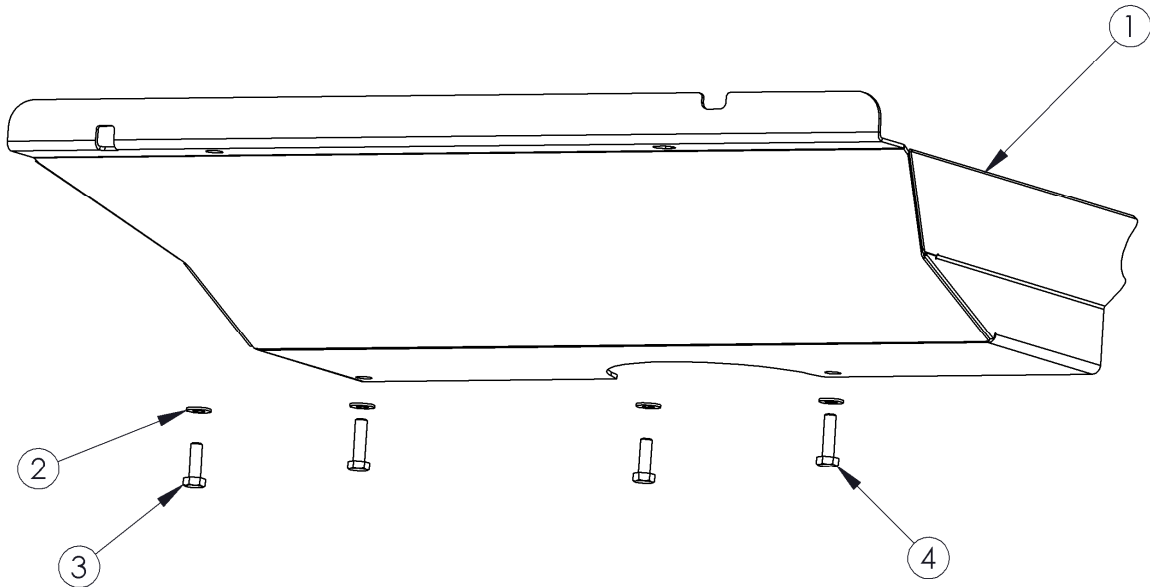

1. SKID PLATE
2. M8 FLAT WASHER [4 PCS]
3. M8 HEX BOLT (25mm) [2 PCS]
4. M8 HEX BOLT (30mm) [2 PCS]

PLEASE READ BEFORE STARTING INSTALLATION

While MBRP Inc. has made every effort to ensure that all components of this kit are of superior quality and properly packaged, it is the installer's responsibility to ensure the following before starting:

- that ALL components shown above are present.
- that ALL mating components fit together.
- that there are no damaged components.
- that the kit you have purchased is appropriate for your year and model of vehicle.
- that the kit will not interfere with any modifications previously installed or planned.
- that you have read and understand these instructions.

If you have any questions or are uncertain about any aspect of the installation of this kit on your vehicle please contact your dealer before commencing installation.

2016 And Up Toyota Tacoma Skid Plate



Figure 1

1. Remove the 4 fasteners securing the stock skid plate. Unhook the stock skid plate from the frame and lower the skid plate off of the vehicle.

Refer to Figure 1.



Figure 2

2. Raise the OCF **skid plate** up to the frame and hook the front of the skid plate onto the frame. **Refer to Figure 2.**

3. Hold your OCF **skid plate** in position and loosely screw in the four (4) supplied **Hex Bolts** and **Flat Washers** into the appropriate bolt holes (using the longer bolts in the rear locations). **Refer to Figure 3.**

4. Tighten down all 4 **Hex Bolts** securing your OCF **skid plate** to your vehicle. **Refer to Figure 4.**

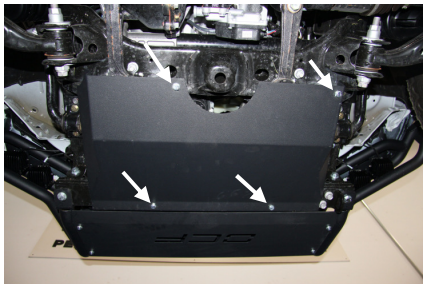

Figure 3

Congratulations! You're finished! We are sure that you will enjoy this **Off Camber Fabrications** product by **MBRP Inc.**



Figure 4