

C1329AL / C1329ALNB
6.7L DODGE CUMMINS 2007.5-2010
4" EXHAUST PIPE ASSEMBLY

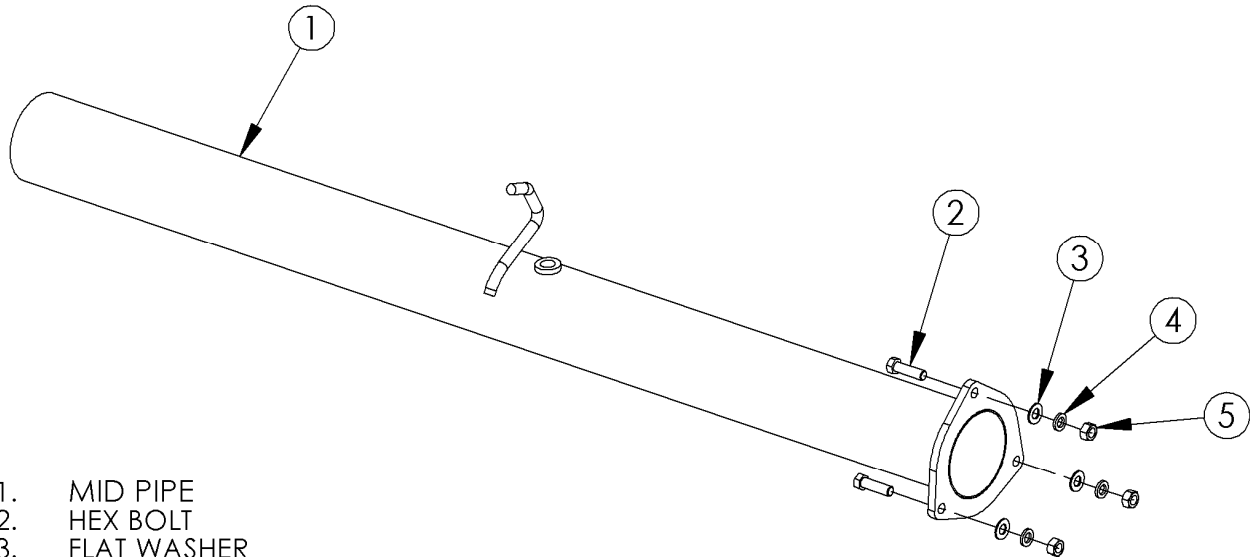

1. MID PIPE
2. HEX BOLT
3. FLAT WASHER
4. LOCK WASHER
5. HEX NUT

FOR RACE/COMPETITION USE ONLY!

Installation of this product for highway or recreational use vehicles is prohibited by Federal law. This product's use is restricted to organized, amateur and professional racing events, limited to closed-course racing and open-course racing that is formally sanctioned by a recognized racing organization.

This system requires an aftermarket electronic programmer to work with the vehicle.

PLEASE READ BEFORE STARTING INSTALLATION

While MBRP Inc. has made every effort to ensure that all components of this system are of superior quality and properly packaged it is the installer's responsibility to ensure the following before removal of the factory exhaust:

- that ALL components shown above are present.
- that ALL mating components fit together.
- that there are no damaged components.
- that the system you have purchased is appropriate for your vehicle year, model and configuration.
- that the system will not interfere with any modifications previously installed or planned.
- that you have read and understand these instructions.

If you have any questions or are uncertain about any aspect of the installation of this system to your vehicle please contact your dealer before commencing installation.



Removal of Stock System:

1. Apply penetrating lubricant liberally to all exhaust fasteners, hangers and rubber insulators.
2. Disconnect any exhaust sensors on the diesel particulate filter and catalytic converter section of the exhaust.
3. Loosen the clamp and separate the slip joint located behind the diesel particulate filter.
4. Remove the catalytic converter and diesel particulate filter by disconnecting the flange attached to the down pipe.

Installation of MBRP Inc. Competition Pipe:

1. Insert the **Mid Pipe** hanger into the rubber isolator and install the flange to the down pipe flange using the **Hardware** provided.
3. Re-install the tail pipe onto the end of the **Mid Pipe** using the original band clamp.
4. Align the exhaust as needed and tighten all connections.
5. For the C1329AL system, re-install the O2 sensor in the provided port.

Congratulations! MBRP Competition Exhaust Systems is proud to be a part of your racing and competition success. We know you will enjoy your purchase.