

**FS9455**

**08-10 6.4L POWERSTROKE DOWNPIPE KIT**

**MBRP**  
INC.

**PERFORMANCE EXHAUST**

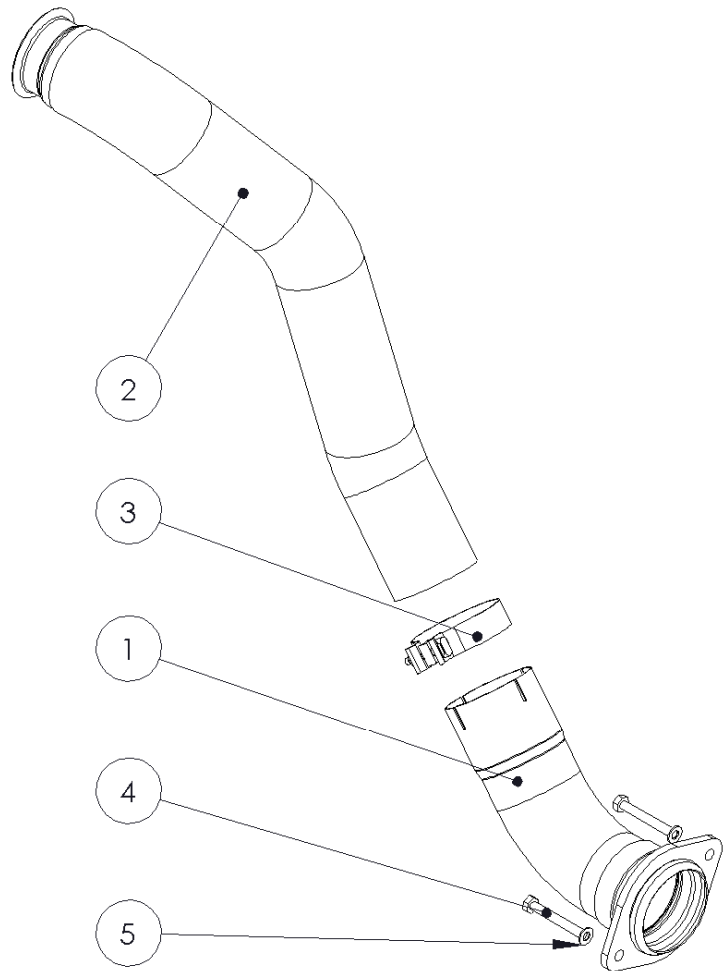

1. LOWER PIPE
2. UPPER PIPE
3. CLAMP
4. M10 HEX BOLT [2 PCS]
5. M10 WASHER [2 PCS]

### **PLEASE READ BEFORE STARTING INSTALLATION**

**While MBRP Inc. has made every effort to ensure that all components of this system are of superior quality and properly packaged it is the installer's responsibility to ensure the following before removal of the factory exhaust:**

- that ALL components shown above are present.
- that ALL mating components fit together.
- that there are no damaged components.
- that the system you have purchased is appropriate for your vehicle year, model and configuration.
- that the system will not interfere with any modifications previously installed or planned.
- that you have read and understand these instructions.

If you have any questions or are uncertain about any aspect of the installation of this system to your vehicle please contact your dealer before commencing installation.

## Removal of OEM Down pipe



**Figure 1**

1. Start by removing the OEM heat shield from the turbo by removing the five 8mm head bolts. This shield cannot be fully removed but sliding it out of the way will allow access to the V band Clamp at the turbo outlet.

See Figure 1.



**Figure 2**

2. Loosen the OEM V band Clamp at the turbo outlet. Once loose, the clamp bolt can be released from the clamp. There is a retaining tab located at the 12 o'clock position on the OEM down pipe that must be pried off the turbo flange to allow the pipe assembly to be removed.

See Figure 2.



**Figure 3**

3. Remove the 2 OEM bolt from the ball flange at the outlet of the OEM down pipe. Keep these bolts, they will be reused. Use a prybar to shift the exhaust system rearward to allow the OEM down pipe to drop down a few inches.

4. The OEM down pipe must be cut in order to remove it. Use a sawsall with a long enough blade to cut through the pipe. Note the location of the cut.

See Figures 3, and 4.



**Figure 4**



**Figure 5**

5. Remove the lower section of the OEM down pipe. The upper section of the down pipe can now be removed by working the down pipe down while rotating it clockwise approx 90 degrees as viewed from below. This will take some work, it is a very tight fit.

See Figures 5, and 6.



**Figure 6**

### **Installation of MBRP Downpipe Kit**

1. Install the Upper Pipe in the reverse order of removing the upper section of the OEM pipe. Again, it is a tight fit, but it will fit. Once the Upper Pipe is in position, loosely install the OEM V band Clamp.

See Figure 7.



**Figure 7**

2. Install the Lower Pipe by first sliding the supplied Clamp over the pipe then sliding it onto the Upper Pipe. Do not tighten yet.



**Figure 8**

3. Using the Supplied M10 Hex Bolts, loosely secure the 2 bolt down pipe flange to the OEM flange.

See Figure 8.

4. Ensure that there is enough clearance between the MBRP Downpipe Assembly and the firewall, trans cooler lines, and frame. Adjust if necessary. Once clearances have been checked, tighten all clamps and flanges.

5. Reinstall the OEM turbo heat shield with the previously removed hardware.

**Congratulations!** You are ready to begin experiencing the improved power, sound and driving excitement of your MBRP Inc. performance exhaust system. We know you will enjoy your purchase.