

IC2200

3" INTERCOOLER OUTLET PIPE
2013-2014 6.7L DODGE CUMMINS

MBRP
INC.
PERFORMANCE EXHAUST

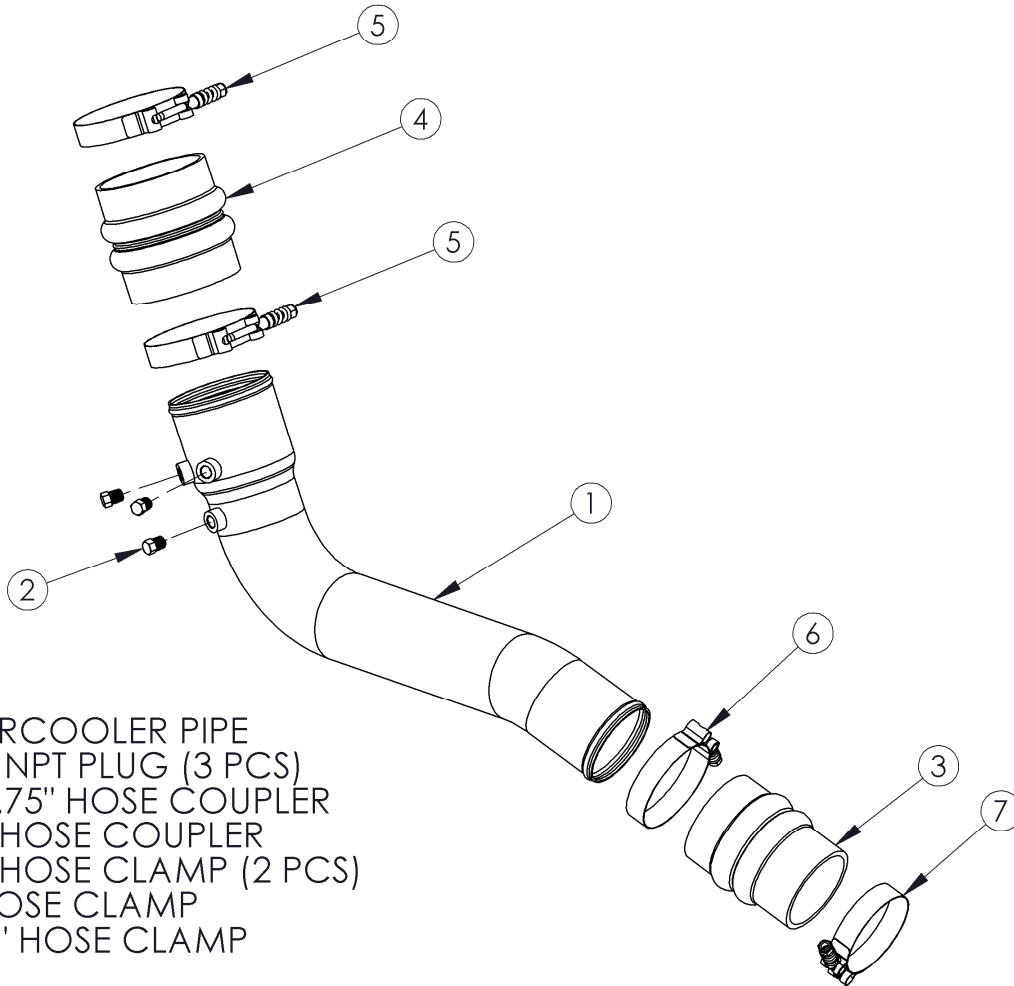

1. INTERCOOLER PIPE
2. 1/8" NPT PLUG (3 PCS)
3. 3"/2.75" HOSE COUPLER
4. 3.5" HOSE COUPLER
5. 3.5" HOSE CLAMP (2 PCS)
6. 3" HOSE CLAMP
7. 2.75" HOSE CLAMP

PLEASE READ BEFORE STARTING INSTALLATION

While MBRP Inc. has made every effort to ensure that all components of this product are of superior quality and properly packaged it is the installer's responsibility to ensure the following before removal of the factory components:

- that ALL components shown above are present.
- that ALL mating components fit together.
- that there are no damaged components.
- that the product you have purchased is appropriate for your vehicle year, model and configuration.
- that the product will not interfere with any modifications previously installed or planned.
- that you have read and understand these instructions.

If you have any questions or are uncertain about any aspect of the installation of this product to your vehicle please contact your dealer before commencing installation.

Removal of Stock Pipe:



Figure 1

1. Remove the driver-side wheel liner to access the lower part of the intercooler pipe. **Refer to Figure 1.** Retain all fasteners.
2. Using an 11mm deep socket, loosen the clamps securing the hose connections to the intercooler outlet and the engine intake. **Refer to Figure 2 and Figure 3.**
3. Remove the stock intercooler pipe.

Installation of MBRP Inc. Intercooler Pipe:

NOTE: PLEASE ENSURE THAT THE INSIDE OF THE INTERCOOLER PIPE IS CLEAN BEFORE INSTALLATION.

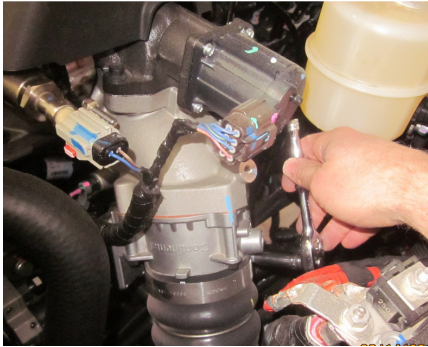

Figure 2

1. Install the **3"/2.75" Hose Coupler** onto the bottom (long) end of the new **Intercooler Pipe** and secure it using a **3" Hose Clamp**. Tighten clamp to 75 in-lbs.

2. Place the **2.75" Hose Clamp** around the intercooler outlet and install the new pipe by fitting the bottom coupler over the intercooler outlet and under the clamp. Do not fully tighten the clamp yet.

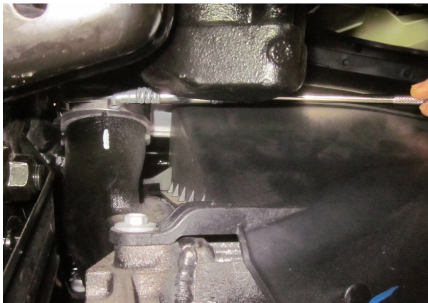

Figure 3

3. Place a **3.5" Hose Clamp** around the upper end of the **Intercooler Pipe** and install the **3.5" Hose Coupler** by sliding it over the pipe and under the hose clamp. Do not fully tighten the clamp yet.

4. Place the remaining **3.5" Hose Clamp** loosely over the engine intake and install the **3.5" Hose Coupler** (attached to the **Intercooler Pipe**) onto the engine intake. Slide the clamp into place over the hose coupler. **Refer to Figure 4.**



Figure 4

5. Position the **Intercooler Pipe** to maximize clearances, and then tighten all clamps to 75 in-lbs.

6. If the injection ports are not being used, ensure the plugs are installed and tightened. Thread sealing tape is recommended.

7. Replace the wheel liner.

Congratulations! You are ready to begin experiencing the improved power and driving excitement of your MBRP Inc. intercooler pipe upgrade. We know you will enjoy your purchase.