

IC3403

2.5" INTERCOOLER PIPE KIT 2016 - UP
FORD FOCUS RS 2.3 ECOBOOST

MBRP
INC.
PERFORMANCE EXHAUST

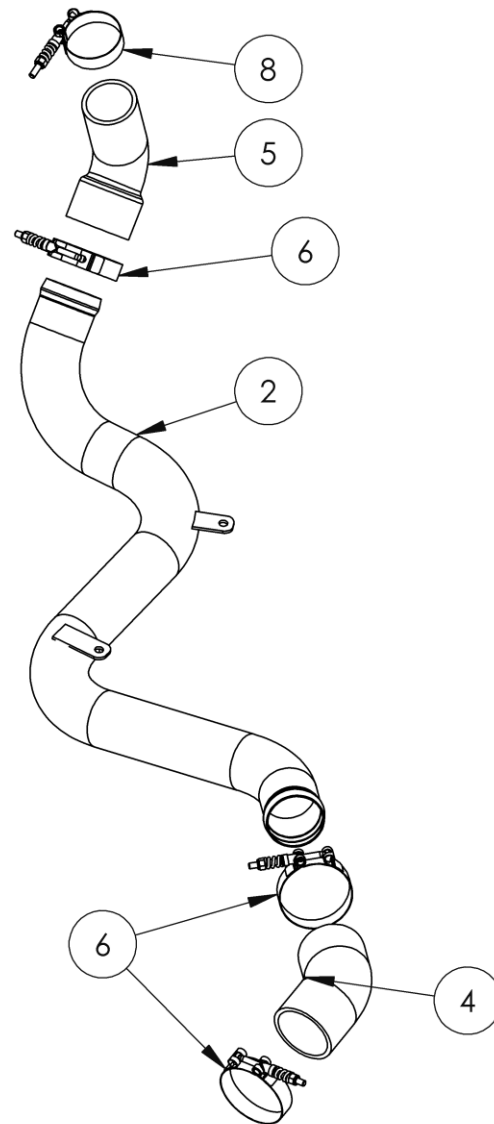
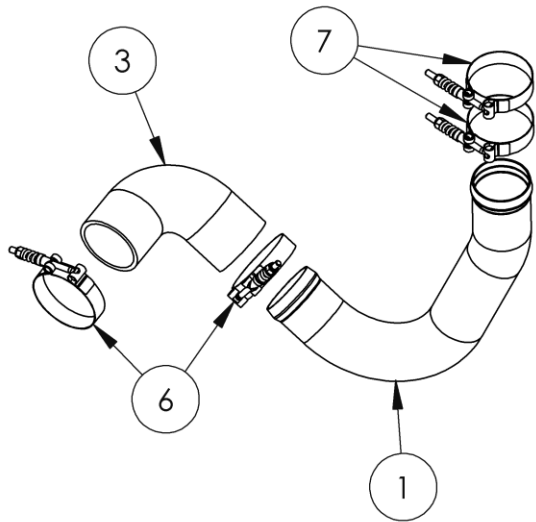

1. COLD-SIDE INTERCOOLER PIPE
2. HOT-SIDE INTERCOOLER PIPE
3. 2.5", 90° HOSE
4. 2.5", 45° HOSE
5. 2-2.5" TRANSITION HOSE
6. LARGE BAND CLAMP (5 PCS)
7. MEDIUM BAND CLAMP (2 PCS)
8. SMALL BAND CLAMP

PLEASE READ BEFORE STARTING INSTALLATION

While MBRP Inc. has made every effort to ensure that all components of this system are of superior quality and properly packaged, it is the installer's responsibility to ensure the following before removal of the factory parts:

- that ALL components shown above are present.
- that ALL mating components fit together.
- that there are no damaged components.
- that the system you have purchased is appropriate for your vehicle year, model and configuration.
- that the system will not interfere with any modifications previously installed or planned.
- that you have read and understand these instructions.

If you have any questions or are uncertain about any aspect of the installation of this system to your vehicle please contact your dealer before commencing installation.

Removal of Stock System:



Figure 1

1. Remove the upper engine cover and loosen the air charge hose clamp on the throttle body.
Refer to Figure 1.



Figure 2

2. Remove the under car engine cover.
3. Remove the front lower valance panel (optional, but it gives easier access to the intercooler connections).



Figure 3

4. Remove the nuts securing the hot side intercooler pipe.
Refer to Figures 2 and 3.



Figure 4

5. Remove the suspension cross-brace.
Refer to Figure 4.



Figure 5

6. Loosen the air charge hose clamp connections at the intercooler and the turbocharger.
Refer to Figures 5, 6 and 7.

7. Remove both of the factory air charge pipes from the vehicle.



Figure 6



Figure 7



Figure 8

8. Remove the throttle body air charge hose from the factory adaptor for re-use. Refer to **Figure 8**.

Installation of MBRP Inc. Intercooler Pipes:

Note: The hoses supplied are a tight fit to the pipes. Some silicone spray or other suitable lubricant is required for installation.

1. Install the throttle body air charge hose onto the **Cold-Side Intercooler Pipe**, using one **Medium Band Clamp**. Place the remaining **Medium Band Clamp** on the throttle body air charge hose. Position the clamps so you can access them to tighten once the **Cold-Side Intercooler Pipe** is in place.

2. Place one **Large Band Clamp** over the intercooler outlet. Refer to **Figure 9**.

3. Remove the upper air conditioning compressor bolt which will be reused to mount the **Cold-Side Intercooler Pipe**. Refer to **Figure 10** (Arrow).

4. Position the **Cold-Side Intercooler Pipe** in place. Place one **Large Band Clamp** over the **Cold-Side Intercooler Pipe**. Carefully install the **90° Hose** onto the intercooler outlet and the **Cold-Side Intercooler Pipe**. It is a very tight fit requiring some extra patience. Refer to **Figure 10**.



Figure 9



Figure 10



Figure 11

5. Install the throttle body air charge hose connector onto the throttle body and the **Large Band Clamp** onto the **90° Hose**.

6. Install the **Cold-Side Intercooler Pipe** bracket using the previously removed bolt and tighten both clamps on the **Hose Elbow**. Ensure the throttle body connection stays in place.

Refer to Figure 11.

7. Place one **Large Band Clamp** and the **2-2.5" Transition Hose** onto the **Hot-Side Pipe** inlet. Place the **Small Band Clamp** onto the small end of the **2-2.5" Transition Hose**.

8. Place one **Large Band Clamp** over the other end of the **Hot-Side Intercooler Pipe**.

9. Place one **Large Band Clamp** and the **45° Hose** over the intercooler inlet and install the **Hot-Side Intercooler Pipe** into the **45° Hose**.

Refer to Figure 12.



Figure 12

10. Install the **2-2.5" Transition Hose** onto the turbocharger outlet.

Refer to Figure 13.

11. Install the nuts (removed in step 4) onto the **Hot-Side Intercooler Pipe** brackets.

Refer to Figures 14.

12. Align the **Hot-Side Intercooler Pipe** with the oil pan recess and tighten the retaining hardware.



Figure 13

13. Tighten all T-bolt clamps.

14. Ensure there is proper clearance around all hoses, pipes, and clamps. Pay particular attention to the **Cold-Side Intercooler Pipe** and air conditioning lines and the engine oil cooler.

15. Re-install the cross-brace, front lower valence panel (if removed) and the under car engine cover.

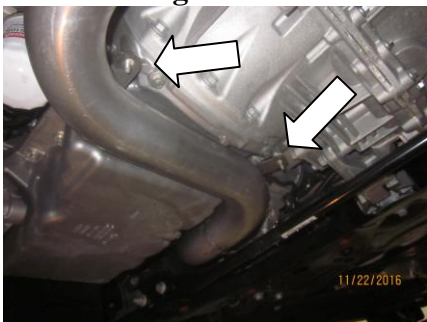

Figure 14

Congratulations! You are ready to begin experiencing the improved power and driving experience of your **MBRP Inc.** intercooler pipe upgrade. We know you will enjoy your purchase.