

S4112304

**FORD FOCUS ZX3/ZX5 2004-2007
2.0L 2.3L DURATEC**

MBRP
INC.

PERFORMANCE EXHAUST

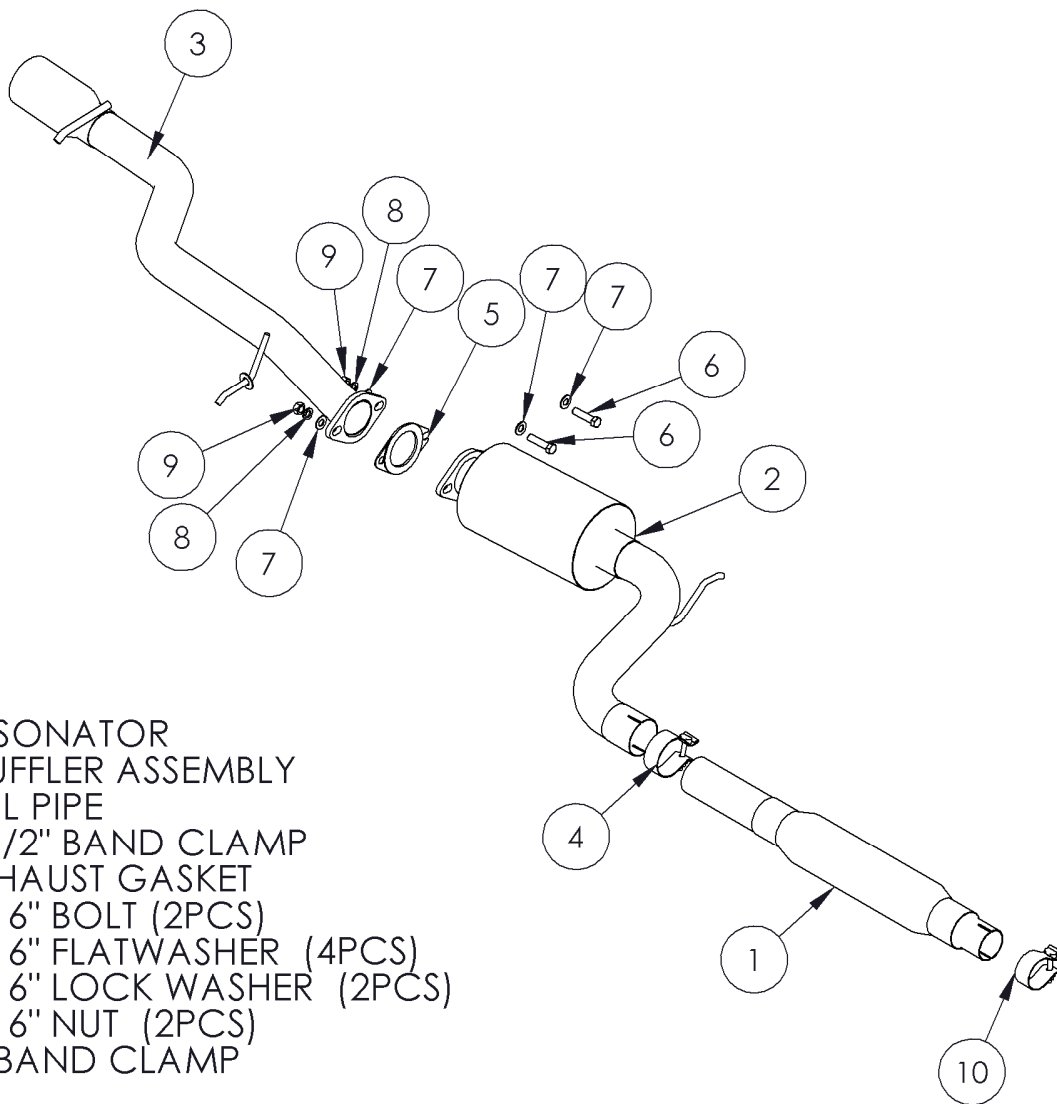

1. RESONATOR
2. MUFFLER ASSEMBLY
3. TAIL PIPE
4. 2 1/2" BAND CLAMP
5. EXHAUST GASKET
6. 7/16" BOLT (2PCS)
7. 7/16" FLATWASHER (4PCS)
8. 7/16" LOCK WASHER (2PCS)
9. 7/16" NUT (2PCS)
10. 2" BAND CLAMP

PLEASE READ BEFORE STARTING INSTALATION

While MBRP Inc. has made every effort to ensure that all components of this system are of superior quality and properly packaged, it is the installer's responsibility to ensure the following before removal of the factory exhaust:

- that ALL components shown above are present.
- that ALL mating components fit together.
- that there are no damaged components.
- that the system you have purchased is appropriate for your vehicle year, model and configuration.
- that the system will not interfere with any modifications previously installed or planned.
- that you have read and understand these instructions.



Figure 1

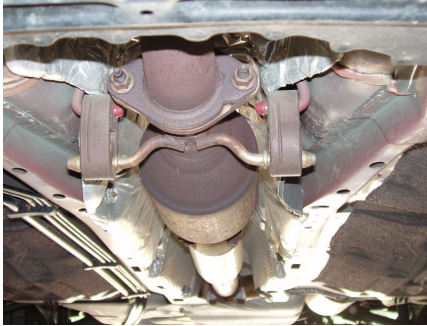

Figure 2



Figure 3



Figure 4



04-07 FORD FOCUS (DURATEC ENGINE)

Removal of stock system:

1. Removal may require cutting the pipe just behind the first muffler before the axle.
2. Remove the exhaust from the behind the second catalytic converter. Leave OEM hangers (rubber insulators) in place.

Installation of MBRP exhaust:

1. Cut the exhaust pipe 2" rearward of second catalytic converter. **Refer to Figure 1.**
2. Using the 2" **Band Clamp** supplied, attach the **Resonator** to the second catalytic converter. **Refer to Figure 2.**
3. Install the **Muffler Assembly** into the rubber insulator located over the assembly. Using the 2 1/2" **Band Clamp** supplied attach the slip joint into the **Resonator** (DO NOT tighten clamp until all components are installed and in place). **Refer to Figure 3.**
4. Install the **Tail Pipe** from the rear of the vehicle and over the rear axle of the car. Attach the **Tail Pipe** to the existing rubber insulator on the vehicle tie down bracket mounted to the frame. Use the **Exhaust Gasket** and fasteners provided to bolt the flanges together. **Refer to Figure 4.**
5. Check along the whole length of the exhaust system to ensure that there is adequate clearance around fuel and brake lines or any wiring. If any interference is detected relocate or adjust.

Congratulations! You are ready to begin experiencing the improved power, sound and driving experience of your MBRP Inc. performance exhaust system. We hope you enjoy your purchase. If technical assistance is required, please call our staff Toll Free at 1-888-636-7223.