

S4608

2019-2021 VOLKSWAGEN JETTA GLI, 2.0T,
CAT-BACK, 3", DUAL SPLIT REAR

MBRP®

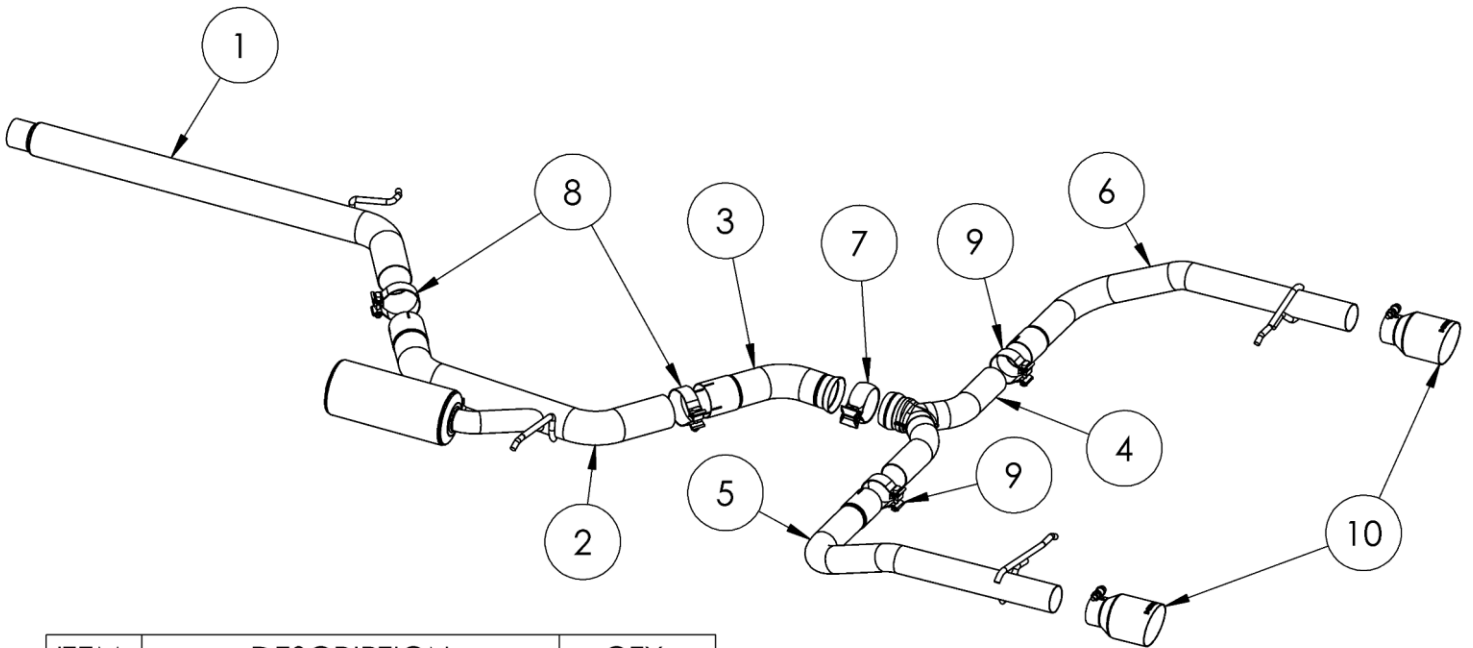

ITEM	DESCRIPTION	QTY.
1	FRONT PIPE	1
2	MID PIPE	1
3	EXTENSION PIPE	1
4	Y PIPE	1
5	DRIVER-SIDE TAIL PIPE	1
6	PASSENGER-SIDE TAIL PIPE	1
7	3.0" SWIVEL CLAMP	1
8	3.0" CLAMP	2
9	2.5" CLAMP	2
10	TIP	2

PLEASE READ BEFORE STARTING INSTALLATION

While MBRP has made every effort to ensure that all components of this system are of superior quality and properly packaged, it is the installer's responsibility to ensure the following before removal of the factory exhaust:

- that ALL components shown above are present.
- that ALL mating components fit together.
- that there are no damaged components.
- that the system you have purchased is appropriate for your vehicle year, model and configuration.
- that the system will not interfere with any modifications previously installed or planned.
- that you have read and understand these instructions.

If you have any questions or are uncertain about any aspect of the installation of this system to your vehicle please contact your dealer before commencing installation.

MBRP

Removal of Stock System



Figure 1



Figure 2

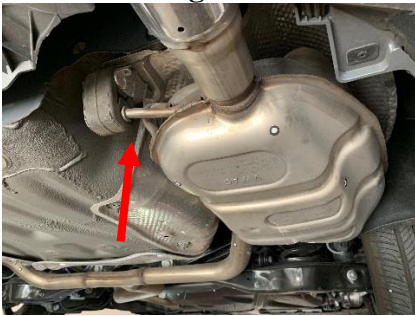

Figure 3

1. Apply penetrating lubricant liberally to all exhaust fasteners, hangers and rubber isolators.

2. Loosen band clamp at the inlet of the OEM cat back exhaust.
Refer to Figure 1.

3. Remove crossmember located rearward of the OEM resonator.
Refer to Figure 2.

4. Remove the front hanger from the rubber isolator. Remove the hanger on the front of the driver's side muffler from the rubber isolator and remove the isolator from the vehicle. This will be reused later.
Refer to Figure 5.

5. Unbolt both rear muffler hangers from the vehicle and remove the complete cat back exhaust from the vehicle. Remove the OEM band clamp and both rear muffler hangers from the OEM cat back as these will be reused during the installation of your **MBRP** performance exhaust. Note the orientation of the rear muffler hangers for installation.
Refer to Figure 3.

Installation of MBRP Performance Exhaust



Figure 4

1. Using the OEM band clamp, install the **Front Pipe**. Do not fully tighten until all parts are installed. Install the hanger into the rubber isolator.
Refer to Figure 4.

2. Install the OEM rubber isolator removed in Step 4 onto the OEM Hanger located ahead of the driver-side rear wheel.
Refer to Figure 6.

3. Using a 3" **Clamp**, install the **Mid Pipe** onto the outlet of the **Front Pipe** and insert the hanger into the **Isolator**.
Refer to Figure 6.

4. Re-Install the previously removed crossmember.

5. Using a 3" **Clamp**, install the **Extension Pipe** onto the outlet of the **Mid Pipe**.



Figure 5

MBRP



Figure 6

6. Using a 3" Swivel Clamp, install the **Y-Pipe** onto the outlet of the **Extension Pipe**.
Refer to Figure 7.

7. Install one of the OEM muffler hangers onto the **Driver-Side Tailpipe** and install the assembly onto the **Y Pipe** with a **2.5" Clamp**. Secure the OEM hanger assembly to the vehicle with the previously removed bolt.
Refer to Figure 8.

Note: The OEM hanger assemblies have slotted mounting holes that can be used to center the tips in the rear fascia when the installation is complete.



Figure 7

8. Repeat Step 7 for the **Passenger-Side Tailpipe**.

9. Install the **Tips** and align to your preference.
Refer to Figure 9.

10. Carefully align the system and tips. Align the edge of each band clamp with the edge of the joint it is connecting. Tighten all hardware and clamps, starting at the front and working rearward to secure the system. Check along the full length of the exhaust system to ensure there is adequate clearance for fuel lines, vent lines, brake lines, frame, bodywork, suspension and any wiring, etc. If there is any interference detected, relocate or adjust to provide adequate clearance. Ensure all clamp connections are secure and components are unable to rotate or slide. Band clamps require approximately 45 lb-ft (60 N-m) of torque. Verify clearances, system security and band clamp torque after 30-60 miles (50-100 km) of driving.



Figure 8

Congratulations! You are ready to begin experiencing the improved power, sound and driving experience of your **MBRP** Performance Exhaust. We know you will enjoy your purchase!



Figure 9