

S4700

2013-2018 HYUNDAI VELOSTER TURBO, CAT
BACK, DUAL EXIT *WITHOUT UNDERBODY
CATALYTIC CONVERTER

MBRP
INC.
PERFORMANCE EXHAUST

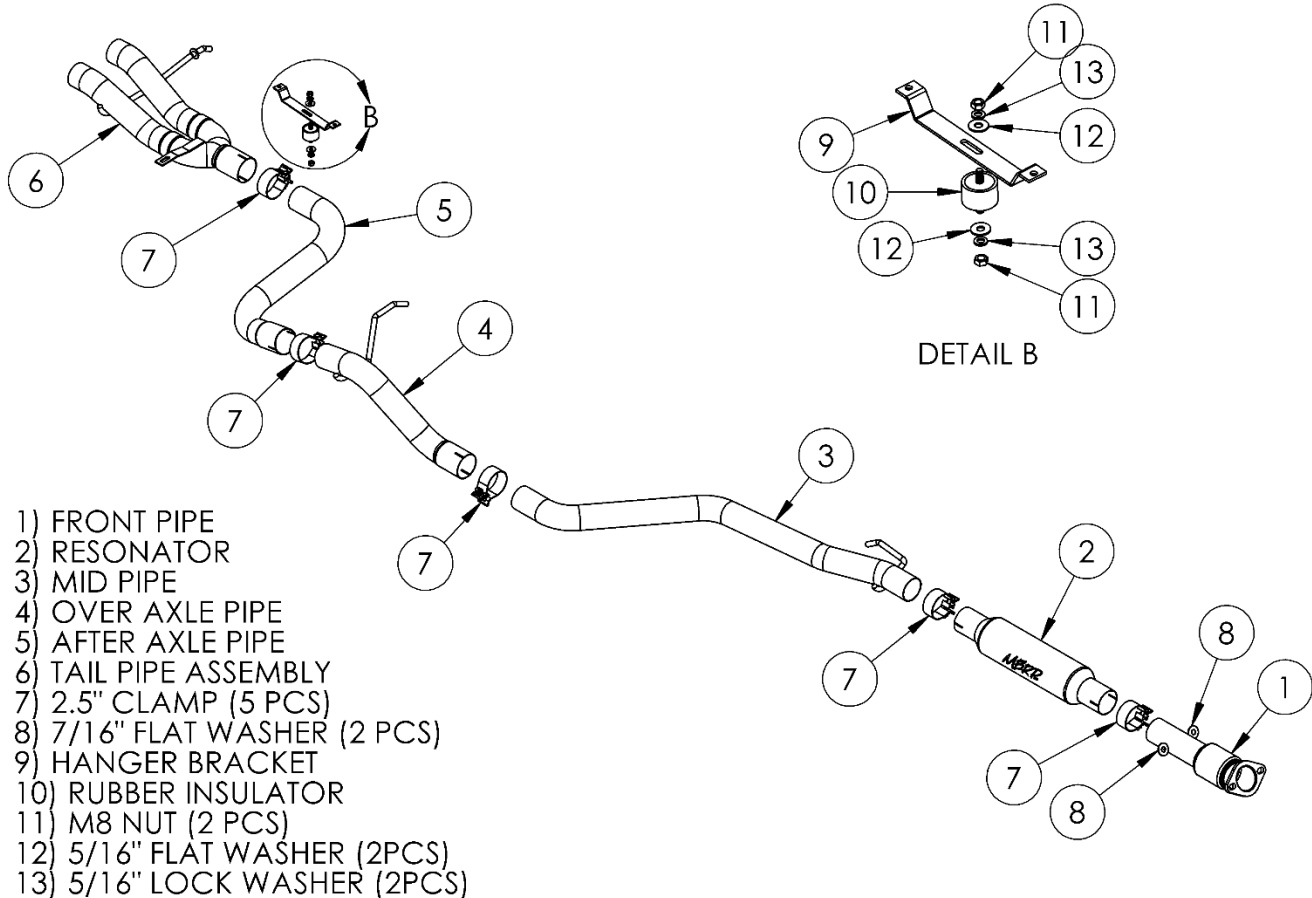

NOTE: SADDLE CLAMPS ARE USED ON ALUMINIZED SYSTEMS

PLEASE READ BEFORE STARTING INSTALLATION

While MBRP Inc. has made every effort to ensure that all components of this system are of superior quality and properly packaged, it is the installer's responsibility to ensure the following before removal of the factory components:

- that ALL components shown above are present.
- that ALL mating components fit together.
- that there are no damaged components.
- that the system you have purchased is appropriate for your vehicle year, model and configuration.
- that the system will not interfere with any modifications previously installed or planned.
- that you have read and understand these instructions.

If you have any questions or are uncertain about any aspect of the installation of this system to your vehicle please contact your dealer before commencing installation.

Removal of Stock System



Figure 1



Figure 2



Figure 3



Figure 4



Figure 5

1. Apply a penetrating lubricant liberally to all exhaust fasteners, hangers and rubber insulators.
2. Remove the rubber insulators from the hangers and the nuts on the flange that connects the muffler assembly to the over axle pipe. Remove the stock muffler assembly. **Refer to Figure 1.**
3. Remove the over-axle and tail pipe.
4. Remove the nuts that connect the stock down pipe to the front pipe assembly. Keep the nuts for installation. Remove the stock front pipe assembly. **Refer to Figure 2.**

Installation of *MBRP Inc.* Performance Exhaust

1. Install the **Front Pipe Assembly** to the flange on the downpipe with **7/16" Washers** and stock nuts. **Refer to Figure 3.**
2. Slide a **2.5" Clamp** over the **Resonator** and install it onto the **Front Pipe Assembly.**
3. Slide a **2.5" Clamp** on the outlet of the **Resonator** and install the **Mid Pipe** into the **Resonator**. Insert the hanger into the rubber insulator. **Refer to Figure 4.**
4. Slide a **2.5" Clamp** onto the **Over Axle Pipe** and install it onto the **Mid Pipe**. Insert the hanger into the rubber insulator. **Refer to Figure 5.**
5. Slide a **2.5" Clamp** on the **After Axle Pipe** then install it into the **Over Axle Pipe.**



Figure 6



Figure 7

6. Install the **Hanger Bracket** onto the underbody studs used to hold the heat shield in place. **Refer to Figure 6.**

7. Slide a **2.5" Clamp** on the **Tail Pipe Assembly** then install it into the **After Axle Pipe**. Insert the reward hanger into the rubber insulator, and with the supplied hardware, attach the flat bar hanger to the **Hanger Bracket** with the **Rubber Insulator** between them. **Refer to Figure 6.**

8. Centre the **Tail Pipe Assembly** as required to align the tails with the center of the bezel holes. **Refer to Figure 7.**

9. Fully tighten all clamps (use an impact wrench or breaker bar as required).

10. Check along the whole length of the exhaust system to ensure that there is adequate clearance around the shock, shields, trunk panel, fuel and brake lines, or any wiring. If any interference is detected relocate or adjust.

Congratulations! You are ready to begin experiencing the improved performance and driving pleasure of your *MBRP Inc.* performance exhaust system. We know you will enjoy your purchase.