

**S5028304, S5028AL**  
**04-05 CHEV. CCOLORADO**  
**04-05 GMC CANYON**  
**EC/CC-SB, 2.8L / 3.5L**

**MBRP**  
INC.  
**PERFORMANCE EXHAUST**

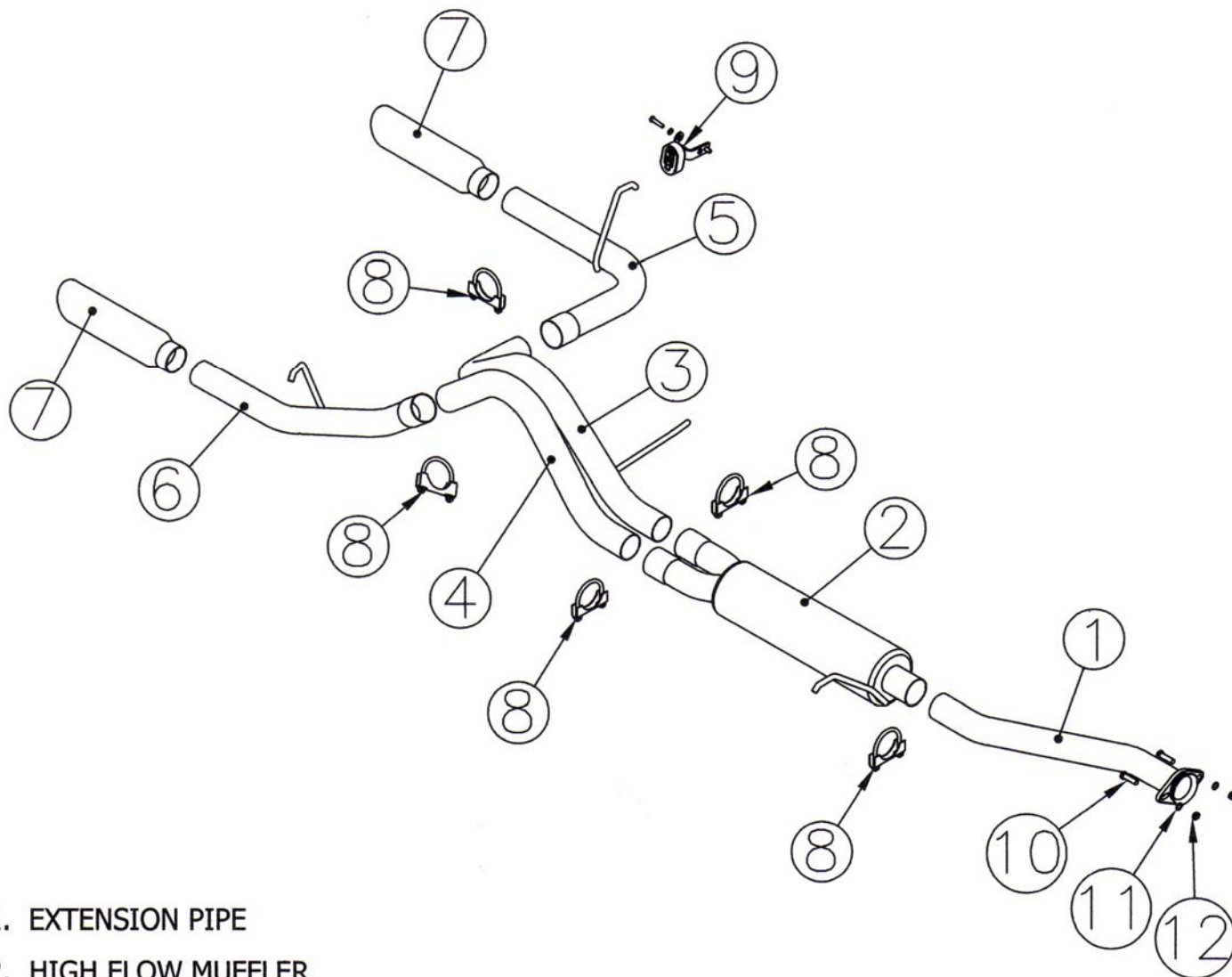

- 1. EXTENSION PIPE
- 2. HIGH FLOW MUFFLER
- 3. DRIVER SIDE OVER AXLE PIPE
- 4. PASS. SIDE OVER AXLE PIPE
- 5. DRIVER SIDE TAIL PIPE
- 6. PASS. SIDE TAIL PIPE
- 7. POLISHED TIPS (2 PCS.)
- 8. 2.5" CLAMPS (5 PCS.)

- 9. HANGER ASSEMBLY
- 10. 3/8" X 1.5" BOLT (2 PCS.)
- 11. 3/8" LOCK WASHER (2 PCS.)
- 12. 3/8" NUT (2 PCS.)



**PERFORMANCE EXHAUST**

## **04-05 Chev./GMC Colorado/Canyon EC/CC-SB, 2.8L/3.5L**

*"COOL DUALS"<sup>TM</sup>*

**These instructions cover the following systems: S5028304, S5028AL**

### **Removal of stock system:**

1. Remove the spare tire from the vehicle.
2. Apply a penetrating lubricant liberally to all exhaust fasteners, hangers and rubber insulators.
3. Cut the exhaust in front of the muffler so that it can be removed from the vehicle.
4. Remove the nuts from the studs holding the front flange together and disconnect exhaust system.
5. Remove the hangers from the rubber insulators and remove the exhaust from the vehicle.
6. The studs located in the exhaust flange must be removed. This can be accomplished using a hammer. The studs will be replaced by hardware supplied with the system.

### **Installation of MBRP Inc. Performance Exhaust:**

1. Loosely attach the extension pipe at the flange using the hardware provided.
2. Install muffler onto extension pipe with the outlets horizontal and install the hanger into the factory rubber insulator.
3. Loosely install the driver side over axle pipe connecting it to the outlet closest to the drive shaft. Install the hanger into the rubber insulator located above the muffler outlets.
4. Feed the passenger side over axle pipe over the axle and install it loosely.
5. Connect the expanded end of the driver side tail pipe to the driver side over axle pipe.
6. Move the driver side tail pipe into approximate position. Using the factory hole provided in the cross member located directly above the tail pipe hanger, attach the hanger provided using the supplied hardware.
7. Connect the expanded end of the passenger side tail pipe to the passenger side over axle pipe and install the hanger into the factory rubber insulator.
9. Install the mirror polished tips. It is recommended to install them at this point to assist with the final system alignment.
10. Install provided clamps to the pipe connections where required. Align the exhaust as required before tightening clamps.
11. Starting at the front of the exhaust tighten all clamps and connections.
12. Check along the whole length of the exhaust system to ensure that there is adequate clearance around the spare tire, fuel and brake lines or any wiring. If any interference is detected relocate or adjust.

**Congratulations!** You are ready to begin enjoying the improved performance and driving experience of your MBRP Inc. Cool Duals system. We hope you enjoy your purchase.