

S5120304

**2004-06 DODGE RAM SRT-10
8.3L V10, REGULAR CAB**

MBRP
INC.
PERFORMANCE EXHAUST

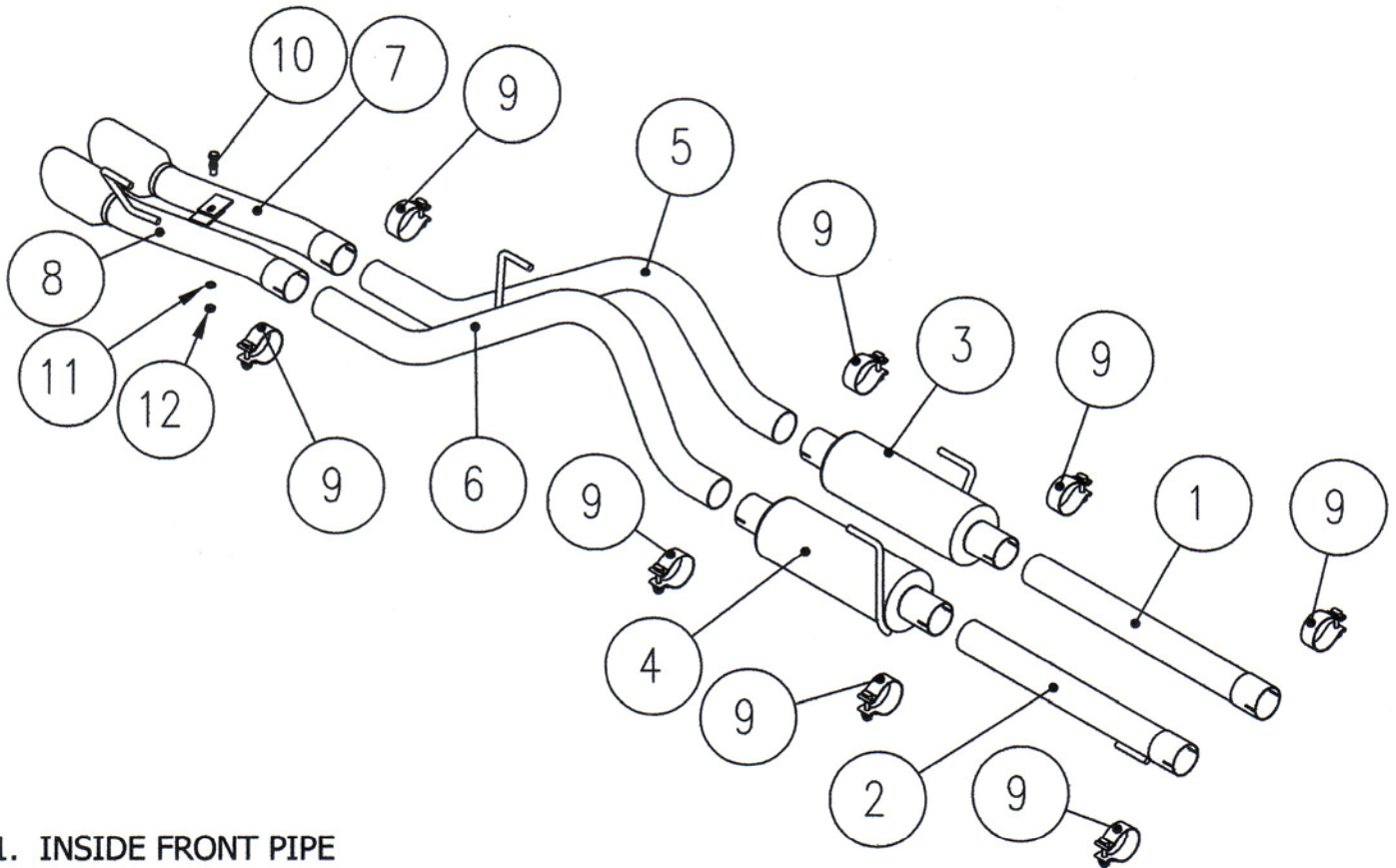

1. INSIDE FRONT PIPE
2. OUTSIDE FRONT PIPE
3. INSIDE MUFFLER
4. OUTSIDE MUFFLER
5. INSIDE OVER AXLE PIPE
6. OUTSIDE OVER AXLE PIPE
7. INSIDE TAIL PIPE
8. OUTSIDE TAIL PIPE
9. 2.5" ACCUSEAL CLAMPS (8)
10. 3/8" X 1.5" HEX BOLT
11. 3/8" LOCKWASHER
12. 3/8" HEX NUT



PERFORMANCE EXHAUST

2004-06 DODGE RAM SRT-10
8.3L V10 REGULAR CAB

PLEASE READ BEFORE STARTING INSTALLATION

While MBRPinc has made every effort to ensure that all components of this system are of superior quality and properly packaged, it is the installer's responsibility to ensure the following before removal of the factory exhaust:
• that ALL components shown in the illustration on page 1 are present.
• that ALL mating components fit together.
• that there are no damaged components.
• that the system you have purchased is appropriate for your vehicle year, model and configuration.
• that the system will not interfere with any modifications previously installed.
• that you have read and understand these instructions.
If you have any questions or are uncertain about any aspect of the installation of this system to your vehicle please contact your dealer before commencing installation.

Removal of stock system:

1. Apply a penetrating lubricant liberally to all exhaust fasteners, hangers and rubber insulators.
2. Loosen the clamps behind the muffler and remove the tail pipes from the vehicle.
3. Loosen the clamps located in front of the muffler and remove it from the vehicle.

Installation of MBRP Inc Performance Exhaust:

1. Slide the **2.5" Accuseal Clamps** over the two ends of the factory exhaust and slide the **Inside Front Pipe** and the **Outside Front Pipe** (has hanger attached) onto the factory exhaust pipes. Now slide the hanger located on **Outside Front Pipe** into the rubber insulator.
2. Slide the **2.5" Accuseal Clamps** over the two ends of the **Front Pipes**. Slide the **Inside Muffler** onto the **Inside Front Pipe** and slide the hanger into the rubber insulator. Now slide the **Outside Muffler** onto the **Outside Front Pipe** and slide the hanger into the rubber insulator.
3. Slide a **2.5" Accuseal Clamp** over the **Inside Muffler** outlet. From the rear of the vehicle place the **Inside Over Axle Pipe** (has hanger attached) over the rear axle and slide it into the **Inside Muffler**. Now slide the hanger into the rubber insulator.
4. Slide a **2.5" Accuseal Clamp** over the **Outside Muffler** outlet. From the rear of the vehicle place the **Outside Over Axle Pipe** over the rear axle and slide it into the **Outside Muffler**.
5. Slide a **2.5" Accuseal Clamp** over the **Outside Tail Pipe** and install it onto the **Outside Over Axle Pipe**. Now slide the hanger into the rubber insulator.
6. Slide a **2.5" Accuseal Clamp** over the **Inside Tail Pipe** and install it onto the **Inside Over Axle Pipe**.
7. Align the system for best fit of the tips and fasten the **Tail Pipes** together using the **3/8" Hardware** supplied.
8. Starting at the front of the exhaust, tighten all clamps and connections.
9. Before starting the vehicle check along the whole length of the exhaust system to ensure that there is adequate clearance around the fuel and brake lines or any wiring. If any interference is detected relocate or adjust.

Congratulations! You are ready to begin enjoying the improved performance and driving experience of your MBRP Inc performance exhaust system. We hope you enjoy your purchase.