

S5130

2003 - 2012 DODGE 2500/3500, 5.7L HEMI
2006-2008 DODGE MEGA CAB 1500, 5.7L
HEMI DUAL SPLIT SIDE

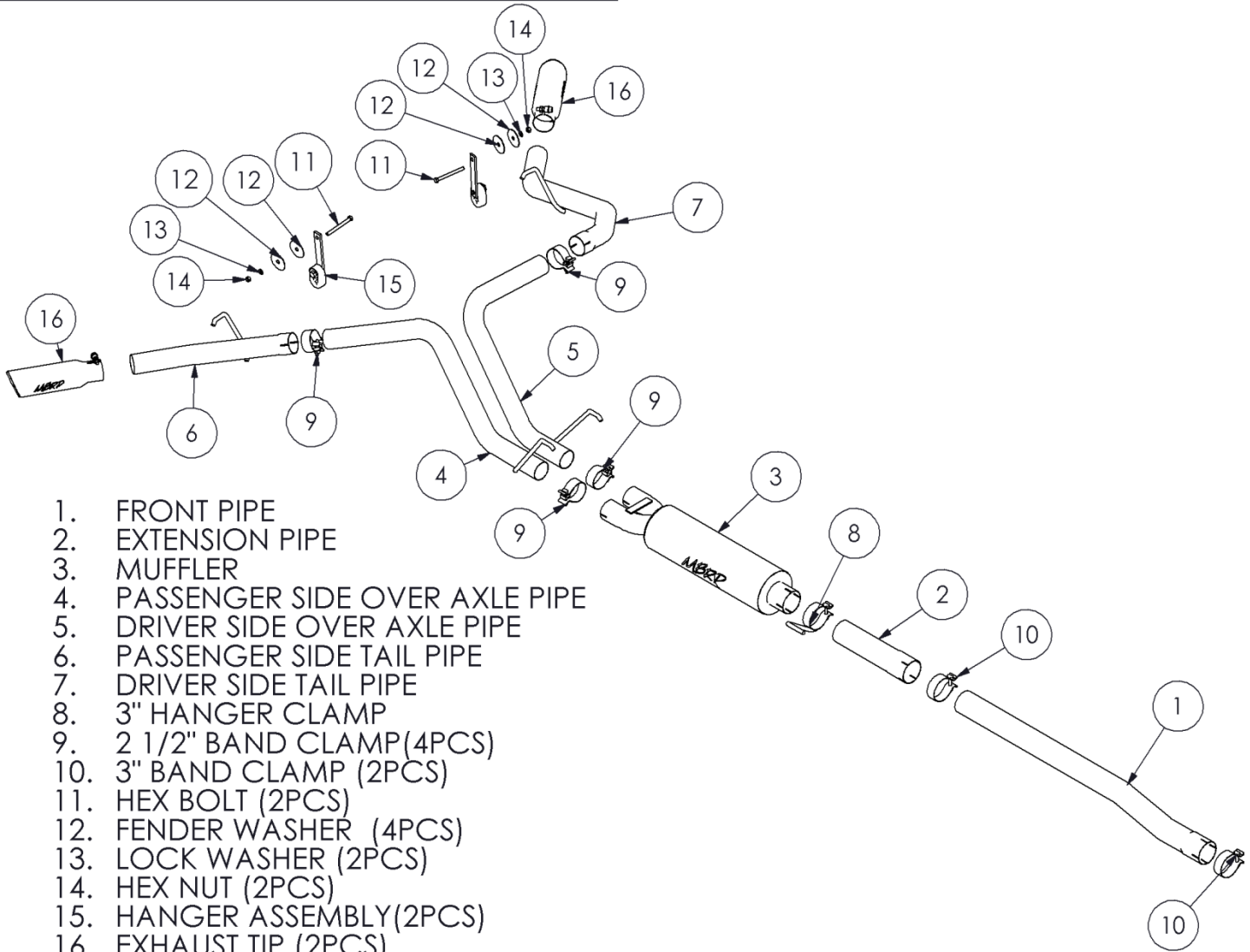

1. FRONT PIPE
2. EXTENSION PIPE
3. MUFFLER
4. PASSENGER SIDE OVER AXLE PIPE
5. DRIVER SIDE OVER AXLE PIPE
6. PASSENGER SIDE TAIL PIPE
7. DRIVER SIDE TAIL PIPE
8. 3" HANGER CLAMP
9. 2 1/2" BAND CLAMP (4PCS)
10. 3" BAND CLAMP (2PCS)
11. HEX BOLT (2PCS)
12. FENDER WASHER (4PCS)
13. LOCK WASHER (2PCS)
14. HEX NUT (2PCS)
15. HANGER ASSEMBLY (2PCS)
16. EXHAUST TIP (2PCS)

NOTE: SADDLE CLAMPS ARE USED IN ALUMINIZED SYSTEMS

PLEASE READ BEFORE STARTING INSTALLATION

While MBRP Inc. has made every effort to ensure that all components of this system are of superior quality and properly packaged, it is the installer's responsibility to ensure the following before removal of the factory exhaust:

- that ALL components shown above are present.
- that ALL mating components fit together.
- that there are no damaged components.
- that the system you have purchased is appropriate for your vehicle year, model and configuration.
- that the system will not interfere with any modifications previously installed or planned.
- that you have read and understand these instructions.

If you have any questions or are uncertain about any aspect of the installation of this system to your vehicle please contact your dealer before commencing installation.

Removal of Stock System



Figure 1



Figure 2

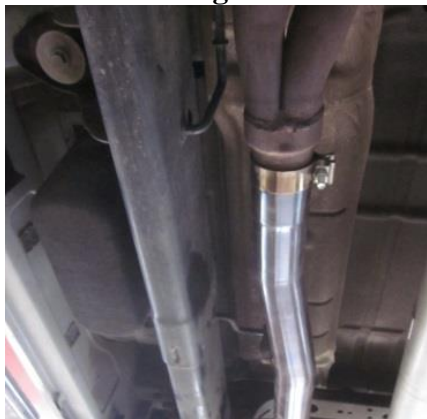

Figure 3



Figure 4

1. Apply a penetrating lubricant liberally to all exhaust fasteners, hangers and rubber insulators. **Refer to Figure 1 & 2.**

2. Remove the clamp just after the Y-pipe.

3. Remove the clamp from the rear of the muffler.

4. Remove the stock exhaust from the existing rubber isolators and remove the system from the vehicle.

5. Temporarily remove the spare tire and the heat shield around the spare tire. **Refer to Figure 2.**

Installation of MBRP Inc. Performance Exhaust

1. Install the **Front Pipe** over the existing Y using the **3" Clamp**. Leave all clamps loose enough for adjustment. **Refer to Figure 3.**

2. Slide the **3" Hanger Clamp** over the **Extension Pipe** or **Front Pipe** and install the **Muffler** onto the **Extension Pipe** or **Front Pipe**. Insert the **3" Hanger Clamp** into the existing rubber insulator. **Refer to Figure 4.**

Note the **Extension Pipe** is required on 2010 –Up Crew Cab 8' box only.

The front pipe will have to be trimmed for the:
2003-Up Regular Cab models (shortened by 20")
2003-2009 Quad Cab 6' 4" box (shortened by 20")
2010- Up Crew Cab 6' 4" box (shortened by 11")



Figure 5

3. Slide two 2 ½” **Clamps** over the outlets of the **Muffler**. Position the **Driver Side Over Axle Pipe** over the axle and loosely attach it to the **Muffler**. Install the **Driver Side Over Axle Pipe** hanger into the factory rubber insulator. Repeat these steps for the **Passenger Side Over Axle Pipe**. Refer to **Figure 5**.



Figure 6

4. Slide a 2 ½” **Clamp** over the **Passenger Side Tail Pipe** and install onto the **Passenger Side Over Axle Pipe**. Refer to **Figure 6**.



Figure 7

5. Slide **Driver Side Tail Pipe** hanger into rubber insulator and attach to the frame using fasteners provided. Refer to **Figure 7**. Repeat steps 4 and 5 for the **Passenger Side Tail Pipe**.



Figure 8

6. Install and adjust the **Exhaust Tip** to suit. Reinstall the heat shield a minor modification will be required. Trim Shield to fit with the **Hanger Assembly**. Refer to **Figures 7& 8**.



Figure 9



Figure 10

7. Align the exhaust as required. Starting at the front of the exhaust, tighten all clamps and connections.

8. Check along the whole length of the exhaust system to ensure that there is adequate clearance around the spare tire, fuel and brake lines or any wiring. If any interference is detected relocate or adjust.



Congratulations! You are ready to begin experiencing the improved performance and driving pleasure of your MBRP Inc. performance exhaust system. We know *you will enjoy your purchase.*