

S5148

03-13 DODGE RAM 2500/3500 & 06-08 DODGE RAM 1500 MEGA CAB, 5.7L HEMI, CAT BACK, 3" SINGLE

MBRP®

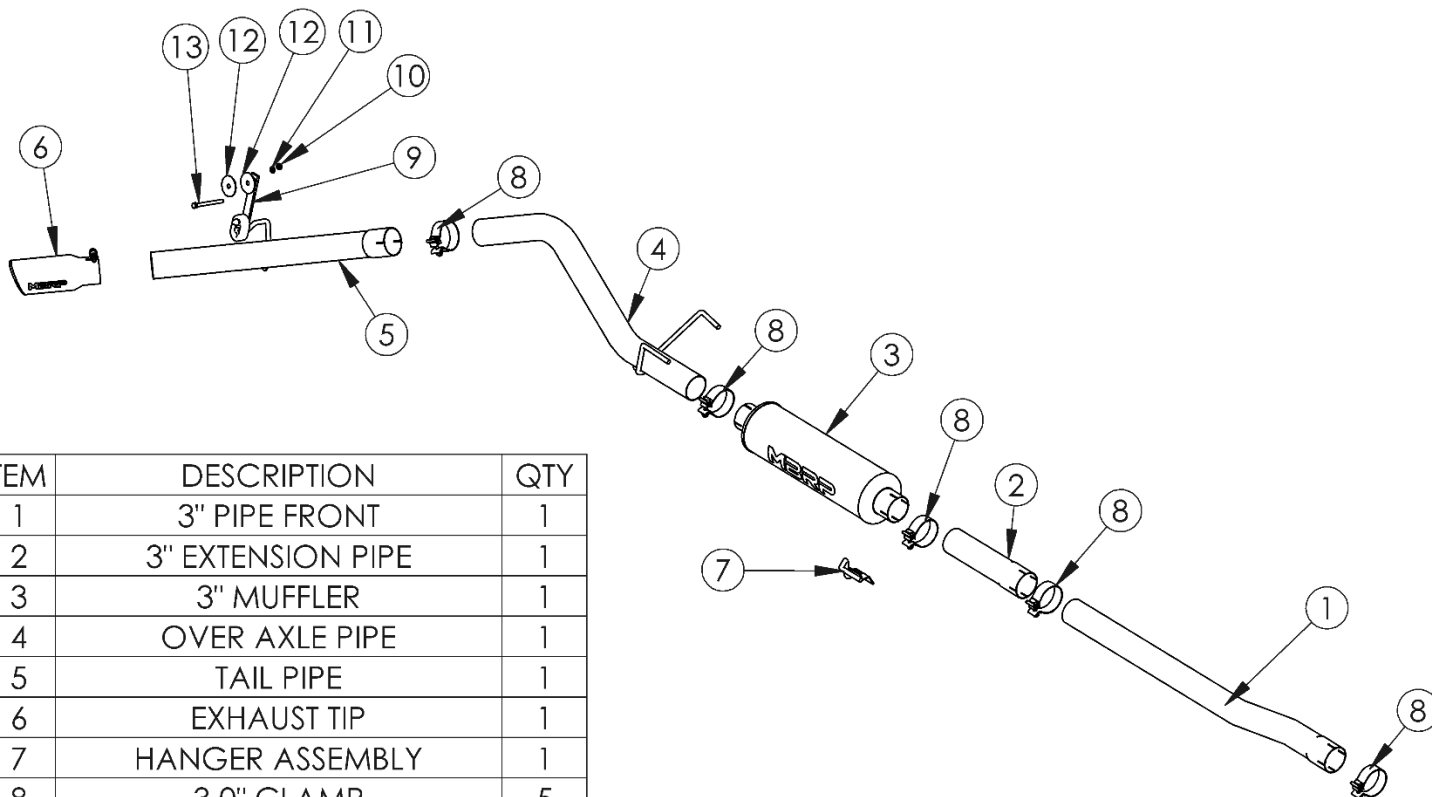

ITEM	DESCRIPTION	QTY
1	3" PIPE FRONT	1
2	3" EXTENSION PIPE	1
3	3" MUFFLER	1
4	OVER AXLE PIPE	1
5	TAIL PIPE	1
6	EXHAUST TIP	1
7	HANGER ASSEMBLY	1
8	3.0" CLAMP	5
9	HANGER ASSEMBLY	1
10	3/8" HEX NUT	1
11	3/8" LOCK WASHER	1
12	7/16" FENDER WASHER	2
13	3/8" HEX BOLT X 4"	1

PLEASE READ BEFORE STARTING INSTALLATION

While MBRP Inc. has made every effort to ensure that all components of this system are of superior quality and properly packaged, it is the installer's responsibility to ensure the following before removal of the factory exhaust:

- that ALL components shown above are present.
- that ALL mating components fit together.
- that there are no damaged components.
- that the system you have purchased is appropriate for your vehicle year, model and configuration.
- that the system will not interfere with any modifications previously installed or planned.
- that you have read and understand these instructions.

If you have any questions or are uncertain about any aspect of the installation of this system to your vehicle please contact your dealer before commencing installation.

MBRP®

Removal of Stock System



Figure 1

1. Apply a penetrating lubricant liberally to all exhaust fasteners, hangers and rubber insulators. **Refer to Figure 1 & 2.**

2. Remove the clamp just after the Y-pipe.

3. Remove the clamp from the rear of the muffler.

4. Remove the stock exhaust from the existing rubber isolators and remove the system from the vehicle.

5. Temporarily remove the spare tire and the heat shield around the spare tire. **Refer to Figure 2.**



Figure 2

Installation of MBRP Performance Exhaust

1. Install the **Front Pipe** over the existing Y using the **3" Clamp**. Leave all clamps loose enough for adjustment. **Refer to Figure 3.**

2. Slide the **3" Hang Tight™ Hanger clamp** over the **Extension Pipe** or **Front Pipe** and install the **Muffler** onto the **Extension Pipe** or **Front Pipe**. Install the Hang Tight™ Hanger onto a 3" Band Clamp using the procedure shown below. (Hang Tight™ Hanger not exactly as shown)



Figure 3

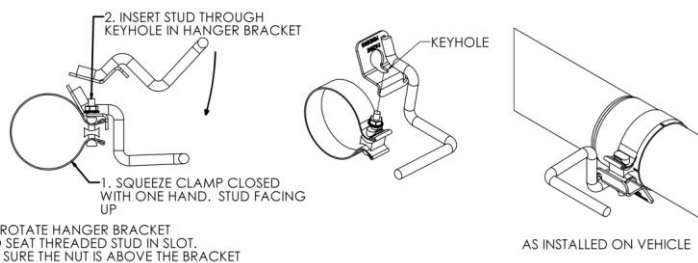

Slide the **3" Hang Tight™ Clamp** over the outlet side of the **Muffler**. Position the **Extension Pipe** and loosely attach it to the **Muffler**. Install the **3" Hang Tight™** into the existing rubber insulator. **Refer to Figure 4** for insulator location.



Figure 4

MBRP®



Figure 5



Figure 6



Figure 7



Figure 8

Note: The **Extension Pipe** is required on 2500/3500, 2010 –Up Crew Cab 8’ box only.

The front pipe will have to be trimmed for the following 2500/3500 models:

- 2003-Up Regular Cab models (shortened by 20”)
- 2003-2009 Quad Cab 6’ 4” box (shortened by 20”)
- 2010- Up Crew Cab 6’ 4” box (shortened by 11”)

3. Install the **Over Axle Pipe** into the **Muffler**. Install the **Over Axle Pipe** hangers into the existing rubber insulators. **Refer to Figure 5.**

4. Slide a **3” Clamp** onto the **Tail Pipe** and slide onto the **Over Axle Pipe**. Slide **Tail Pipe** hanger into the **Hanger Assembly** rubber insulator and attach to the frame using the fasteners provided. **Refer to Figure 6.**

5. Install and adjust the **Exhaust Tip** to suit. Reinstall the heat shield, a minor modification will be required. Trim Shield to fit with the **Hanger Assembly**. **Refer to Figures 7& 8.**

6. Align the edge of band clamp with the edge of the joint it is connecting. Tighten all hardware and clamps, starting at the front and working rearward to secure the system. Check along the full length of the exhaust system to ensure there is adequate clearance for fuel lines, vent lines, brake lines, frame, bodywork, suspension, and any wiring, etc. If there is any interference detected, relocate, or adjust to provide adequate clearance. Ensure all clamp connections are secure and components are unable to rotate or slide. Band clamps require approximately 45 lb-ft (60 N-m) of torque. Verify clearances, system security and band clamp torque after 30- 60 miles (50-100 km) of driving.

Congratulations! You are ready to begin experiencing the improved performance and driving pleasure of your **MBRP** performance exhaust system. We know you will enjoy your purchase.