

S5222

2009-2010 FORD F150,
REGULAR CAB (8' & 6.5' BOX) / EXTENDED
CAB (NOT 8' BOX) / CREW CAB,
4.6L/5.4L, CAT BACK, 3" SINGLE TURN DOWN

MBRP®

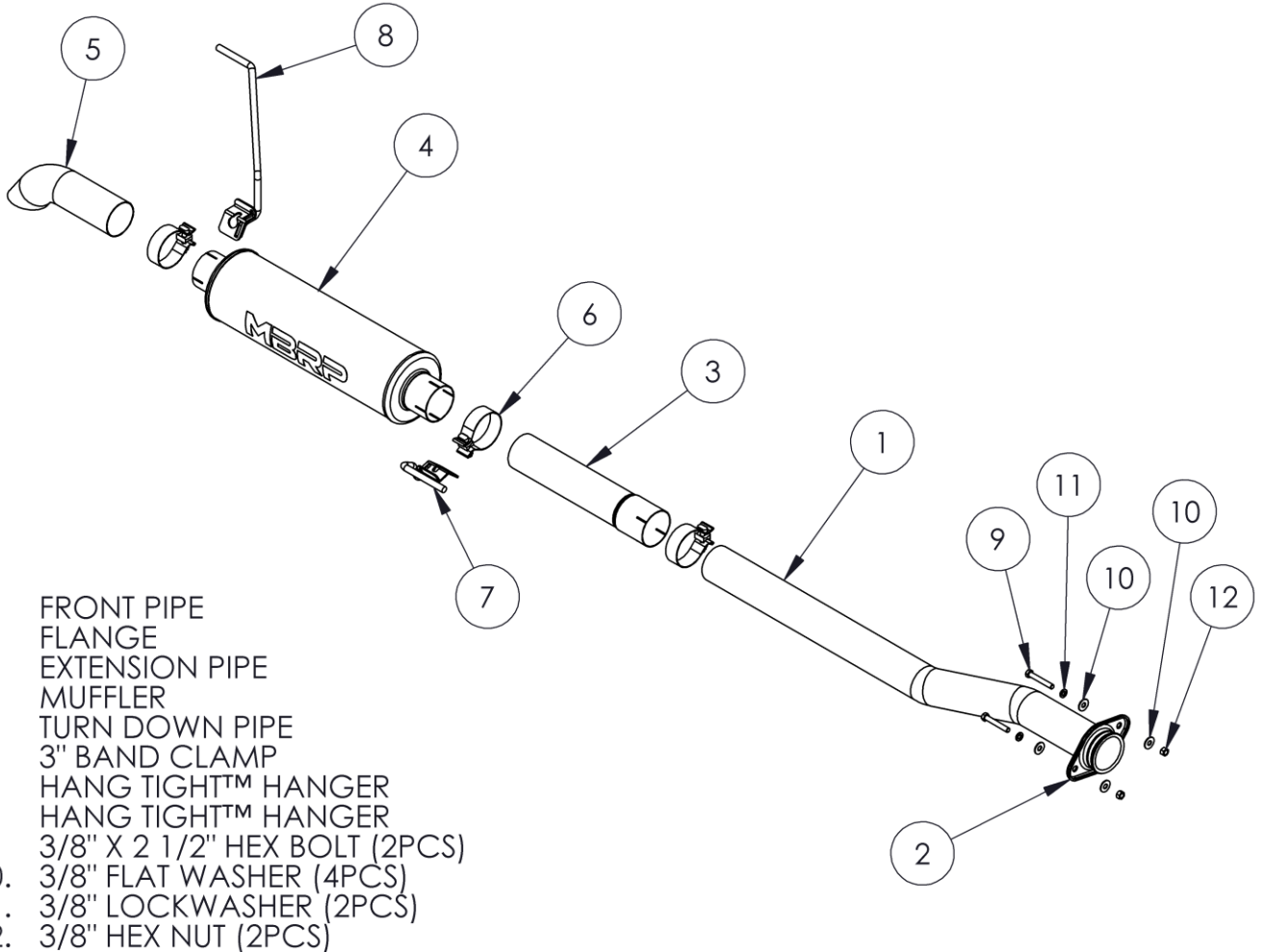

1. FRONT PIPE
2. FLANGE
3. EXTENSION PIPE
4. MUFFLER
5. TURN DOWN PIPE
6. 3" BAND CLAMP
7. HANG TIGHT™ HANGER
8. HANG TIGHT™ HANGER
9. 3/8" X 2 1/2" HEX BOLT (2PCS)
10. 3/8" FLAT WASHER (4PCS)
11. 3/8" LOCKWASHER (2PCS)
12. 3/8" HEX NUT (2PCS)

PLEASE READ BEFORE STARTING INSTALLATION

While MBRP has made every effort to ensure that all components of this system are of superior quality and properly packaged, it is the installer's responsibility to ensure the following before removal of the factory exhaust:

- that ALL components shown above are present.
- that ALL mating components fit together.
- that there are no damaged components.
- that the system you have purchased is appropriate for your vehicle year, model and configuration.
- that the system will not interfere with any modifications previously installed or planned.
- that you have read and understand these instructions.

If you have any questions or are uncertain about any aspect of the installation of this system to your vehicle please contact your dealer before commencing installation.

MBRP

Removal of Stock System:



Figure 1

1. Apply a penetrating lubricant liberally to all exhaust fasteners, hangers and rubber insulators.

2. Loosen the flange located behind the “Y” pipe.

Refer to Figure 1.

3. Loosen the clamp located in front of the muffler.

Refer to Figure 2.



Figure 2

4. Remove the hangers from the rubber insulators and remove the exhaust from the vehicle. If a hoist or hydraulic lift is not being used the tail pipe may need to be cut to clear the rear axle.

Refer to Figure 3.

Installation of MBRP Performance Exhaust:

1. Install the **Flange** onto the **Front Pipe**.

2. Install the **Front Pipe** to the existing flange using the fasteners provided.

Refer to Figure 4.



Figure 3

Note: The **Extension Pipe** will not be required on some models.

Model	Bed Length	Wheelbase	Extension Pipe Required	Shortening Front Pipe Required
Regular Cab (RC)	6.5'	126"	No	19"
Regular Cab (RC)	8'	145"	No	No
SuperCab (EC)	6.5'	145"	No	No
SuperCab (EC)	5.5'	133"	No	11"
SuperCrew (CC)	6.5'	157"	Yes	No
SuperCrew (CC)	5.5'	145"	No	No



Figure 4

3. Install the **Hang Tight™ Hangers** onto **3.0” Band Clamps** using the procedure shown below. (Hang Tight™ Hanger not exactly as shown)

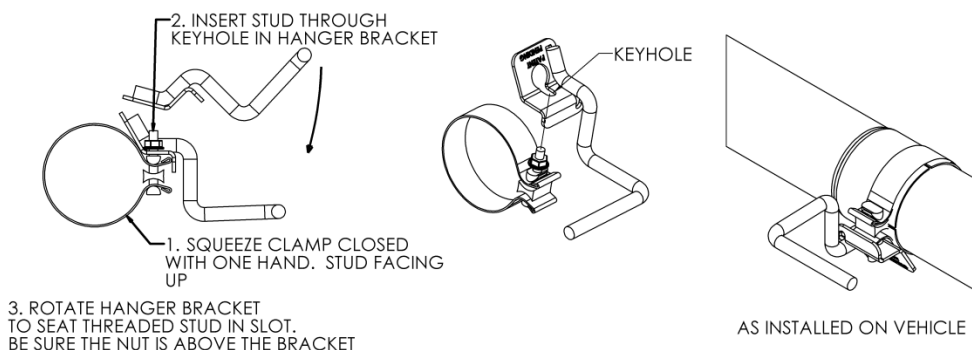

MBRP



Figure 5

4. Slide a **3" Band Clamp** over the **Front Pipe** and install the **Extension Pipe** onto the **Front Pipe**. Install the shorter of the previously assembled **Hang Tight™ Hanger** clamp assemblies loosely onto the **Extension Pipe** (or **Front Pipe** if the **Extension Pipe** is not required) and place the hanger into the existing rubber isolator. **Refer to Figure 5.**

5. Slide the **Muffler** onto the **Extension Pipe** or **Front Pipe** as required. Loosely install the second **Hang Tight™ Hanger** clamp assembly (long hanger) for support. **Refer to Figure 6.**



Figure 6

6. Loosely install the **Turn Down** connecting it to the **Muffler** outlet through the **Hang Tight™ Hanger** clamp. Install the hanger into the rubber isolator located above the **Turn Down**. **Refer to Figure 7.**

7. Align the exhaust as required. Starting at the front of the exhaust tighten all clamps and connections.

8. Check along the whole length of the exhaust system to ensure that there is adequate clearance around the spare tire, fuel and brake lines or any wiring. If any interference is detected relocate or adjust.



Figure 7



Congratulations! You are ready to begin experiencing the improved power, sound and driving excitement of your **MBRP** performance exhaust system. We know you will enjoy your purchase.