

S5302

2007-2009 TOYOTA TUNDRA, 4.7L,
2007-2008 TOYOTA TUNDRA 5.7L, DOUBLE
CAB (6.5' BOX) / CREW MAX (5.5' BED), 2.5"
DUAL SPLIT REAR EXIT

MBRP®

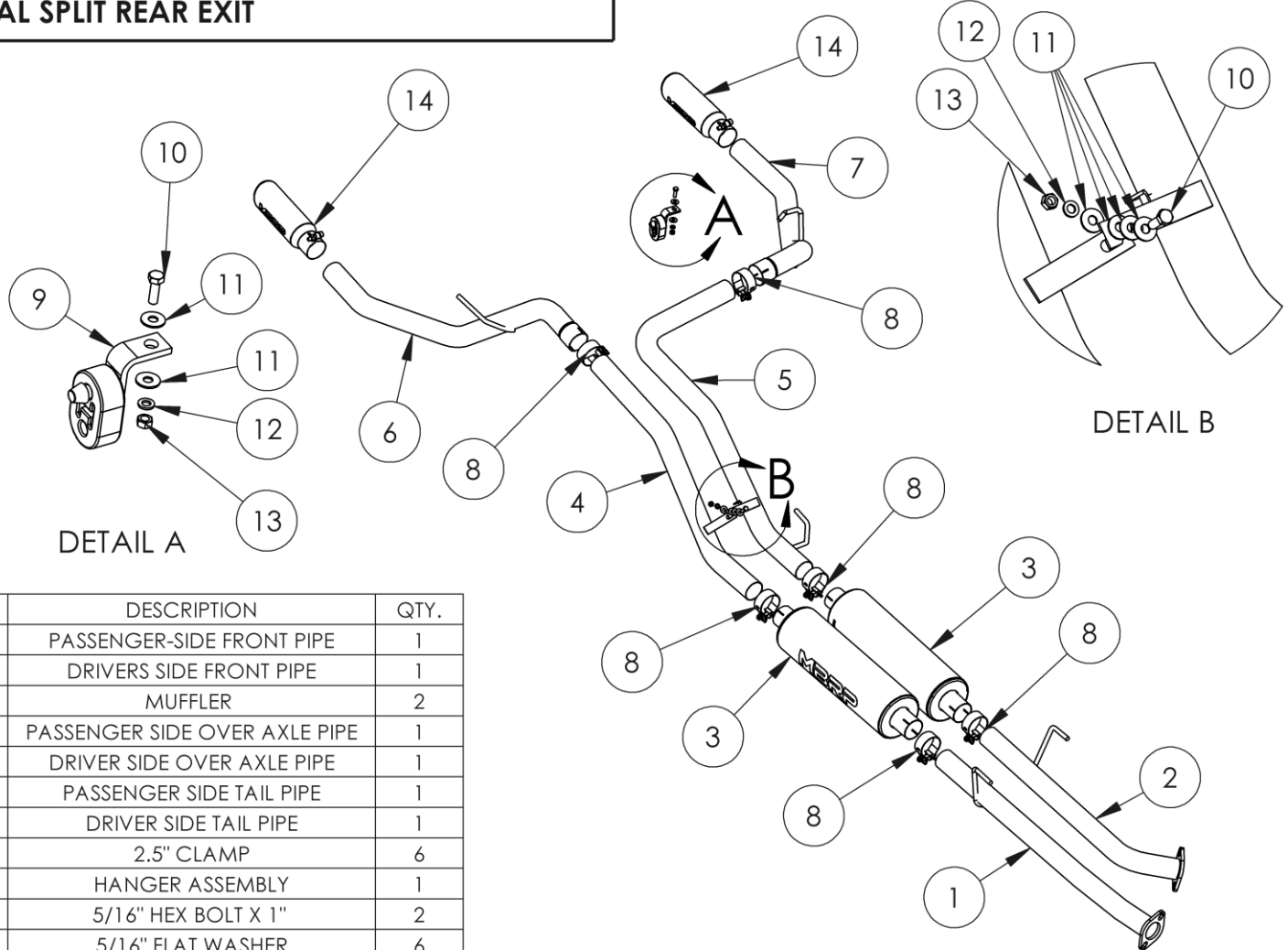

ITEM	DESCRIPTION	QTY.
1	PASSENGER-SIDE FRONT PIPE	1
2	DRIVERS SIDE FRONT PIPE	1
3	MUFFLER	2
4	PASSENGER SIDE OVER AXLE PIPE	1
5	DRIVER SIDE OVER AXLE PIPE	1
6	PASSENGER SIDE TAIL PIPE	1
7	DRIVER SIDE TAIL PIPE	1
8	2.5" CLAMP	6
9	HANGER ASSEMBLY	1
10	5/16" HEX BOLT X 1"	2
11	5/16" FLAT WASHER	6
12	5/16" LOCK WASHER	2
13	5/16" HEX NUT	2
14	EXHAUST TIP	2

PLEASE READ BEFORE STARTING INSTALLATION

While MBRP has made every effort to ensure that all components of this system are of superior quality and properly packaged, it is the installer's responsibility to ensure the following before removal of the factory exhaust:

- that ALL components shown above are present.
- that ALL mating components fit together.
- that there are no damaged components.
- that the system you have purchased is appropriate for your vehicle year, model and configuration.
- that the system will not interfere with any modifications previously installed or planned.
- that you have read and understand these instructions.

If you have any questions or are uncertain about any aspect of the installation of this system to your vehicle please contact your dealer before commencing installation.

MBRP®

Removal of Stock System:



Figure 1

1. Apply a penetrating lubricant liberally to all exhaust fasteners, hangers and rubber insulators.



Figure 2

2. Remove hardware from stock extension pipes. Keep for reinstallation. **Refer to Figure 1.**

3. Remove exhaust from rubber insulators. **Refer to Figure 2.**

4. Remove the exhaust from the rearmost hanger. Leave the rubber insulators on the truck for installation. **Refer to Figure 3.**



Figure 3

Installation of MBRP Performance Exhaust:

1. Install the **Driver Side Front Pipe** reusing the existing hardware and attaching the hanger to the existing rubber insulator. Leave the hardware loose enough for some adjustment. **Refer to Figure 4.**



Figure 4

2. Install the **Passenger Side Front Pipe** reusing the existing hardware. Leave the hardware loose enough for some adjustment. **Refer to Figure 5.**

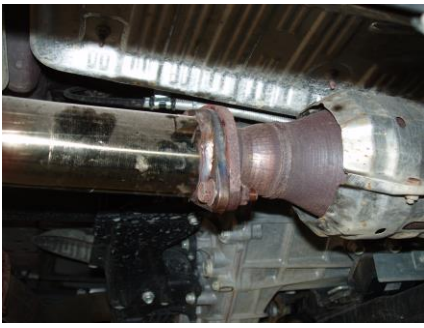

Figure 5

3. Slide **2.5" Clamps** over the **Passenger Side Front Pipe** and the **Driver Side Front Pipe**. Install the **Mufflers** onto the **Driver Side Front Pipe** and then the **Passenger Side Front Pipe**. Refer to **Figure 6**.



Figure 6

4. Slide a **2.5" Clamp** over the outlet side of the driver's side **Muffler**. Position the **Driver Side Over Axle Pipe** and loosely attach it to the **Muffler**. Install the **Driver Side Over Axle Pipe** hanger into the factory rubber insulator. Refer to **Figure 7**.



Figure 7

5. Slide a **2.5" Clamp** over the **Driver Side Tail Pipe** and install onto the **Driver Side Over Axle Pipe**. Install the **Hanger Assembly** onto the **Driver Side Tail Pipe** and install to the frame using the fastener provided. Refer to **Figures 8, 9 and Detail A on Page 1**.



Figure 8

6. Slide a **2.5" Clamp** over the outlet of the passenger side **Muffler**. Position the **Passenger Side Over Axle Pipe** over the axle and loosely attach it to the **Muffler**. Loosely attach to the **Driver Side Over Axle Pipe** using hardware provided. Refer to **Figure 10**.
Note, additional **5/16" Flat Washers** are provided in case spacing is required for adjustments.



Figure 9

7. Slide the **Passenger Side Tail Pipe** onto the **Passenger Side Over Axle Pipe** installing the hanger to the existing rubber insulator. Refer to **Figure 11**.

MBRP[®]



Figure 10

8. Install and adjust the **Exhaust Tips** to suit. Tighten the lock bolt located on each **Exhaust Tip**.



Figure 11

9. Tighten all hardware and clamps, starting at the front and working rearward to secure the system. Check along the full length of the exhaust system to ensure there is adequate clearance for fuel lines, vent lines, brake lines, frame, bodywork, suspension and any wiring, etc. If there is any interference detected, relocate or adjust to provide adequate clearance. Ensure all clamp connections are secure and components are unable to rotate or slide. Band clamps require approximately 45 lb-ft (60 N-m) of torque. Verify clearances, system security and band clamp torque after 30-60 miles (50-100 km) of driving.



Congratulations! You are ready to begin enjoying the improved performance and driving experience of your **MBRP** Performance Exhaust system. We hope you enjoy your purchase!