

S5506

2007-08 JEEP COMPASS / PATRIOT AWD
2.4L CAT BACK SINGLE REAR EXIT

MBRP
INC.
PERFORMANCE EXHAUST

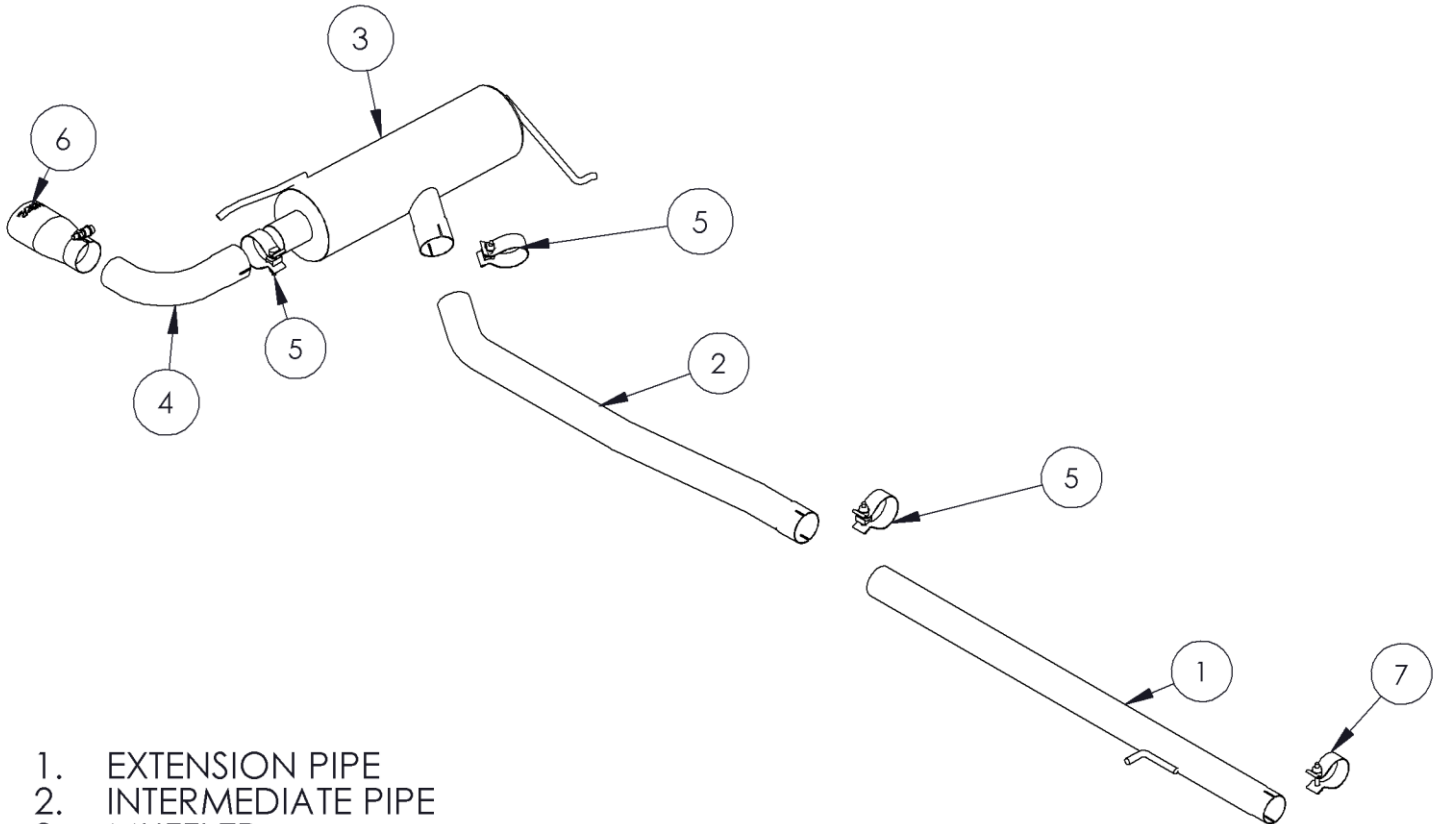

1. EXTENSION PIPE
2. INTERMEDIATE PIPE
3. MUFFLER
4. TAIL PIPE
5. 2 1/2" BAND CLAMP (3PCS)
6. 304 STAINLESS TIP
7. 2 1/4" CLAMP

NOTE: SADDLE CLAMPS ARE USED IN ALUMINIZED SYSTEMS

PLEASE READ BEFORE STARTING INSTALLATION

While MBRP Inc. has made every effort to ensure that all components of this system are of superior quality and properly packaged, it is the installer's responsibility to ensure the following before removal of the factory exhaust:

- that ALL components shown above are present.
- that ALL mating components fit together.
- that there are no damaged components.
- that the system you have purchased is appropriate for your vehicle year, model and configuration.
- that the system will not interfere with any modifications previously installed or planned.
- that you have read and understand these instructions.

If you have any questions or are uncertain about any aspect of the installation of this system to your vehicle please contact your dealer before commencing installation.

2007-2008 JEEP COMPASS/ PATRIOT AWD 2.4L

Removal of Stock System:



Figure 1

1. Apply a penetrating lubricant liberally to all exhaust fasteners, hangers and rubber insulators.

2. Begin by loosening the clamp just after the catalytic converter. **Refer to Figure 1.**

3. The exhaust can be removed from the vehicle by sliding the hangers from the rubber isolators, one on each side.

Refer to Figures 2 & 3.



Figure 2

Installation of MBRP Inc. Performance Exhaust

1. Install the **Extension Pipe** using a **2 ¼" Clamp** and attaching it to the existing rubber isolator. Leave the clamp loose enough for some adjustment. **Refer to Figure 4.**



Figure 3



Figure 4



Figure 5

2. Slide a 2 ¼” **Clamp** over the **Extension Pipe** and then install the **Intermediate Pipe** to the **Extension Pipe**. Leave the 2 1/4”**Clamp** loose enough for adjustment. **Refer to Figure 5.**



Figure 6

3. Slide a 2 ¼” **Clamp** onto the **Intermediate Pipe** and then install the **Muffler** to the **Intermediate Pipe**. The **Muffler** hanger fits into the factory rubber insulator. **Refer to Figure 7.**



Figure 7

4. Slide the 2 ½”**Clamp** over the **Tail Pipe** and install onto the **Muffler**. Adjust the **Tail Pipe** to leave a ½” minimum gap from the bumper fascia. **Refer to Figure 8.**

5. Align the exhaust as required. Starting at the front of the exhaust, tighten all clamps and connections.

6. Check along the whole length of the exhaust system to ensure that there is adequate clearance around the spare tire, fuel and brake lines or any wiring. If any interference is detected relocate or adjust.



Figure 8



Congratulations! You are ready to begin experiencing the improved power, sound and driving experience of your MBRP Inc. performance exhaust system. We know you will enjoy your purchase.