

S6005

2001-2004 CHEV/GMC 2500/3500,
EXTENDED CAB/CREW CAB,
6.6L DURAMAX, CAT-BACK, 4.0" SINGLE SIDE

MBRP®

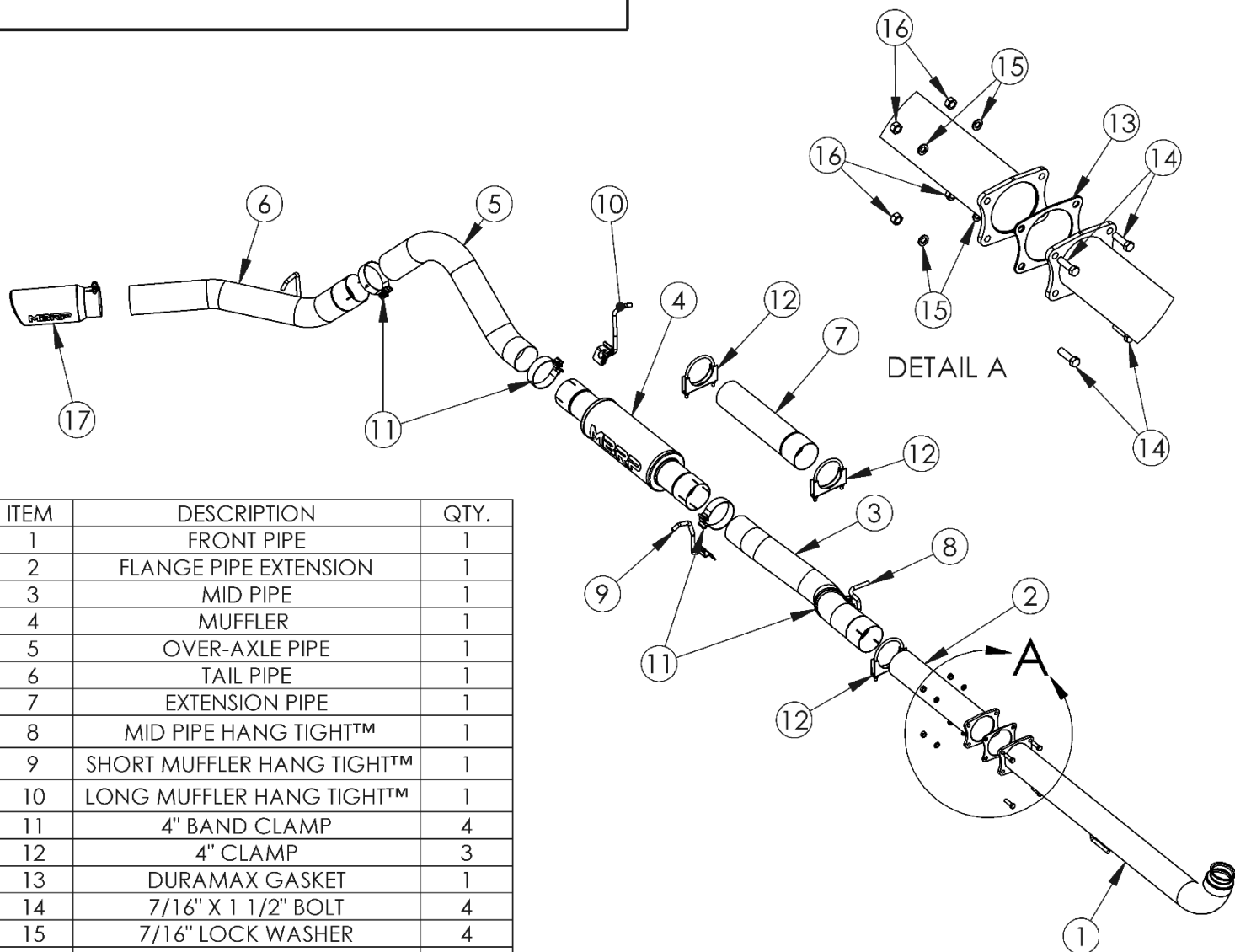

ITEM	DESCRIPTION	QTY.
1	FRONT PIPE	1
2	FLANGE PIPE EXTENSION	1
3	MID PIPE	1
4	MUFFLER	1
5	OVER-AXLE PIPE	1
6	TAIL PIPE	1
7	EXTENSION PIPE	1
8	MID PIPE HANG TIGHT™	1
9	SHORT MUFFLER HANG TIGHT™	1
10	LONG MUFFLER HANG TIGHT™	1
11	4" BAND CLAMP	4
12	4" CLAMP	3
13	DURAMAX GASKET	1
14	7/16" X 1 1/2" BOLT	4
15	7/16" LOCK WASHER	4
16	7/16" NUT	4
17	EXHAUST TIP	1

PLEASE READ BEFORE STARTING INSTALLATION

While MBRP has made every effort to ensure that all components of this system are of superior quality and properly packaged, it is the installer's responsibility to ensure the following before removal of the factory exhaust:

- that ALL components shown above are present.
- that ALL mating components fit together.
- that there are no damaged components.
- that the system you have purchased is appropriate for your vehicle year, model and configuration.
- that the system will not interfere with any modifications previously installed or planned.
- that you have read and understand these instructions.

If you have any questions or are uncertain about any aspect of the installation of this system to your vehicle please contact your dealer before commencing installation.

MBRP



Figure 1



Figure 2



Figure 3



Figure 4

Removal of Stock System

1. Apply penetrating lubricant liberally to all exhaust fasteners, hangers, and rubber insulators.
2. Disconnect the four-bolt flange located approximately under the passenger seat.

Refer to **Figure 1**.

3. Remove the exhaust system from the rubber insulators and remove from under the vehicle. If a hoist is not available for use it may be necessary to cut the tail pipe behind the muffler for removal of the system.

4. Unbolt the OEM hanger from the transmission and remove. Do not discard the hanger as it is required for the installation.

Refer to **Figure 2**.

5. Loosen the factory band clamp and remove the stock front pipe. Do not discard the band clamp as it is required for the installation.

See **Figure 3**.

Installation of **MBRP** Performance Exhaust

1. Install the **Front Pipe** onto the factory down pipe using the factory band clamp previously removed. Do not fully tighten to allow for adjustment. See **Figure 4**.

2. Install the hanger located on the **Front Pipe** by sliding the outside hole in the rubber insulator and re-connect it to the transmission.

3. Connect the **Flange Pipe Extension** with the **Duramax Gasket** and attach it to the **Front Pipe** using the **7/16" Bolt, Lock Washer and Nut**; do not fully tighten to allow for adjustment. Refer to **Page 1**.

4. The **Flange Pipe Extension** does not require cutting to fit Crew Cab trucks. For extended cab trucks, approximately 9½" needs to be cut off the end of the **Flange Pipe Extension**. (**Installation Tip:** Temporarily hang the **Muffler, Over-Axle Pipe, and Tail Pipe** in place and measure to verify the length required).

Refer to **Page 1** and **Detail A**.

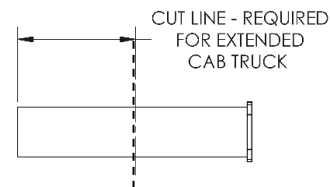

Detail A

MBRP



Figure 5

(Hang Tight™ may not be as shown)

5. Position the **Mid Pipe** bend around & under the cross member. Rotate the pipe to position the bend toward the driveshaft.
See **Figure 5**.

6. After positioning the **Mid Pipe** as shown, loosely install the **Mid Pipe Hang Tight™** this will support the **Flange Pipe Extension** during the **Muffler** installation. (See Detail B for Hang Tight instructions and Figure 9 for hanger clarification).



Figure 6

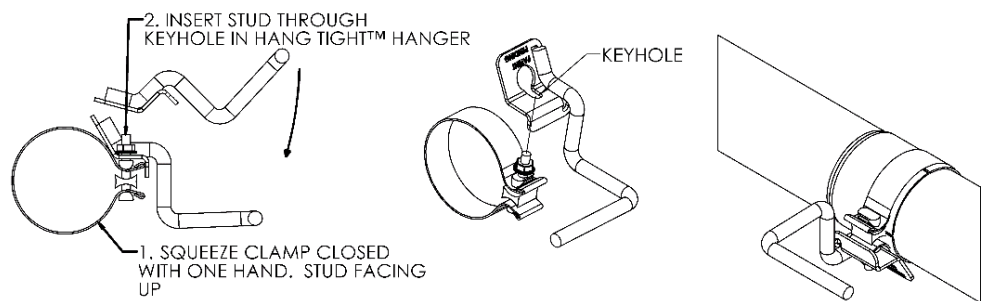

3. ROTATE HANG TIGHT™ HANGER TO SEAT THREADED STUD IN SLOT. BE SURE THE NUT IS ABOVE THE BRACKET

Detail B

AS INSTALLED ON VEHICLE



Figure 7

7. Crew Cab & Extended Cab long box trucks require the use of the **18” Extension Pipe** provided. This is to be positioned between the **Muffler** and the **Mid Pipe**.

Note: The **18” Extension Pipe** is **NOT** required with short box trucks.
Refer to **Page 1**.

8. Install the **Muffler** on the **Extension Pipe** or **Mid Pipe** along with the **Short Muffler Hang Tight™**.

9. Install the **Long Muffler Hang Tight™** at the connection between the **Muffler** and the **Over-Axle Pipe** and into the OEM rubber hanger at this position.
See **Figure 7**.



Figure 8

10. Install the **4” Band Clamp** over the **Tail Pipe** and then install the **Tail Pipe** to the **Over-Axle Pipe**. Install the hanger on the **Tail Pipe** into the OEM hanger, adjust for best axle clearance and **Tail Pipe** location to complete.
See **Figure 8**.

MBRP

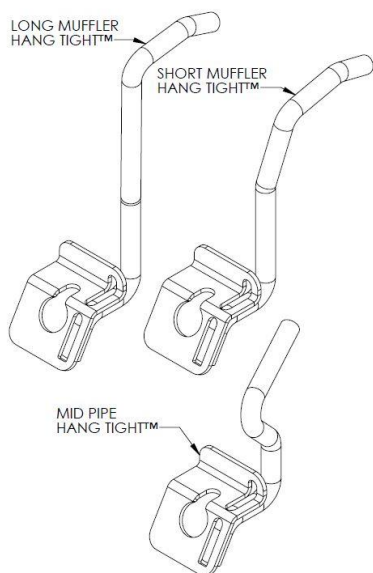

Figure 9

11. Install and adjust the **Exhaust Tip** to suit.

12. Carefully align the system and tip. Align the edge of each band clamp with the edge of the joint it is connecting. Tighten all hardware and clamps, starting at the front and working rearward to secure the system. Check along the full length of the exhaust system to ensure there is adequate clearance for fuel lines, vent lines, brake lines, frame, bodywork, suspension and any wiring, etc. If there is any interference detected, relocate or adjust to provide adequate clearance. Ensure all clamp connections are secure and components are unable to rotate or slide. Band clamps require approximately 45 lb-ft (60 N-m) of torque. Verify clearances, system security and band clamp torque after 30-60 miles (50-100 km) of driving.



Congratulations! You are ready to begin experiencing the improved power, sound and driving experience of your **MBRP** Performance Exhaust.

We know you will enjoy your purchase!