

# S6032

2011-2019 CHEV/GMC 2500/3500,  
6.6L DURAMAX, EC/CC,  
PARTICULATE FILTER BACK, 4" SINGLE SIDE

# MBRP®

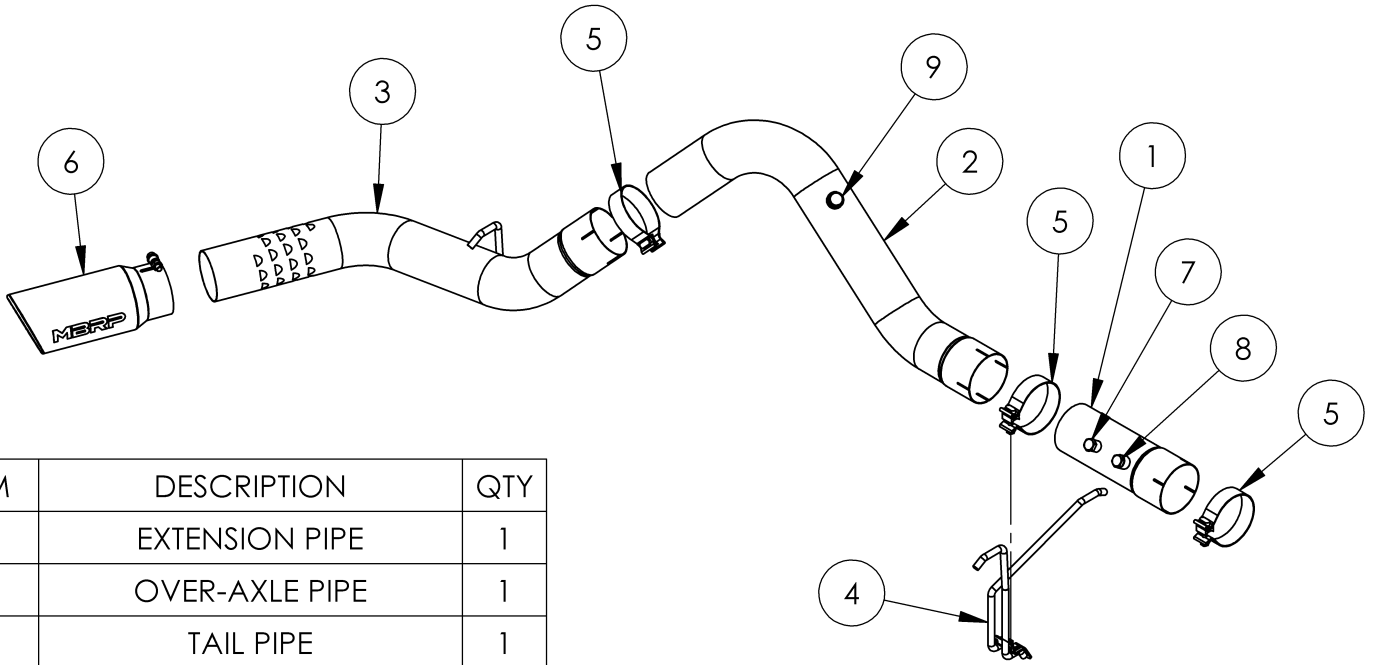

ITEM	DESCRIPTION	QTY
1	EXTENSION PIPE	1
2	OVER-AXLE PIPE	1
3	TAIL PIPE	1
4	HANG TIGHT™ HANGER	1
5	4" BAND CLAMP	3
6	EXHAUST TIP	1
7	M14 PLUG	1
8	M16 PLUG	1
9	M22 PLUG	1

## PLEASE READ BEFORE STARTING INSTALLATION

While MBRP has made every effort to ensure that all components of this system are of superior quality and properly packaged, it is the installer's responsibility to ensure the following before removal of the factory exhaust:

- that ALL components shown above are present.
- that ALL mating components fit together.
- that there are no damaged components.
- that the system you have purchased is appropriate for your vehicle year, model and configuration.
- that the system will not interfere with any modifications previously installed or planned.
- that you have read and understand these instructions.

If you have any questions or are uncertain about any aspect of the installation of this system to your vehicle please contact your dealer before commencing installation.

# MBRP

## Removal of Stock System



Figure 1



Figure 2

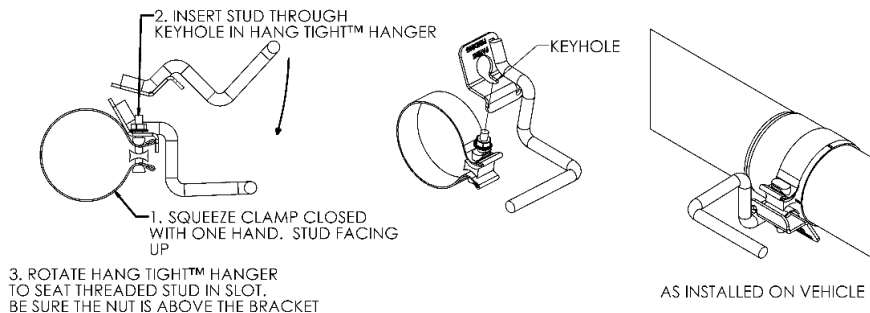

Figure 3

1. Apply a penetrating lubricant liberally to all hangers and rubber insulators.
2. Mark a cut line 2.75" for 2011-2016 models, 5.375" for 2017+ models in front of the hanger in behind of the rear axle on the factory system.
3. Disconnect and remove any sensors located in the section of the factory exhaust being removed. Retain these sensors as they will be reused. Note; sensors are on 2016+ trucks only.
4. Verify the cut line. It should be approximately 24" for 2011-2016 models, 24.5" for 2017+ models from the front of the axle tube. You can also leave the factory pipe long and line up the supplied Over-Axle Pipe expansion before making the final cut. Cut the factory pipe at the cut line. **Refer to Figure 1.**
5. Unhook the three factory rubber insulators from the exhaust and remove the factory pipe.

## Installation of MBRP Performance Exhaust

1. Install the **Hang Tight™** onto a **Clamp** using the procedure shown below. Snug up the nut to keep the bracket from falling out. (Hang Tight™ hanger not exactly as shown)



2. Place a **Clamp** over the factory extension pipe and install the **Extension Pipe** over the factory extension pipe. On 2016 and newer vehicles ensure the sensor bungs are aligned to allow sensor installation.

**Refer to Figure 2.**

3. Using the hanger assembly from Step 1, install the **Over-Axle Pipe** onto the **Extension Pipe** and install the hangers into the factory insulators.
4. Place a **Clamp** on the inlet of the **Tailpipe** and install it onto the **Over Axle Pipe**.

# MBRP

5. Install **Tailpipe** hanger into factory rubber hanger.  
**Refer to Figure 3.**

6. Install the **Tip** and adjust to your liking.

7. Once everything is aligned, completely tighten all **Clamps**.

8. Remove threaded Plugs in **Over-Axle Pipe** and **Extension Pipe** and Reinstall any sensors previously removed. Note; 2011-15 trucks use no sensors, 2016 uses one sensor, 2017+ uses 3 sensors.

9. Check along the whole length of the exhaust system to ensure that there is adequate clearance around the spare tire, fuel and brake lines or any wiring. If any interference is detected relocate or adjust.

10. Carefully align the system and tip. Align the edge of each band clamp with the edge of the joint it is connecting. Tighten all hardware and clamps, starting at the front and working rearward to secure the system. Check along the full length of the exhaust system to ensure there is adequate clearance for fuel lines, vent lines, brake lines, frame, bodywork, suspension, and any wiring, etc. If there is any interference detected, relocate, or adjust to provide adequate clearance. Ensure all clamp connections are secure and components are unable to rotate or slide. Band clamps require approximately 45 lb-ft (60 N-m) of torque. Verify clearances, system security and band clamp torque after 30-60 miles (50-100 km) of driving.

**Congratulations!** You are ready to begin experiencing the improved power, sound and driving experience of your **MBRP** performance exhaust system. We know you will enjoy your purchase.