

S6039

CHEV/GMC 2016, 2500/3500 DURAMAX
ALL LML, PARTICULATE FILTER BACK, 4"
SINGLE SIDE

MBRP
INC.
PERFORMANCE EXHAUST

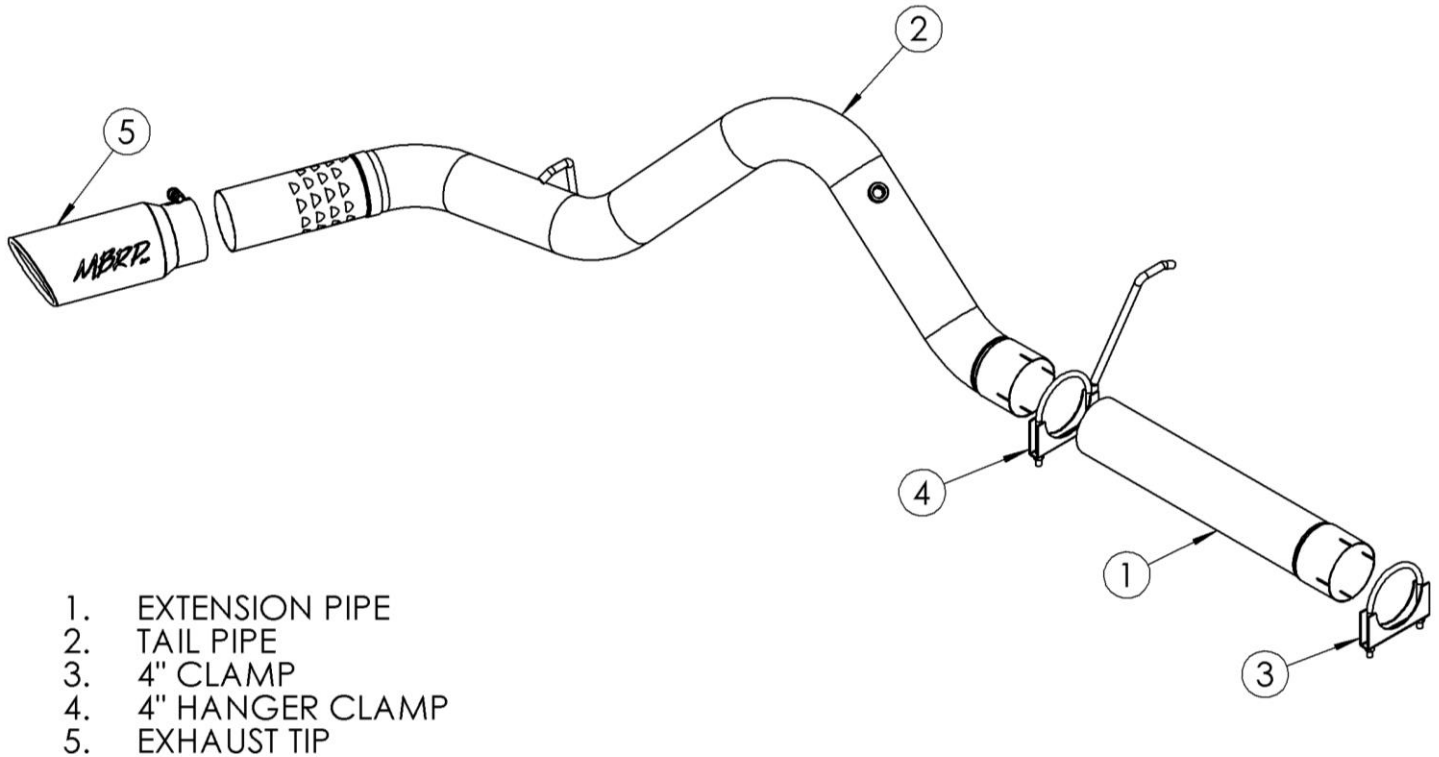

PLEASE READ BEFORE STARTING INSTALLATION

While MBRP Inc. has made every effort to ensure that all components of this system are of superior quality and properly packaged, it is the installer's responsibility to ensure the following before removal of the factory exhaust:

- that ALL components shown above are present.
- that ALL mating components fit together.
- that there are no damaged components.
- that the system you have purchased is appropriate for your vehicle year, model and configuration.
- that the system will not interfere with any modifications previously installed or planned.
- that you have read and understand these instructions.

If you have any questions or are uncertain about any aspect of the installation of this system to your vehicle please contact your dealer before commencing installation.

Removal of Stock System:



Figure 1

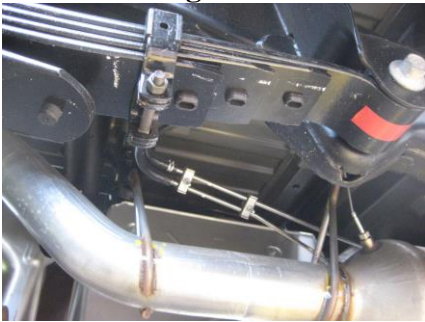

Figure 2



Figure 3

1. Apply a penetrating lubricant liberally to all exhaust fasteners, hangers and rubber isolators.
2. Remove temperature sensor from tail pipe. Some models may be equipped with a plug in place of a sensor. **Do not discard plug as it is required for installation.**
Refer to Figure 1.
3. Refer to the illustration in **Figure 4** and the chart below to determine where to cut the existing exhaust rear of the particulate filter.

Cab Style	Box Style	Wheelbase	Dimension A	Extension Pipe Cut Length
CREW	8' 2"	167.7"	13"	23"
CREW	6' 6"	154.2"	6.5"	17"
EXTENDED	8' 2"	157.7"	13"	23"
EXTENDED	6' 5"	144.2"	5.5"	15.5"

4. Remove the factory tail pipe assembly from the factory rubber isolators.
Remove the tail section from the vehicle.
Refer to Figures 2 & 3.

Installation of MBRP Inc. Performance Exhaust:

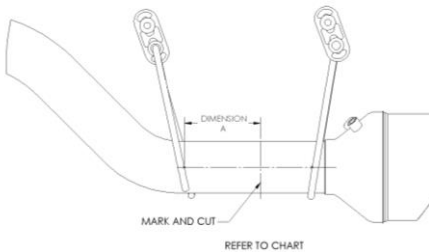

Figure 4

1. The **Extension Pipe** provided is the proper length for the Crew Cab Long Box and the Extended Cab Long Box. For all other models the **Extension Pipe** will need to be shortened. Slide the **4" Clamp** onto the **Extension Pipe** and install behind the particulate filter.

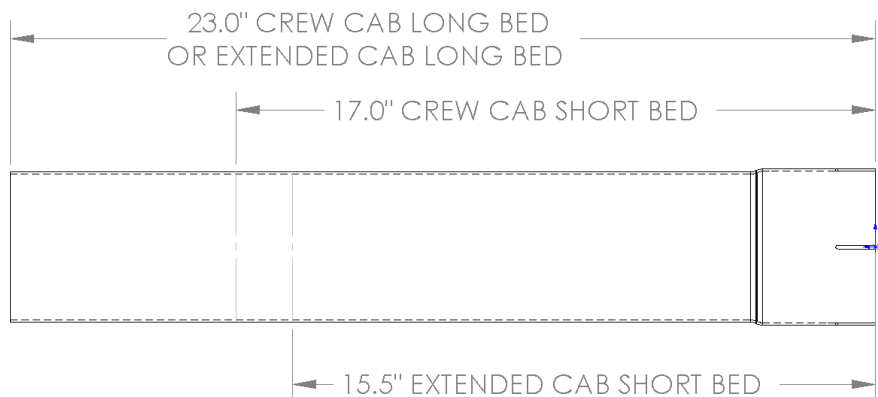

Figure 6



Figure 5



Figure 7

2. Use the **4" Hanger Clamp** to install the **Tail Pipe** to the **Extension Pipe**. Refer to **Figure 7**.



Figure 8

3. Install the Tail Pipe hanger into the factory rubber insulator. Refer to **Figures 8**.

4. Fasten temperature sensor or plug in the bung on the **Tail Pipe**.

5. Install and adjust the **Tip** to your preference. Secure the **Tip** by tightening the lock bolts.



Figure 9

6. Align the **Tail Pipe** and tighten **Clamps** starting at the front and working rearward to secure the system.

7. Check along the full length of the exhaust system to ensure there is adequate clearance for fuel lines, break lines, and any wiring, etc. If there is any interference detected, relocate or adjust to provide adequate clearance.

Congratulations! You are ready to begin experiencing the improved driving pleasure of your MBRP Inc. performance exhaust system. We know you will enjoy your purchase.