

S6202

1999-2003 FORD F250/350, 7.3L POWERSTROKE,
TURBO BACK, 4", DUAL SPLIT SIDE,
NOT FOR USE ON VEHICLES EQUIPPED WITH
CATALYTIC CONVERTER

MBRP®

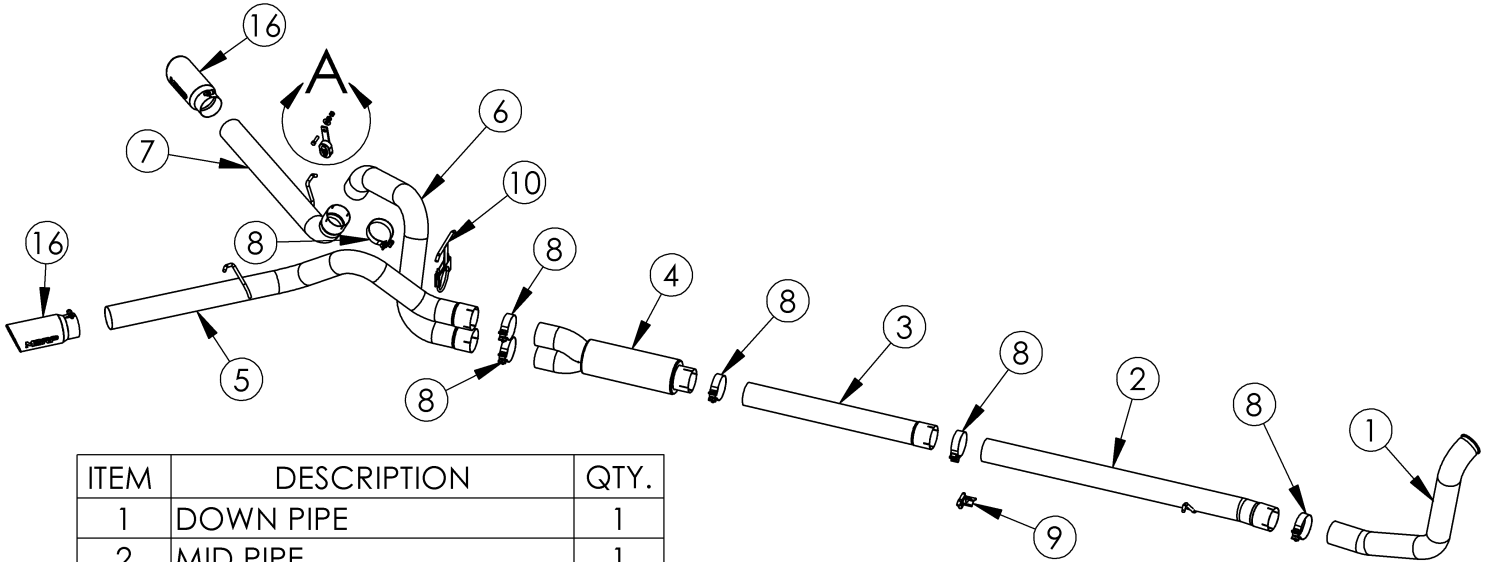

ITEM	DESCRIPTION	QTY.
1	DOWN PIPE	1
2	MID PIPE	1
3	EXTENSION PIPE	1
4	MUFFLER	1
5	PASSENGER-SIDE TAIL PIPE	1
6	OVER-AXLE PIPE	1
7	DRIVER-SIDE TAIL PIPE	1
8	4" BAND CLAMP	6
9	HANG TIGHT™ HANGER	1
10	4" T-HANGER CLAMP	1
11	HANGER ASSEMBLY	1
12	7/16" X 1 1/2" BOLT	1
13	7/16" FLAT WASHER	1
14	7/16" LOCK WASHER	1
15	7/16" NUT	1
16	EXHAUST TIP	2

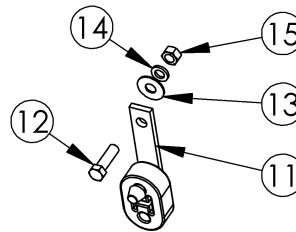

DETAIL A
SCALE 1 : 8

PLEASE READ BEFORE STARTING INSTALLATION

While MBRP has made every effort to ensure that all components of this system are of superior quality and properly packaged, it is the installer's responsibility to ensure the following before removal of the factory exhaust:

- that ALL components shown above are present.
- that ALL mating components fit together.
- that there are no damaged components.
- that the system you have purchased is appropriate for your vehicle year, model and configuration.
- that the system will not interfere with any modifications previously installed or planned.
- that you have read and understand these instructions.

If you have any questions or are uncertain about any aspect of the installation of this system to your vehicle please contact your dealer before commencing installation.

MBRP

Removal of Stock System:

1. If a hoist is being used for the installation, the original exhaust system can be removed in one piece by removing the passenger side shock. If a hoist is not being used the tail pipe must be cut behind the muffler to be removed.
2. Loosen the nut on the band clamp in front of muffler using a 15mm socket.
3. Remove the muffler and tail pipe from the OEM rubber hangers and separate the stock exhaust at the slip joint remove the muffler and tail pipe from under the truck. **Re-install the passenger side shock.**
4. Remove the down pipe from the turbo by removing the band clamp using an 11mm socket. **Retain the band clamp for the installation of the new down pipe.** Cut the down pipe in front of the transmission cross member to remove. (**Note:** The stock down pipe can be removed in one piece by removing the transmission cross member. It is recommended that this only be done by qualified, trained professionals using tools and equipment designed to safely carry out this procedure.)

Installation of MBRP Performance Exhaust:

Note: Vehicles originally equipped with a catalytic converter must retain the factory catalytic converter. Removal of the catalytic converter may be a violation of federal or local regulations.

1. Install the **Down Pipe** in the same position as the stock down pipe and attach the flared end to the turbo using the stock band clamp. Do not fully tighten until all components are in place.
2. Slide a **4" Band Clamp** over the **Mid Pipe** and attach to **Down Pipe** and place the hanger into the factory rubber insulator located on the frame.
3. Install the **Hang Tight™ Hangers** onto **4.0" Band Clamp** using the procedure shown below. (Hang Tight™ Hanger not exactly as shown).

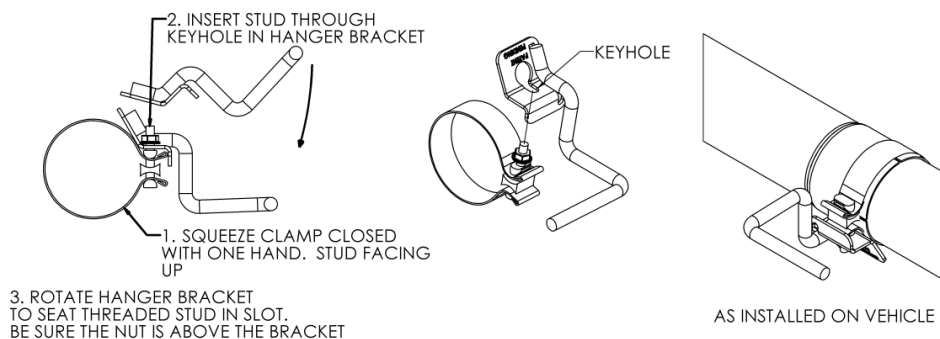

4. Slide the **Hang Tight™ Hanger Clamp Assembly** over the **Extension Pipe** and attach to the **Mid Pipe**. The **Extension Pipe** is pre-cut to fit vehicles with a 172" wheelbase and will have to be cut to fit all other vehicles. 137" wheelbase vehicles do not require the **Extension Pipe** to be installed. The **Hang Tight™ Hanger Clamp** is used at the connection between the **Mid Pipe** and the **Extension Pipe** and is installed into the OEM rubber insulator at this position. **Install tip:** Temporarily install the Muffler and **Tail Pipe** using the factory rubber insulators and the **T-Hanger Clamp**. Measure from the **Muffler** to the **Mid Pipe** and cut the **Extension Pipe** to the required length.

MBRP

5. Slide a **4" Band Clamp** over the single inlet of the **Muffler** and attach to **Extension Pipe** or to the **Mid Pipe** with the 137" wheelbase vehicles. The **Muffler** outlets will be positioned vertically when installed. Slide **4" Band Clamps** onto each **Muffler** outlet.
6. Install the **Over-Axle Pipe** to the lower outlet of the **Muffler** and position the **4" Band Clamp** accordingly over the pipe expansion. Do not tighten. Install the **T-Hanger Clamp** into the OEM rubber insulators located above the **Muffler** outlets.
7. Install the **Passenger-Side Tail Pipe** from the rear of the truck, over the axle passing through the **T-Hanger Clamp** and attach to the upper outlet of the **Muffler**. Install the tail pipe hanger into the OEM rubber insulator to complete the passenger side.
8. Install the **Driver-Side Tail Pipe** onto the **Over-Axle Pipe** with the remaining **4" Band Clamp**. Install the **Driver-Side Tail Pipe** Hanger into the OEM rubber insulator. Adjust both tail pipes for optimal position and clearance.
9. Install the **Exhaust Tips** to suit using a 17mm wrench to tighten lock bolt located on the **Exhaust Tip**.
10. Tighten all hardware and clamps, starting at the front and working rearward to secure the system. Check along the full length of the exhaust system to ensure there is adequate clearance for fuel lines, vent lines, brake lines, frame, bodywork, suspension, and any wiring, etc. If there is any interference detected, relocate, or adjust to provide adequate clearance. Ensure all clamp connections are secure and components are unable to rotate or slide. Band clamps require approximately 45 lb-ft (60 N-m) of torque. Verify clearances, system security and band clamp torque after 30-60 miles (50-100 km) of driving.

Congratulations! You are ready to begin experiencing the improved power, sound and driving excitement of your **MBRP** Performance Exhaust system. We know you will enjoy your purchase.