

S6246AL

'08-'10 FORD SUPER DUTY 6.4L
POWERSTROKE DIESEL, PARTICULATE FILTER
BACK, 5" SINGLE SIDE

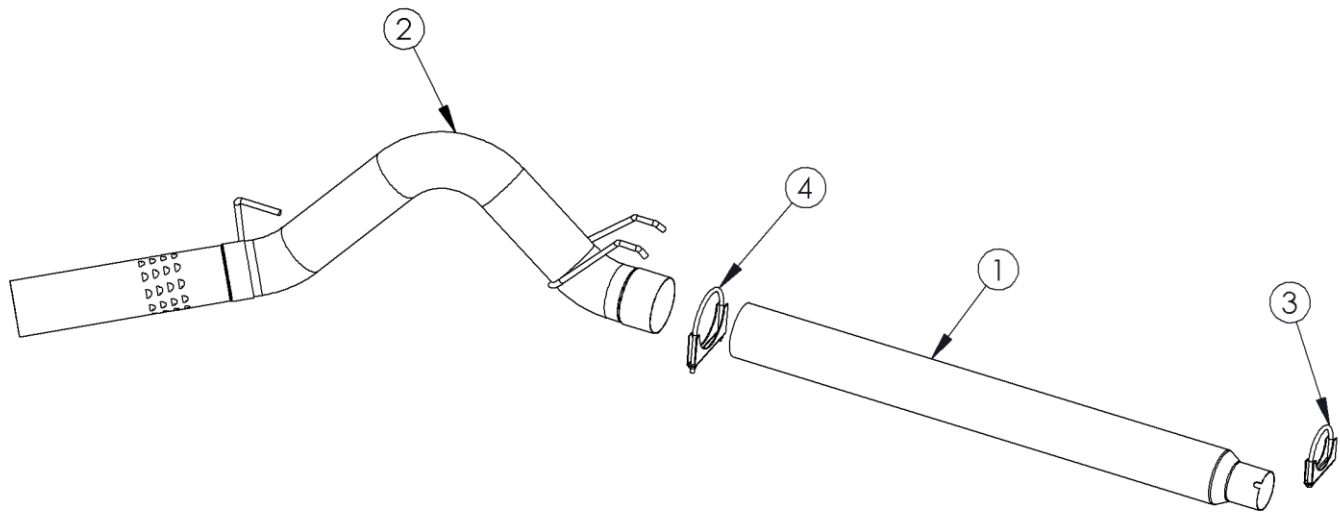

1. 3.5" TO 5" EXTENSION PIPE
2. TAIL PIPE
3. 3.5" CLAMP
4. 5" CLAMP

PLEASE READ BEFORE STARTING INSTALLATION

While MBRP Inc. has made every effort to ensure that all components of this system are of superior quality and properly packaged, it is the installer's responsibility to ensure the following before removal of the factory exhaust:

- that ALL components shown above are present.
- that ALL mating components fit together.
- that there are no damaged components.
- that the system you have purchased is appropriate for your vehicle year, model and configuration.
- that the system will not interfere with any modifications previously installed or planned.
- that you have read and understand these instructions.

If you have any questions or are uncertain about any aspect of the installation of this system to your vehicle please contact your dealer before commencing installation.



2008 Ford Super Duty 6.4L Powerstroke Diesel

Extended Cab Short & Long Bed, Crew Cab Short & Long Bed

Removal of stock system:



Figure 1

1. Apply a penetrating lubricant liberally to all exhaust fasteners, hangers and rubber insulators.

2. Loosen the nut on the band clamp located behind the particulate filter using a 15mm wrench or socket.

Refer to Figure 1.

3. Cut the exhaust as shown in **Figure 2**. Remove the muffler and tail pipe from the OEM rubber insulators. Remove from the vehicle.



Figure 2

Installation of MBRP Inc. Performance Exhaust:

1. The **Extension Pipe** provided is pre-cut for the crew cab long bed configuration. Cut **Extension Pipe** to length if required for the vehicle being installed to. **Refer to Figure 3** for measurements.

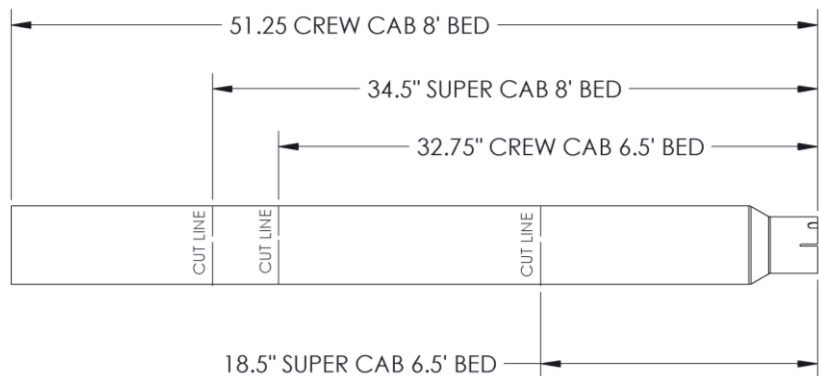

Figure 3



Figure 4



Figure 5

2. Slide the **3.5" Band Clamp** over the **Extension Pipe** and install to the particulate filter. **Refer to Figure 4.**

3. Slide the **5" Band Clamp** onto the end of the **Extension Pipe**. Install the **Tail Pipe** onto the **Extension Pipe**. Install the **Tail Pipe** hangers into the OEM rubber insulators. The clamp should remain loose enough for adjustability. **Refer to Figure 5.**

4. Align the exhaust as required. Starting at the front of the exhaust, tighten all clamps and connections.

5. Check along the whole length of the exhaust system to ensure that there is adequate clearance around the spare tire, fuel and brake lines or any wiring. If any interference is detected relocate or adjust.



Congratulations! You are ready to begin experiencing the improved power, sound and driving experience of your MBRP Inc. performance exhaust system. We hope you enjoy your purchase.

(Note: Ask your dealer about our selection of optional tips or visit us at www.mbrp.com.)