

S8002409

**07-10 GM DURAMAX EC/CC-SB FILTER
BACK SMOKERS™ SINGLE**

MBRP
INC.

PERFORMANCE EXHAUST

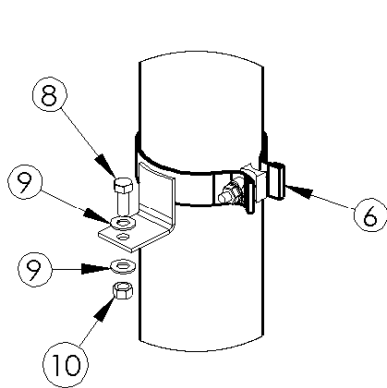

DETAIL 'A'

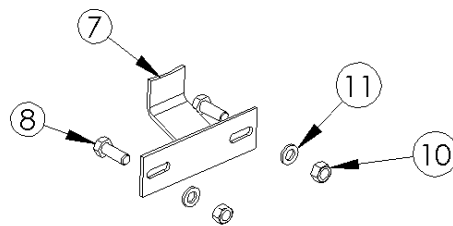

DETAIL 'B'
(SHOWN EXPLODED)

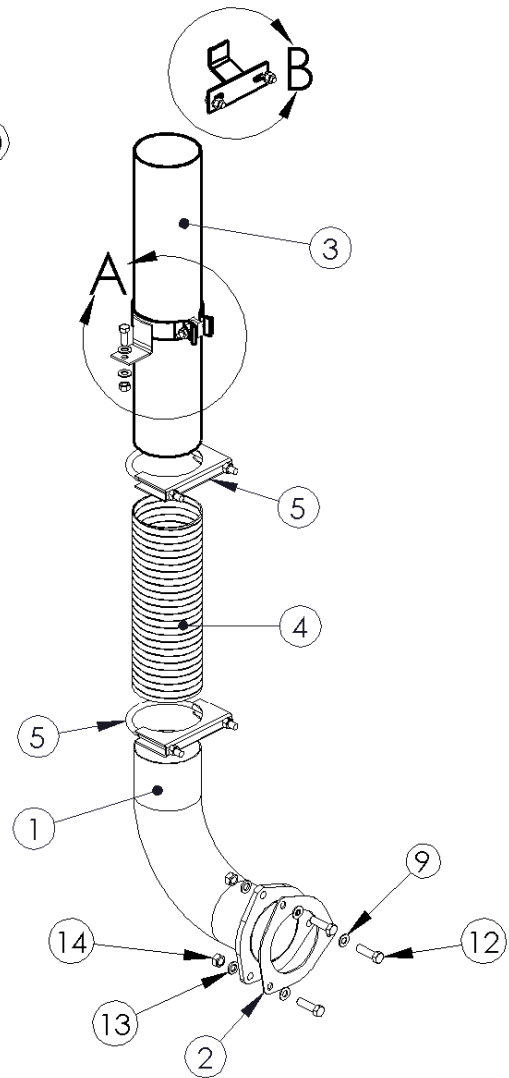

1. ELBOW ASSEMBLY
2. GASKET
3. EXTENSION PIPE
4. FLEX PIPE
5. 4" CLAMP [2 PCS]
6. BED FLOOR CLAMP
7. STACK MOUNTING BRACKET
8. 3/8"x 1" HEX BOLT [3 PCS]
9. 3/8" FLAT WASHER [5 PCS]
10. 3/8" HEX NUT [3 PCS]
11. 3/8" LOCK WASHER [2 PCS]
12. 7/16"x1.5" HEX BOLT [3 PCS]
13. 7/16" LOCK WASHER [3 PCS]
14. 7/16" HEX NUT [3 PCS]

NOTE: STACK SOLD SEPARATELY

PLEASE READ BEFORE STARTING INSTALLATION

While MBRP Inc. has made every effort to ensure that all components of this system are of superior quality and properly packaged it is the installer's responsibility to ensure the following before removal of the factory exhaust:

- that ALL components shown above are present.
- that ALL mating components fit together.
- that there are no damaged components.
- that the system you have purchased is appropriate for your vehicle year, model and configuration.
- that the system will not interfere with any modifications previously installed or planned.
- that you have read and understand these instructions.

If you have any questions or are uncertain about any aspect of the installation of this system to your vehicle please contact your dealer before commencing installation.

Removal of Stock System:



Figure 1

1. Apply a penetrating lubricant liberally to all exhaust fasteners, hangers and rubber insulators.



Figure 2

2. Remove the factory tail pipe assembly from the factory rubber isolators. **Refer to Figures 1 and 2.**



Figure 3

3. With the spare tire removed, the muffler/tailpipe assembly can be removed towards the front of the truck in one piece **IF** the rear of the vehicle is supported on the frame by jack stands or on a 2 post hoist [rear axle needs to 'droop']. If you do not have the above resources cut the factory tail pipe as shown and remove the rear section. **Refer to Figure 3.**



Figure 4

4. Remove the three nuts at the muffler inlet flange and remove the muffler. **Refer to Figure 4.**

Installation of MBRP Inc. "Smokers™"



Figure 5

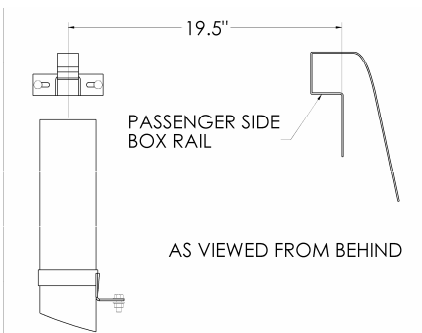

Figure 6



Figure 7



Figure 8

1. Install the supplied **Gasket** onto the outlet of the Diesel Particulate Filter (DPF) followed by the **Elbow Assembly**. Secure with the supplied hardware. **Refer to Figure 5.**

2. Measure 19.5" over from the inside panel of the passenger side of the box. Mark this location along the bed rail. This measurement will be the approximate centerline of the **Stack** once installed. **Refer to Figure 6.**

3. Slide the **Band Clamp** (from **Stack** kit –purchased separately) over the **Stack**. Wedge the **Stack Mounting Bracket** between the **Band Clamp** and **Stack** and adjust to the bed rail height and tighten the **Band Clamp** slightly. Make sure the **Stack** is vertical and the **Stack Mounting Bracket** is flush against the bed rail and centered on the measurement made in Step 2. Trace a circle around the base of the **Stack** and center punch the circle's center. Verify that the center punch hole is in line with the **Elbow Assembly** and adjust accordingly. This will be the center line of your **Stack**.

4. Align the **Stack** centered on the mark you made in Step 2. Mark the bolt hole location of the **Stack Mounting Bracket** onto the front of the bed. Center punch the marks and drill holes to accommodate the **3/8"** hardware. **Refer to Figure 7.**

5. Loosely attach the **Stack Mounting Bracket** to the front of the truck bed using the **3/8"** hardware supplied. Set the **Stack** up in the bed and loosely attach it to the **Stack Mounting Bracket**. Make sure the **Stack** is vertical and in the desired position.

6. Confirm that the base of the **Stack** is resting in the same position as in Step 4. Re-trace and center punch if needed. This is where the **Extension Pipe** will pass through the floor. Remove the **Stack** from the bed of the truck. Drill a hole using a 5" saw. It may be required to cut a part of a bed floor rail away. **Refer to Figure 8.**

7. Install the **Flex Pipe** over the **Elbow Assembly**. Insert the **Extension Pipe** into the **Flex Pipe**. Install the **Bed Floor Clamp** over the **Extension Pipe** ensuring the tab faces down. Install the **Stack** over the **Extension Pipe** and set to the desired height. The **Flex Pipe** must remain below the floor of the bed. Please note it may be necessary to trim the outlet of the **Elbow Assembly**, **Extension Pipe** and/or the **Flex Pipe** to place the **Stack** in the desired position. Be sure to install **Clamps** at all joints.

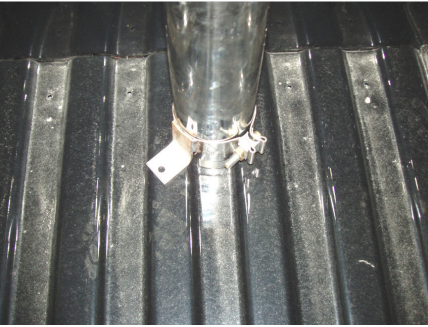

Figure 9

8. Position the **Bed Floor Clamp** to hold the **Stack** in the proper position. Drill a hole through the floor to accommodate the **3/8"** hardware supplied. Be sure to check for objects underneath before drilling. Secure the **Bed Floor Clamp** to the bed floor. Align the exhaust as required. Starting at the front of the exhaust, tighten all clamps and connections. **Refer to Figure 9.**

9. Check along the whole length of the exhaust system to ensure that there is adequate clearance around the spare tire, fuel and brake lines or any wiring. If any interference is detected relocate or adjust.



Congratulations! You are ready to begin experiencing the improved power, sound and driving experience of your MBRP Inc. "Smokers™". We are certain you will enjoy your purchase.