

**S8106409**  
**07 DODGE MEGA CAB 6.7L FILTER BACK**  
**SMOKERS<sup>™</sup>**

**MBRP**  
*INC.*  
**PERFORMANCE EXHAUST**

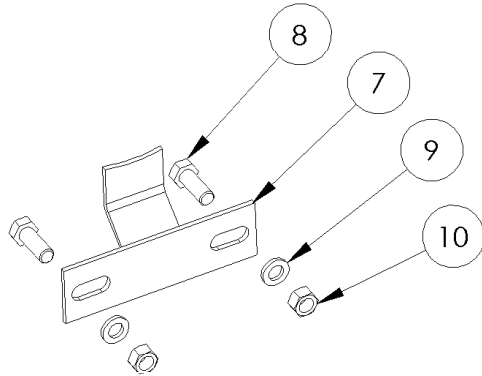

VIEW OF STACK MOUNTING BRACKETS  
2 PLACES

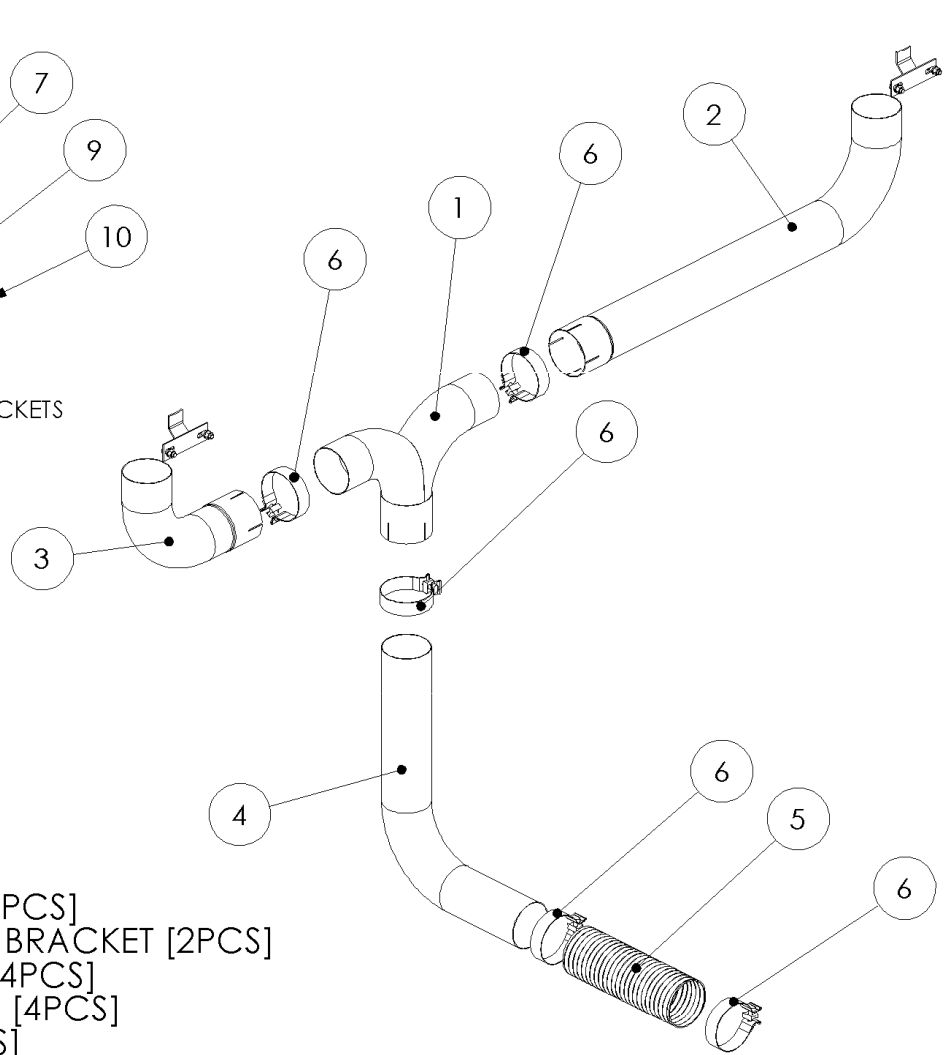

1. "T" PIPE
2. ELBOW 37" LONG
3. ELBOW 13" LONG
4. 20" ELBOW
5. FLEXPipe
6. 4" BAND CLAMP [5PCS]
7. STACK MOUNTING BRACKET [2PCS]
8. 3/8"x 1" HEX BOLT [4PCS]
9. 3/8" LOCKWASHER [4PCS]
10. 3/8" HEX NUT [4PCS]

### **PLEASE READ BEFORE STARTING INSTALATION**

**While MBRP Inc. has made every effort to ensure that all components of this system are of superior quality and properly packaged it is the installer's responsibility to ensure the following before removal of the factory exhaust:**

- that ALL components shown above are present.
- that ALL mating components fit together.
- that there are no damaged components.
- that the system you have purchased is appropriate for your vehicle year, model and configuration.
- that the system will not interfere with any modifications previously installed or planned.
- that you have read and understand these instructions.

If you have any questions or are uncertain about any aspect of the installation of this system to your vehicle please contact your dealer before commencing installation.

## Removal of Stock System



1. Apply a penetrating lubricant liberally to all exhaust fasteners, hangers and rubber insulators.
2. Loosen the factory band clamps located behind the Diesel Particulate Filter [DPF], the inlet, and outlet of the muffler.
3. Remove the muffler and tail pipe from the OEM rubber hangers. Separate the stock exhaust system at the slip joints. Remove the muffler and tail pipe from under the truck.

Figure 1

## Installation of MBRPinc. "Smokers™"



1. Loosely assemble the "T" Pipe assembly in the bed of the truck. Some models may require trimming of the "T" Pipe in order to accommodate the width of the truck bed and the stacks that have been purchased. Be sure to place the **Band Clamps** over the pieces before they are assembled. **See Figure 1.**

Figure 2

2. Place the stacks onto the **13"** and **37" Elbows** assembled to the "T" Pipe and place in the desired position in the truck bed. The **37" Elbow** should be on the driver side so that the "T" Pipe passes through the bed floor on the passenger side. **See Figure 2.**



Figure 3

3. Place the **Stack Mounting Brackets** between the stacks and the front of the truck bed so that the stacks are properly spaced from the front of the truck bed. Center the **Stack Mounting Brackets** on the stacks and mark the front of the truck bed in the center of the slotted holes in the **Stack Mounting Brackets**. Center punch the marks and drill holes to accommodate the **3/8"** hardware. **See Figure 3.**
4. Loosely attach the **Stack Mounting Brackets** to the front of the truck bed using the **3/8"** hardware supplied. Set the stacks up in the bed and loosely attach them to the **Stack Mounting Brackets**. Make sure the stacks are in the desired position and the "T" Pipe assembled with the **13"** and **37" Elbows** is level.



5. Mark the bed floor where the **"T" Pipe** is resting. MBRPinc. recommends tracing around where the **"T" Pipe** meets the bed floor. Remove the stacks, **"T" Pipe** and **Elbows** from the bed of the truck. Find the center of the circle traced onto the bed floor, mark and center punch it. Make sure that there is clearance for the **20" Elbow** to pass by any frame cross members. **See Figure 4.**

Figure 4



6. Cut a hole through the truck bed providing adequate clearance around the part of the **"T" Pipe** that passes through the truck bed. MBRP inc. recommends using a 5" diameter hole saw. It may be required to cut part of a bed floor rail away. **See Figure 5.**

Figure 5



7. Set the **"T" Pipe**, assembled with the **13" and 37" Elbows** at the desired height from the floor of the bed (This will set the height of the stacks). Using spacers to hold the **"T" Pipe** and both **13" and 37" Elbows** at the desired height, loosely attach the stacks to the **Stack Mounting Brackets** making sure that they are straight. **See Figure 6.**

Figure 6



Figure 7

8. Install the **Flexpipe** onto the outlet of the DPF. Place the **20" Elbow** in position and mark the locations to cut. Allow 3" of overlap at the **Flexpipe** and "**T**" **Pipe** connections. Cut the **20" Elbow** to the required length. Install the **20" Elbow**. Remember to slide the required **Band Clamps** onto the parts before assembly. **See Figure 7.**



Figure 8

10. Make sure the **Stack Mounting Brackets** are centered on the stacks and tighten the fasteners holding the **Stack Mounting Brackets** to the front of the truck bed. Tighten all **Clamps** to ensure your "*Smokers*<sup>TM</sup>" exhaust system remains properly aligned. **See Figure 8.**

11. Check along the whole length of the exhaust system to ensure that there is adequate clearance around fuel lines, brake lines and any wiring. If any interference is detected relocate or adjust.



Shown with 6" X 36" Stacks (B1610) and Cover (BB0002)

**Congratulations!** You are ready to begin enjoying the improved performance and driving experience of your MBRP Inc. "Smokers™". We hope you enjoy your purchase.