

# S7111

2015-UP Dodge Challenger, 3.6L V6,  
Cat-Back, 2.5" Dual Rear, Quad Tips

# MBRP®

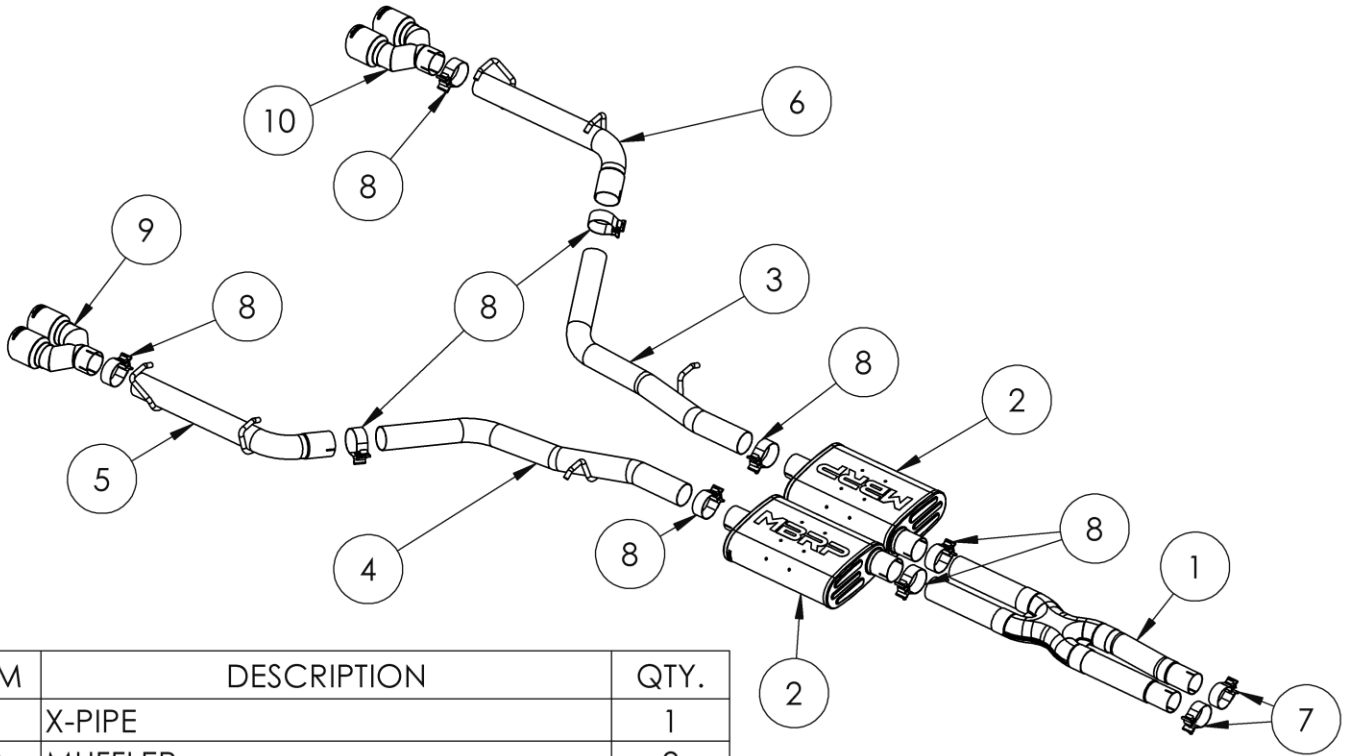

ITEM	DESCRIPTION	QTY.
1	X-PIPE	1
2	MUFFLER	2
3	DRIVER-SIDE UNDER-AXLE PIPE	1
4	PASSENGER-SIDE UNDER-AXLE PIPE	1
5	PASSENGER-SIDE TAIL PIPE	1
6	DRIVER-SIDE TAIL PIPE	1
7	2.25" CLAMP	2
8	2.5" CLAMP	8
9	PASSENGER-SIDE TIP	1
10	DRIVER-SIDE TIP	1

## PLEASE READ BEFORE STARTING INSTALLATION

**While MBRP has made every effort to ensure that all components of this system are of superior quality and properly packaged, it is the installer's responsibility to ensure the following before removal of the factory exhaust:**

- that ALL components shown above are present.
- that ALL mating components fit together.
- that there are no damaged components.
- that the system you have purchased is appropriate for your vehicle year, model and configuration.
- that the system will not interfere with any modifications previously installed or planned.
- that you have read and understand these instructions.

If you have any questions or are uncertain about any aspect of the installation of this system to your vehicle please contact your dealer before commencing installation.

# MBRP

## Removal of Stock System

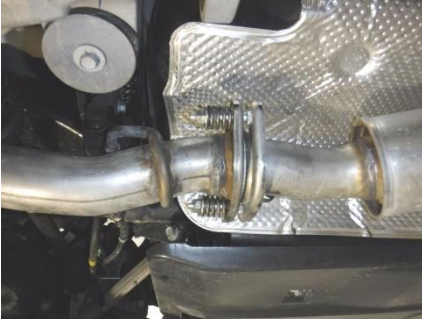

Figure 1



Figure 2



Figure 3



Figure 4

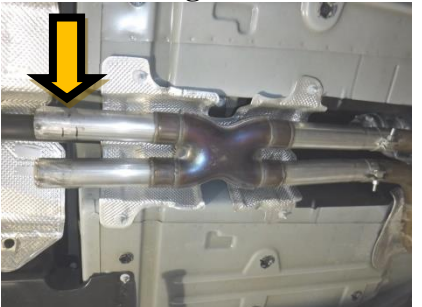

Figure 5

1. Apply penetrating lubricant liberally to all exhaust fasteners, hangers and rubber insulators.
2. Remove the two flange nuts securing the rear fascia to the trunk floor.
3. Remove the spring hardware from the driver-side muffler assembly. Refer to Figure 1.
4. Remove the two driver-side muffler hanger assemblies from the frame. Refer to Figure 2.
5. Remove the driver-side muffler assembly from the last rubber insulator and carefully remove from the vehicle. It takes some twisting and turning.
6. Remove the two passenger-side muffler hanger brackets from the frame. Refer to Figure 2.
7. Loosen the front clamps and the connecting bracket bolts at the rear of the catalytic converters. Refer to Figure 3.
8. Remove the remaining exhaust assembly from the last rubber insulator and carefully remove from the vehicle. It takes two people and some twisting and turning.
9. Remove the factory exhaust bezels from the fascia and re-install the plastic filler panels. Refer to Figure 4.

## Installation of MBRP Performance Exhaust

1. Using the **2.25" Clamps**, install the **X-Pipe**. The bent inlet pipe goes on the driver-side. Do not fully tighten until all parts are installed. Mark two lines on the **X-Pipe** outlet, one at 2" and one at 3" from the outlet. When the **Mufflers** are installed and the system aligned the inlet should be between these two lines. Refer to Figure 5.
2. Support the **X-Pipe** and install the **Mufflers**, using two **2.5" Clamps**. Place a **2.5" Clamp** on each **Muffler** outlet. Refer to Figure 6.

# MBRP



Figure 6



Figure 7



Figure 8



Figure 9



Figure 10

3. Loosely install the **Passenger-Side Under-Axle Pipe** into the factory rubber insulator and into the passenger-side **Muffler**. Place a **2.5" Clamp** on the pipe with the hardware to the front of the vehicle. Repeat for driver-side. **Refer to Figure 7.**

4. Transfer the factory muffler hanger assemblies from the factory muffler assemblies onto the corresponding locations on the **MBRP Tail Pipes**. Passenger-side with ground strap shown. **Refer to Figure 8.**

5. Place the **Tail Pipes** onto their corresponding **Under-Axle Pipes** and, using the factory hardware, re-attach the factory hanger assemblies to the frame. Driver-side shown. **Refer to Figure 9.**

6. Using **2.5" Band Clamp**, loosely install the **Driver-Side Tip** onto the **Driver-Side Under-Axle Pipe**. Repeat for the passenger-side. **Refer to Figure 10.**

7. Carefully align the system and tips. All rubber insulators should be on an angle with the lower end toward the front of the vehicle to allow the system to lower slightly as it grows with heat. Tighten all hardware and clamps, (do not forget the connecting bracket at the catalytic converters) starting at the front and working rearward to secure the system. Check along the full length of the exhaust system to ensure there is adequate clearance for fuel lines, vent lines, brake lines, frame, bodywork, suspension and any wiring, etc. If there is any interference detected, relocate or adjust to provide adequate clearance. Ensure all clamp connections are secure and components are unable to rotate or slide. Band clamps require approximately 45 lb-ft (60 N-m) of torque. Verify clearances, system security and band clamp torque after 30-60 miles (50-100 km) of driving.



**Congratulations!** You are ready to begin experiencing the improved power, sound and driving experience of your **MBRP** Performance Exhaust. We know you will enjoy your purchase!