

0210627

Solstice GXP Rear Fascia Insert Kit

MBRP
INC.

PERFORMANCE EXHAUST

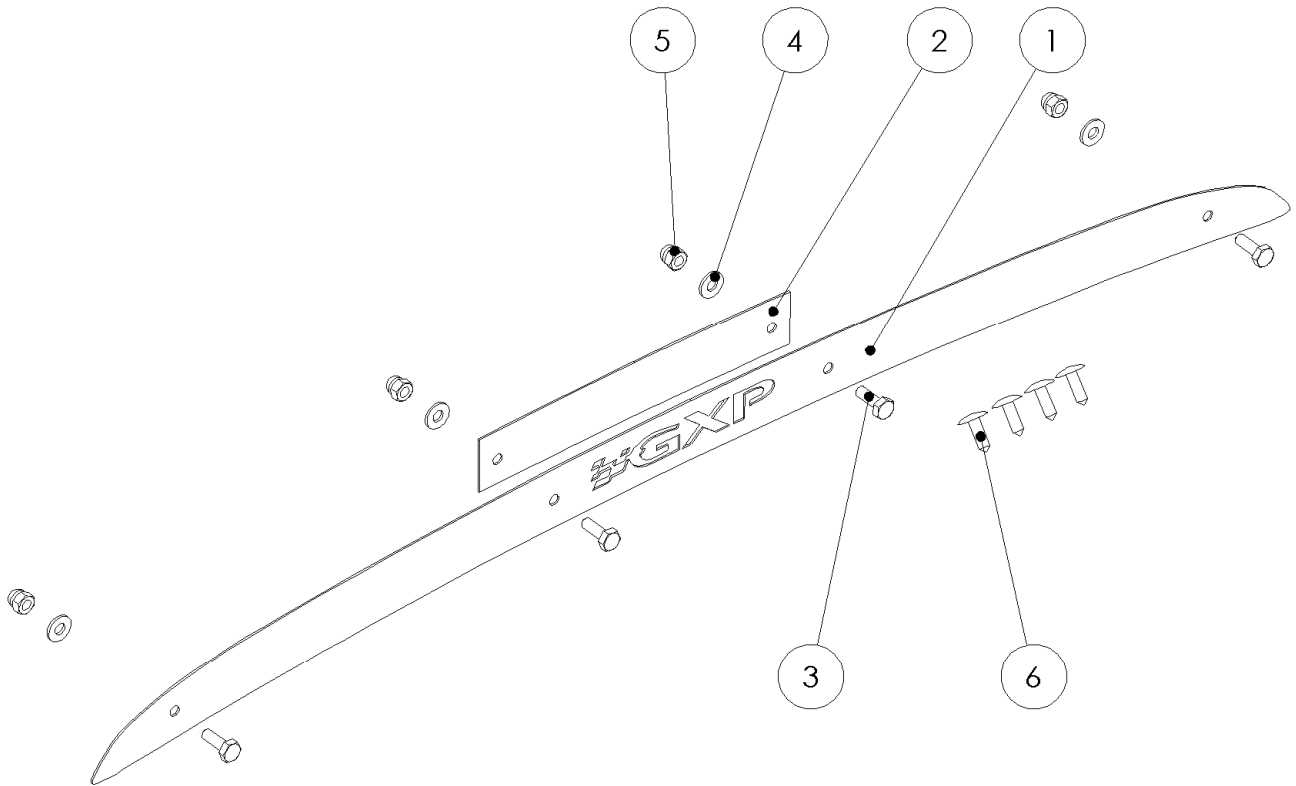

1. REAR FASCIA INSERT
2. COLOR MATCHED PANEL
3. 1/4" BOLTS [4 PCS]
4. 1/4" WASHERS [4 PCS]
5. 1/4" NUTS [4 PCS]
6. PLASTIC PUSH RIVETS

PLEASE READ BEFORE STARTING INSTALATION

While MBRP Inc. has made every effort to ensure that all components of this kit are of superior quality and properly packaged, it is the installer's responsibility to ensure the following before removal of the factory exhaust:

- that ALL components shown above are present.
- that ALL mating components fit together.
- that there are no damaged components.
- that the kit you have purchased is appropriate for your vehicle year, model and configuration.
- that you have read and understand these instructions.

If you have any questions or are uncertain about any aspect of the installation of this kit to your vehicle please contact MBRPinc. before commencing installation.

2007-2008 Pontiac Solstice GXP Rear Fascia Insert Kit



Figure 1

1. Use a Razor knife to cut the 4 factory installed plastic push rivets securing the lower edge of the rear fascia to the sheet metal support. This is required for access to the backside of the attachment hardware.

2. Place the Stainless insert into position on the rear fascia. Mark the 4 hole locations with a marker. Remove the Stainless Insert and Drill the rear fascia with a 9/32" bit. Be careful to not drill into anything behind the plastic fascia. **Refer to Figure 1.**



Figure 2

3. Install the Stainless Insert and the Color Matched Panel onto the rear fascia with the supplied hardware. Install the flat washer and nyloc nut on the backside by reaching between the rear fascia and the sheet metal support mentioned in step 1. Tighten fasteners working from the center to the outside.

Refer to Figure 2.



Figure 3

4. Using the 4 supplied Plastic Push Rivets, secure the lower edge of the Rear Fascia to the sheet metal support.

Refer to Figure 3.

