

C1348AL / C1348ALNB
C1348409 / C1348409NB
2007.5-2011 6.7L DODGE CUMMINS
4" COMPETITION EXHAUST PIPE

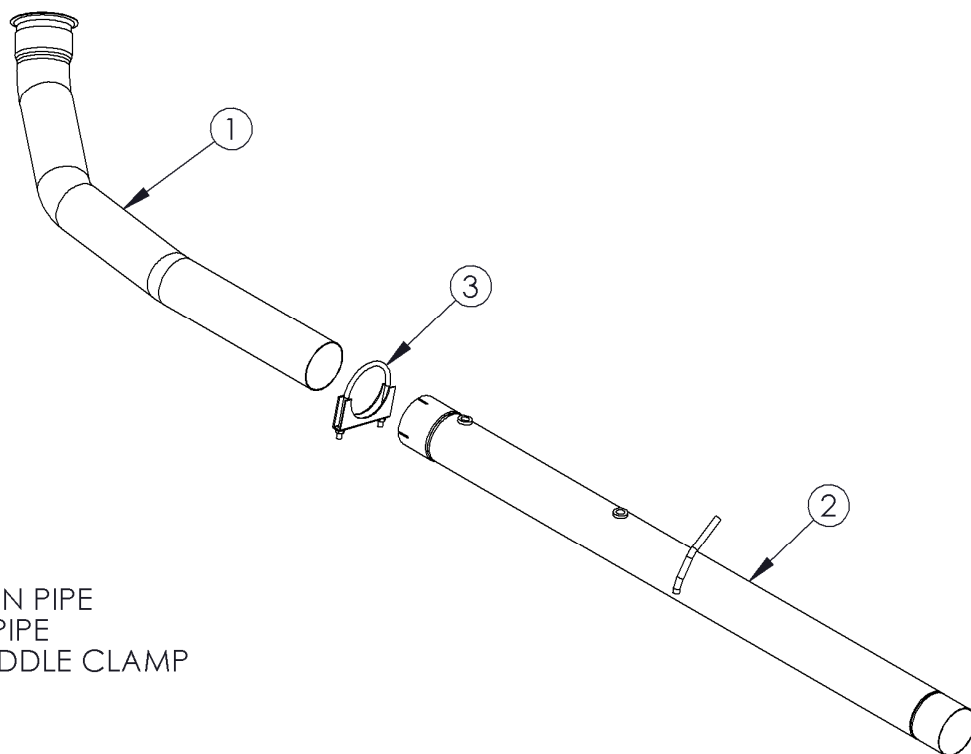

1. DOWN PIPE
2. MID PIPE
3. 4" SADDLE CLAMP

FOR RACE/COMPETITION USE ONLY!

Installation of this product for highway or recreational use vehicles is prohibited by Federal law. This product's use is restricted to organized, amateur and professional racing events, limited to closed-course racing and open-course racing that is formally sanctioned by a recognized racing organization.

This system requires an aftermarket electronic programmer to work with the vehicle.

PLEASE READ BEFORE STARTING INSTALLATION

While MBRP Inc. has made every effort to ensure that all components of this system are of superior quality and properly packaged it is the installer's responsibility to ensure the following before removal of the factory exhaust:

- that ALL components shown above are present.
- that ALL mating components fit together.
- that there are no damaged components.
- that the system you have purchased is appropriate for your vehicle year, model and configuration.
- that the system will not interfere with any modifications previously installed or planned.
- that you have read and understand these instructions.

If you have any questions or are uncertain about any aspect of the installation of this system to your vehicle please contact your dealer before commencing installation.



Removal of Stock System:

1. Apply penetrating lubricant liberally to all exhaust fasteners, hangers and rubber insulators.
2. Disconnect any exhaust sensors on the downpipe and diesel particulate filter at their connection points to the vehicle.
3. Loosen the clamp and separate the slip joint located behind the diesel particulate filter, then remove the DPF and catalytic converter by separating the slip joint located between the down pipe and the CAT/DPF section.
4. Loosen the band clamp connecting the down pipe to the turbo and remove the down pipe.
Do not discard the band clamp as it is required for the installation.

Installation of MBRP Inc. Competition Pipe:

1. Install the **Down Pipe** in the same position as the stock down pipe by attaching the flared end to the turbo using the stock band clamp. Do not fully tighten until all components are in place.
2. Install the **Mid Pipe** onto the **Down Pipe** using the **4" Saddle Clamp** provided. Do not fully tighten the clamp yet.
3. Re-install the stock tail pipe onto the end of the **Mid Pipe** using the original band clamp.
4. Align the exhaust as needed and tighten all clamps.
5. For systems C1348AL and C1348409, re-install the O2 sensors in the provided ports.

Congratulations! MBRP Competition Exhaust Systems is proud to be a part of your racing and competition success. We know you will enjoy your purchase.