

**S5116304, S5116AL
2005 DODGE DAKOTA
EC/CC-SB, 3.7/4.7L**

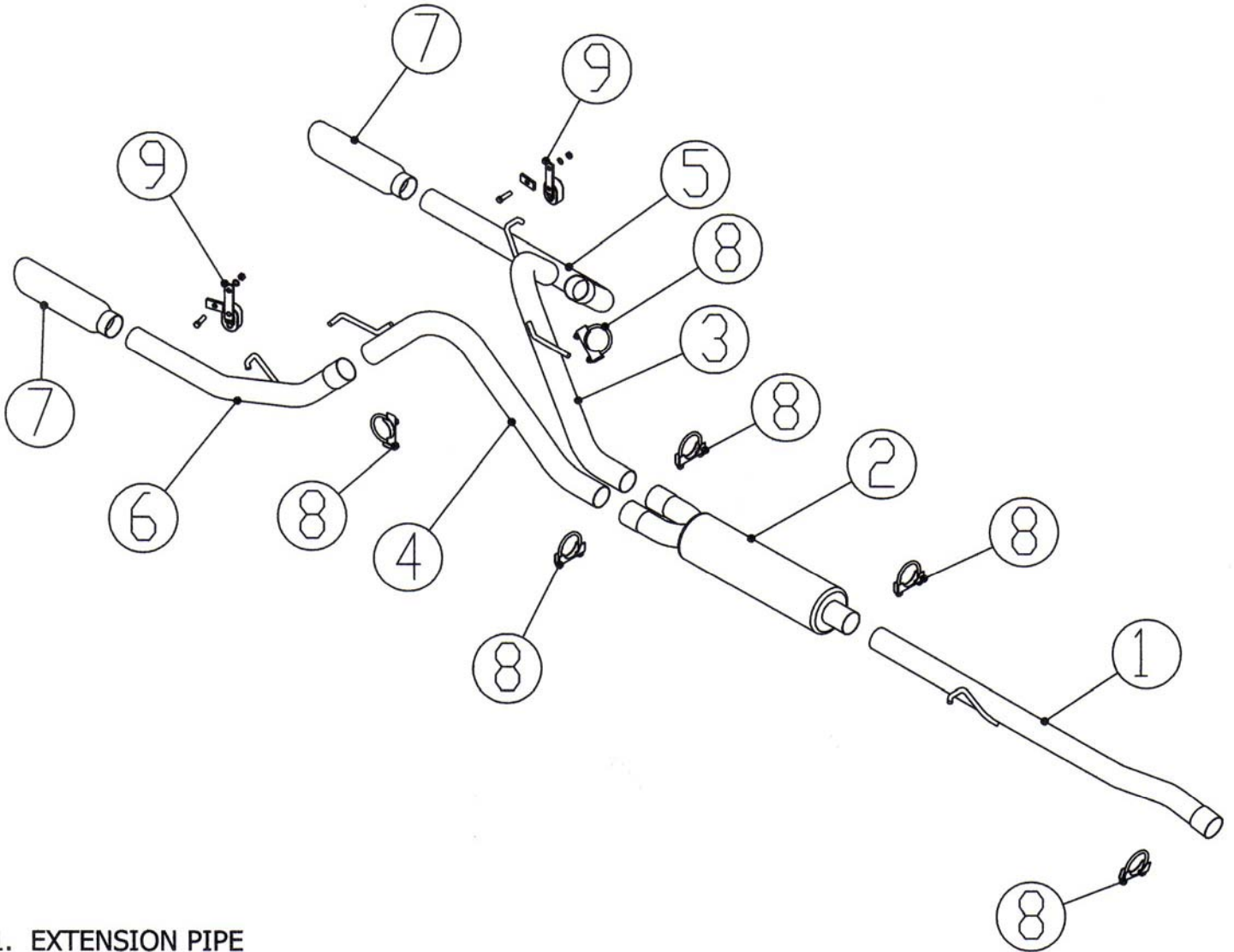

- 1. EXTENSION PIPE
- 2. HIGH FLOW MUFFLER
- 3. DRIVER SIDE OVER AXLE PIPE
- 4. PASS. SIDE OVER AXLE PIPE
- 5. DRIVER SIDE TAIL PIPE
- 6. PASS. SIDE TAIL PIPE
- 7. POLISHED TIPS (2 PCS.)
- 8. 2.5" CLAMP (6 PCS)
- 9. HANGER ASSEMBLIES (2 PCS.)



05 Dodge Dakota *"COOL DUALS"™*

These instructions cover the following systems: S5116304, S5116AL

Removal of stock system:

1. Apply a penetrating lubricant liberally to all exhaust fasteners, hangers and rubber insulators.
2. Remove the clamp located behind the muffler. Remove the tail pipe hanger from the rubber insulator and separate the tail pipe from the muffler at the slip joint. Remove the tail pipe from the vehicle.
3. Remove the clamp in front of the muffler, separate the muffler at the slip joint and remove from the vehicle.
4. Remove the clamp located behind the "Y" pipe, remove the hanger from the rubber insulator and remove the front pipe.

Installation of MBRP Inc. Performance Exhaust:

1. Install the expanded end of the extension pipe over the factory exhaust system behind the "Y" pipe and install the hanger into the factory rubber insulator.
2. Install the muffler onto the extension pipe.
3. Loosely install the driver side over axle pipe connecting it to the outlet closest to the drive shaft and placing the hanger into the factory rubber insulator.
4. Feed the passenger side over axle pipe over the axle and install it loosely to the remaining muffler outlet as well as placing the hanger into the factory rubber insulator.
5. Feed the expanded end of the driver side tail pipe from the rear of the vehicle over the axle and connect it to the driver side over axle pipe.
6. Move the driver side tail pipe into approximate position. Using the factory hole provided in the frame located directly above the tail pipe hanger, attach the hanger provided using the supplied hardware.
7. Remove the factory rubber insulator for the factory tail pipe. Now feed the expanded end of the passenger side tail pipe from the rear of the vehicle over the axle and loosely connect it to the passenger side over axle pipe.
8. Move the passenger side tail pipe into approximate position. Using the factory hole provided in the frame located directly above the tail pipe hanger, attach the hanger provided using the supplied hardware.
9. Install the mirror polished tips. It is recommended to install them at this point to assist with the final system alignment.
10. Install provided clamps to the pipe connections where required. Align the exhaust as required before tightening clamps.
11. Starting at the front of the exhaust tighten all clamps and connections.
12. Check along the whole length of the exhaust system to ensure that there is adequate clearance around the spare tire, fuel and brake lines or any wiring. If any interference is detected relocate or adjust.

Congratulations! You are ready to begin enjoying the improved performance and driving experience of your MBRP Inc. Cool Duals system. We hope you enjoy your purchase.