

S5224

1998-2011 FORD RANGER,
1998-2009 MAZDA B3000/B4000,
3.0L / 4.0L V6,
2.5" CAT-BACK, TURN DOWN

MBRP®

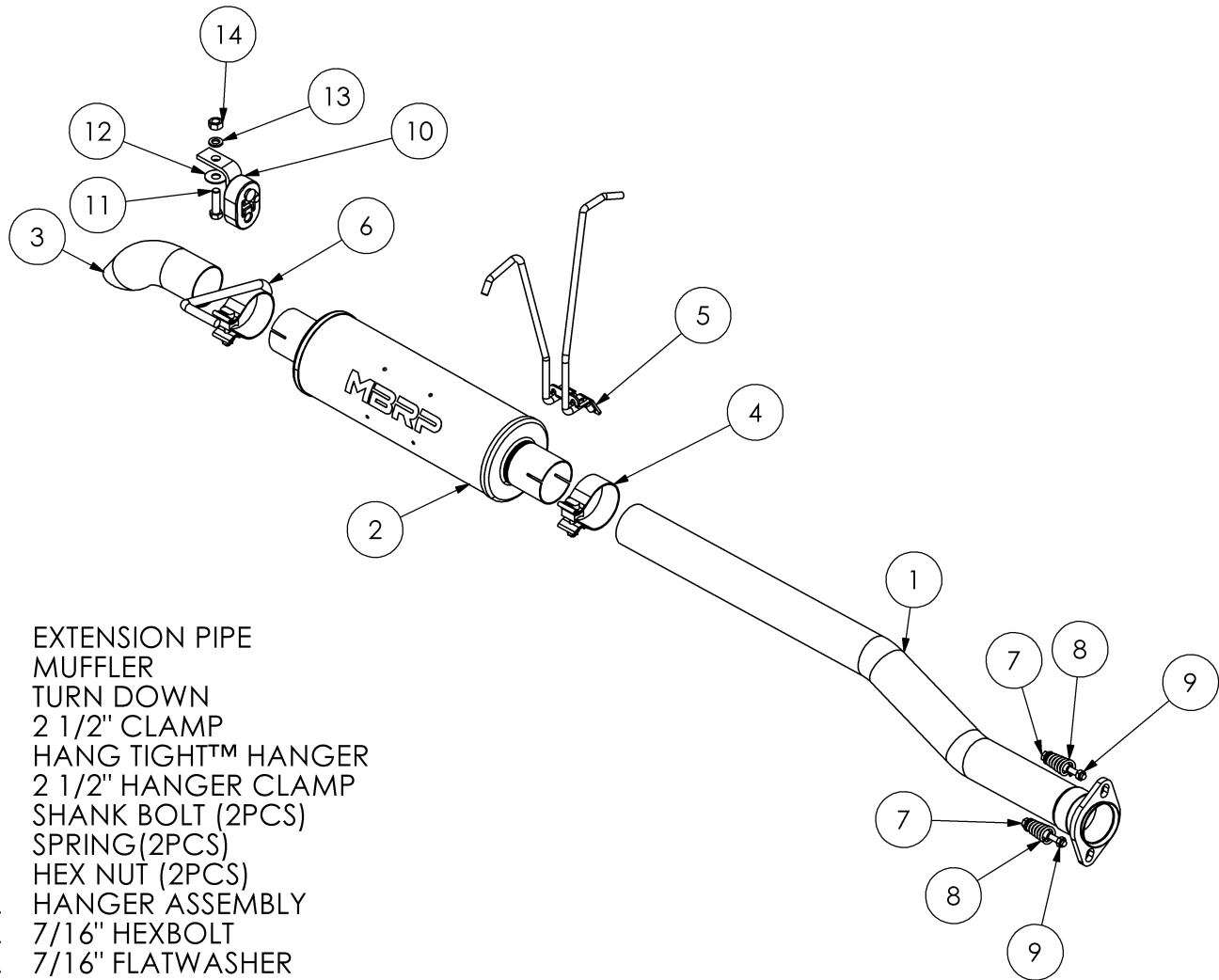

1. EXTENSION PIPE
2. MUFFLER
3. TURN DOWN
4. 2 1/2" CLAMP
5. HANG TIGHT™ HANGER
6. 2 1/2" HANGER CLAMP
7. SHANK BOLT (2PCS)
8. SPRING (2PCS)
9. HEX NUT (2PCS)
10. HANGER ASSEMBLY
11. 7/16" HEXBOLT
12. 7/16" FLATWASHER
13. 7/16" LOCK WASHER
14. 7/16" HEX NUT

PLEASE READ BEFORE STARTING INSTALLATION

While MBRP has made every effort to ensure that all components of this system are of superior quality and properly packaged, it is the installer's responsibility to ensure the following before removal of the factory exhaust:

- that ALL components shown above are present.
- that ALL mating components fit together.
- that there are no damaged components.
- that the system you have purchased is appropriate for your vehicle year, model and configuration.
- that the system will not interfere with any modifications previously installed or planned.
- that you have read and understand these instructions.

If you have any questions or are uncertain about any aspect of the installation of this system to your vehicle please contact your dealer before commencing installation.

MBRP

Removal of Stock System



Figure 1

1. Apply a penetrating lubricant liberally to all exhaust fasteners, hangers and rubber insulators.

2. Remove the bolts and springs holding the front flange together and disconnect the exhaust system. **Refer to Figure 1.**

3. Remove the hangers from the rubber insulators and remove the exhaust from the vehicle. **Refer to Figures 2 & 3.**



Figure 2

Installation of MBRP Performance Exhaust:

1. Loosely attach the **Extension Pipe** to the flange using the **Shank Bolts** and **Springs** provided. **Refer to Figure 4.**

Note: The **Extension Pipe** will need to be trimmed on some models. Refer to the illustration below.



Figure 3

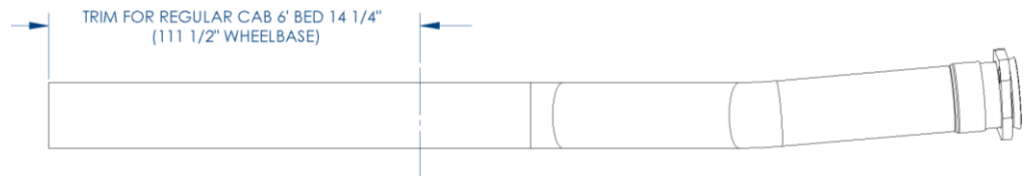
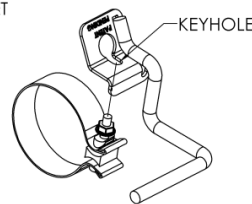
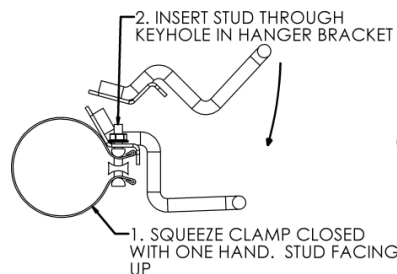
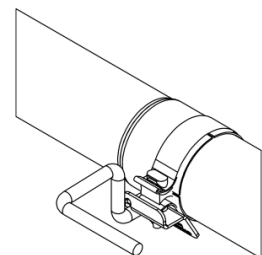

Figure 4

2. Install the **Hang Tight™ Hanger** onto a **2.5\"**



3. ROTATE HANGER BRACKET TO SEAT THREADED STUD IN SLOT. BE SURE THE NUT IS ABOVE THE BRACKET



MBRP

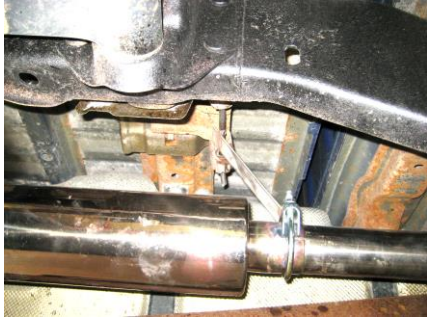

Figure 5

3. Install the **Muffler** onto the **Extension Pipe** using the **Hang Tight™ Hanger Clamp Assembly**. Then install the **Hang Tight™ Hanger** into the factory rubber insulator. Do not tighten the clamp at this time. **Refer to Figure 5.**

4. Loosely install the **Turn Down** connecting it to the **Muffler** outlet with the **2 ½” Hanger Clamp**. Install the **Hanger Assembly** to the **2 ½” Hanger Clamp** and to an existing hole in the frame using the fasteners provided. **Refer to Figures 6 & 7.**

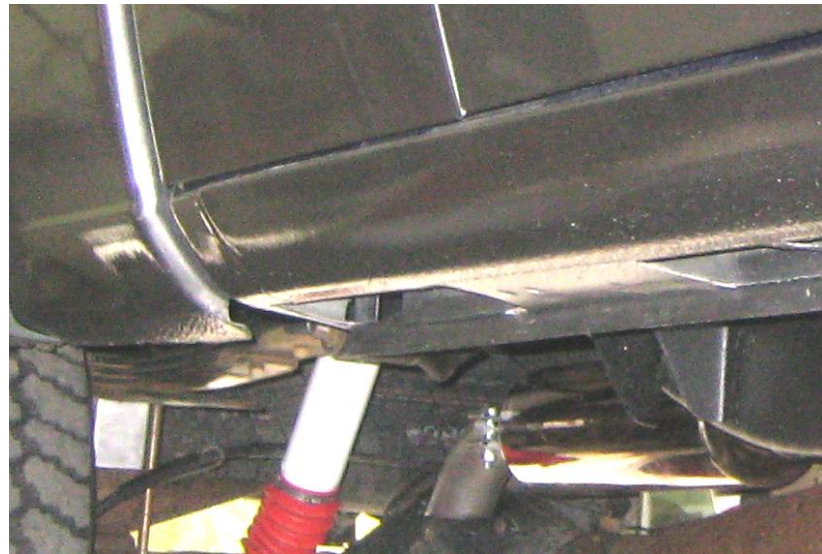

Figure 6

5. Tighten all hardware and clamps, starting at the front and working rearward to secure the system. Check along the full length of the exhaust system to ensure there is adequate clearance for fuel lines, vent lines, brake lines, frame, bodywork, suspension, and any wiring, etc. If there is any interference detected, relocate, or adjust to provide adequate clearance. Ensure all clamp connections are secure and components are unable to rotate or slide. Band clamps require approximately 45 lb-ft (60 N-m) of torque. Verify clearances, system security and band clamp torque after 30-60 miles (50-100 km) of driving.



Figure 7



Congratulations! You are ready to begin experiencing the improved power, sound and driving excitement of your **MBRP** performance exhaust system. We know you will enjoy your purchase.