

# S6242TD

08-10 FORD 6.4L, F250/F350/450,  
4" PARTICULATE FILTER BACK

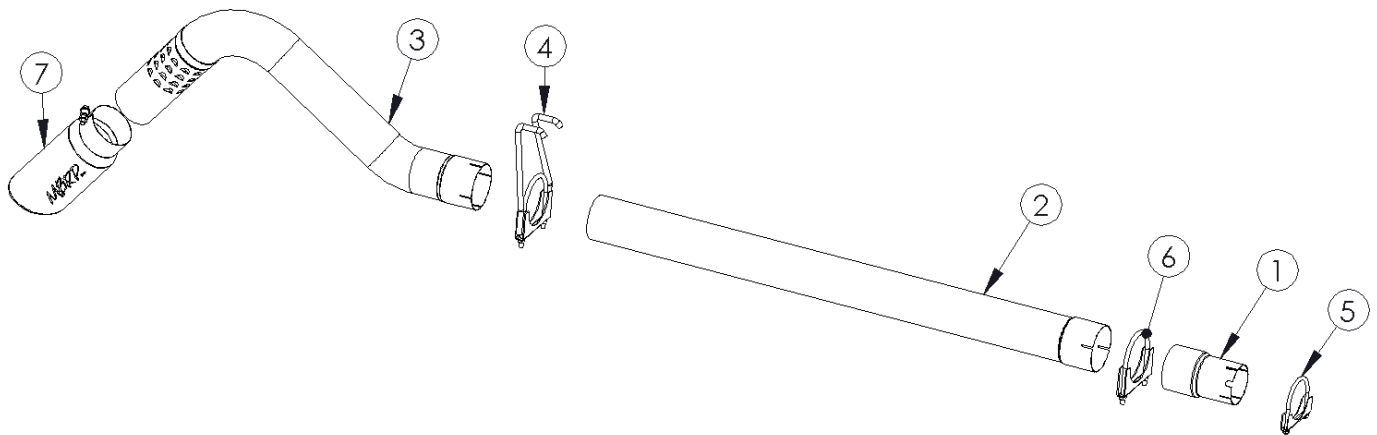

1. 3.5" TO 4" ADAPTER
2. EXTENSION PIPE
3. TAIL PIPE
4. 4" HANGER CLAMP
5. 3.5" CLAMP
6. 4" CLAMP
7. EXHAUST TIP

## PLEASE READ BEFORE STARTING INSTALLATION

While MBRP Inc. has made every effort to ensure that all components of this system are of superior quality and properly packaged it is the installer's responsibility to ensure the following before removal of the factory exhaust:

- that ALL components shown above are present.
- that ALL mating components fit together.
- that there are no damaged components.
- that the system you have purchased is appropriate for your vehicle year, model and configuration.
- that the system will not interfere with any modifications previously installed or planned.
- that you have read and understand these instructions.

If you have any questions or are uncertain about any aspect of the installation of this system to your vehicle please contact your dealer before commencing installation.



**Figure 1**

### Removal of Stock System:

1. Apply some penetrating lubricant liberally to all exhaust fasteners, hangers and rubber insulators.

2. Loosen the nut on the band clamp located behind the particulate filter using a 15mm wrench or socket.

**Refer to Figure 1.**

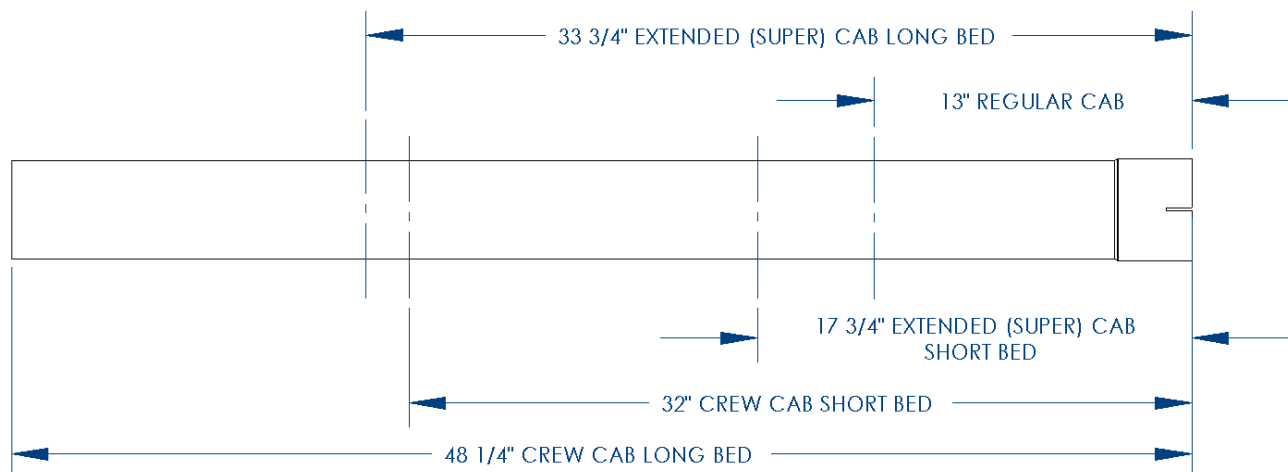

**Figure 2**

3. Cut the exhaust as shown in **Figure 2**. Remove the muffler and tail pipe from the OEM rubber insulators. Remove from the vehicle.

### Installation of MBRP Inc. Performance Exhaust:

1. The **Extension Pipe** provided is pre-cut for the crew cab long bed configuration. Cut the **Extension Pipe** to the required length for the vehicle being installed to. **Refer to Figure 3.**



**Figure 3**

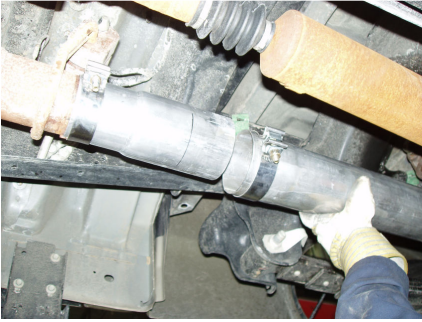

**Figure 4**

2. Slide the **3 ½” Clamp** over the **3 ½”to 4” Adapter** and install it to the particulate filter. **Refer to Figure 4.**

3. Slide the **4” Clamp** onto the end of the **3 ½”to 4” Adapter** and install the **Extension Pipe**. **Refer to Figure 4.**

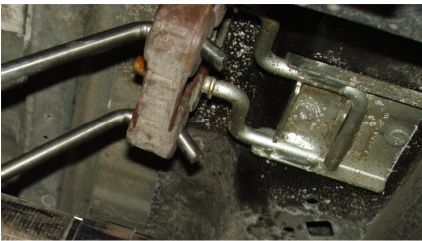

**Figure 5**

4. Install the **Tail Pipe** onto the **Extension Pipe** using the **4” Clamp Hanger**. Install the hangers into existing rubber insulators. **Refer to Figure 5.**

5. Install the **Exhaust Tip** using a 17mm wrench. Align the exhaust as required. Starting at the front of the exhaust, tighten all clamps and connections. **Refer to Figure 6.**



**Figure 6**

6. Check along the whole length of the exhaust system to ensure that there is adequate clearance around the spare tire, fuel and brake lines or any wiring. If any interference is detected relocate or adjust.

**Congratulations!** You are ready to begin experiencing the improved performance and driving pleasure of your MBRP Inc. performance exhaust system. We know you will enjoy your purchase.