

S7228304

2007-12 MUSTANG GT500 HEADER KIT

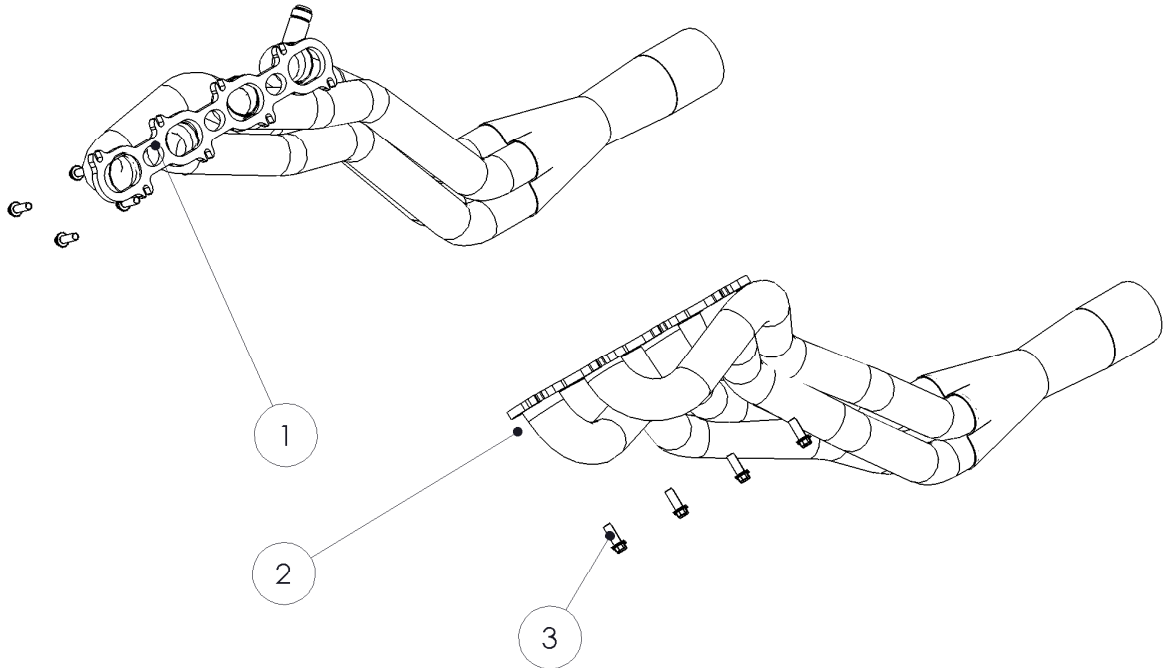

1. DRIVER SIDE HEADER
2. PASSENGER SIDE HEADER
3. M8 FLANGE HEAD BOLT [16 PCS]

PLEASE READ BEFORE STARTING INSTALLATION

While MBRP Inc. has made every effort to ensure that all components of this system are of superior quality and properly packaged, it is the installer's responsibility to ensure the following before removal of the factory exhaust:

- that ALL components shown above are present.
- that ALL mating components fit together.
- that there are no damaged components.
- that the system you have purchased is appropriate for your vehicle year, model and configuration.
- that the system will not interfere with any modifications previously installed or planned.
- that you have read and understand these instructions.

If you have any questions or are uncertain about any aspect of the installation of this system to your vehicle please contact your dealer before commencing installation.



Figure 1



Figure 2



Figure 3



Figure 4

2011 Mustang GT500 Header Kit

Note: this is an advanced level installation that should be performed only by experienced personnel.

This kit is designed to work with MBRP C7232 Off Road H-Pipe or S7234 Catted H-Pipe, and either a S7208 Street or S7216 Race Cat Back exhaust system.

Removal of Stock System:

1. Disconnect and remove the Battery, and Battery Box.
Refer to Figure 1.

2. Disconnect the EGR tube from the Passenger Side Manifold.. Remove the driver and passenger side Engine Mount Nuts.
Refer to Figure 2.

3. Remove the Airbox/Filter assembly.
Refer to Figure 3.

4. Remove as many of the M8 Flange Nuts holding the Manifolds to the Cylinder Heads on both the driver and passenger side as possible from the topside.

5. Remove the Lower Chassis Brace and the Passenger Side O2 Sensor.
Refer to Figure 4.

6. Disconnect the OEM H-Pipe assembly from the Exhaust Manifolds and remove.



Figure 6



Figure 7



Figure 8



Figure 9



Figure 10

7. Remove the Pinch Bolt from the Steering Shaft and lift the shaft assembly off the Steering Rack. Swing the shaft out of the way.

Refer to Figure 6.

8. Disconnect the Driver Side O2 Sensor lead from the vehicle wiring harness.

9. Disconnect the wiring and remove the Starter Motor. Remove the Oil Filter.

10. Remove the remaining M8 Flange Nuts securing the Exhaust Manifolds to the Cylinder Heads from below.

Refer to Figure 7.

11. Remove the Oil Dipstick Retaining Bolt and Remove the assembly. Remove both Exhaust Manifolds and the remaining M8 Studs in the Cylinder Heads. Keep the Exhaust Gaskets, these will be reused.

Refer to Figures 8, 9, and 10.

12. Use a block of wood under the Oil Pan and CAREFULLY lift the engine up off the Rubber Engine Mounts just enough to be able to remove the Driver Side Engine Mount from the Engine Block.



Installation of MBRP Inc. Header Kit



Figure 11

Reference the torque specs at the bottom of this page during assembly.



Figure 12

1. Install the OEM Manifold Gaskets onto the Cylinder Head with 4 of the supplied **M8 Flange Head Bolts** in the **BOTTOM ROW ONLY** on both sides.

2. O2 Extension Harnesses may be required for installation. You may be able to open the harness and pull more slack in the OEM O2 wiring. **MBRPinc** can provide Extension Harnesses if required.

0262049	07-10 Front/Rear O2 Sensor Extension 12"
0261675	11-12 Front O2 Sensor Extension 12"
0261676	11-12 Rear O2 Sensor Extension 12"



Figure 13

These connectors are very hard to access once the Headers are installed.

Refer to Figure 11.

3. Install the **MBRP Headers** into position and lower them down onto the bolts previously installed in the Cylinder Heads. The Header Flange is slotted to allow this. Be careful not to damage the Gaskets while installing the headers. Install the Dipstick assembly while the

Driver Side Header is loose. Secure it with the bolt removed in Step 11.

Refer to Figures 12 and 13.

4. Install the remaining **M8 Flange Head Bolts** and tighten to 25 lb-ft. A 10mm ratchet wrench will be extremely helpful with this step.

5. Reinstall the Driver Side Engine Mount and torque to specification. Lower the engine onto the mounts, reinstall the Engine Mount Nuts and torque to specification.

6. Remove the OEM O2 Sensors from the Driver Side Manifold/Passenger side H-Pipe and transfer them to the **MBRP headers**. Connect the O2 Sensors to the **O2 Extension Harnesses**. Use wire ties to secure the wiring away from the exhaust.

7. Reinstall the Starter and Oil Filter.

8. Reinstall the Steering Shaft, and Lower Chassis Brace. Torque to specification.

9. Reinstall the Air Intake, Airbox Assembly, EGR Tube, Battery box, and Battery.

Torque Specifications.

Driver Side Engine Mount to Block	41 lb-ft
Engine Mount Nut	46 lb-ft
Steering Shaft Pinch Bolt	35 lb-ft
Lower Chassis Brace	48 lb-ft

Congratulations! You are ready to begin experiencing the improved power, sound and driving excitement of your MBRP Inc. performance headers. We know you will enjoy your purchase.